



EXCLUSIVE LISTING

MEDICAL/OFFICE BUILDING FOR LEASE

813 EAST GATE DRIVE MOUNT LAUREL, NJ



Property Description: One-Story Multi Tenant Medical Office Building For Lease in Mount Laurel, NJ

Building Size: 21,000 +/- SF

Available: 2,000 - 10,300 +/- SF

Land Size: 2.33 +/- acres

Lease Rate: \$18.00/ SF Plus Utilities

- Comments:**
- New Ownership and Management
 - Pylon Signage on Fellowship Road
 - Major Improvements Coming
 - At Signalized Intersection
 - High Exposure Building
 - Perfect for all Professional Uses
 - Excellent Parking
 - Minutes to Route 73, I-295, and the New Jersey Turnpike

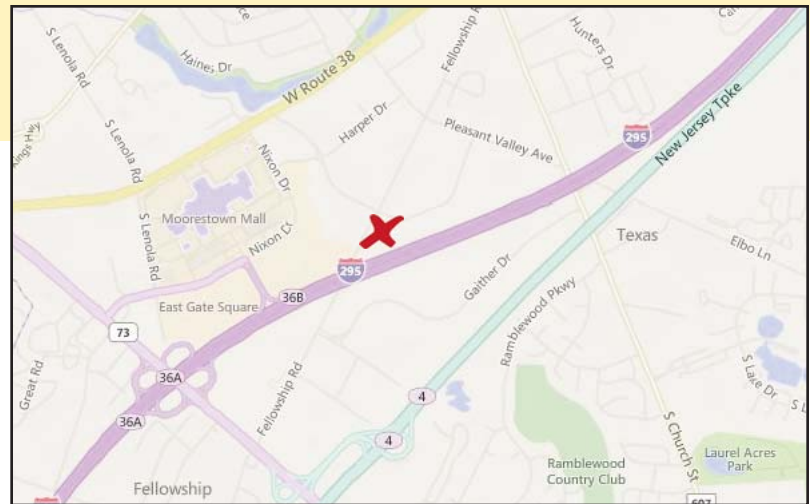

For Further Information, Please Contact:

Adam Rose (Ext. 22)

(856) 985-9522

arose@rosecommercial.com

Jeffrey Lucas

(609) 254-1832

jeffreylucas@me.com

ALL INFORMATION FURNISHED REGARDING PROPERTY FOR SALE, RENTAL OR FINANCING IS FROM SOURCES DEEMED RELIABLE, BUT NO WARRANTY OR REPRESENTATION IS MADE AS TO THE ACCURACY THEREOF AND SAME IS SUBMITTED SUBJECT TO ERRORS, OMISSIONS, CHANGE OF PRICE, RENTAL OR OTHER CONDITIONS, PRIOR SALE, LEASE OR FINANCING OR WITHDRAWAL WITHOUT NOTICE. NO LIABILITY OF ANY KIND IS TO BE IMPOSED ON THE BROKER HEREIN.

651 Route 73 North, Suite 111 • Marlton, NJ 08053 • Phone: (856) 985-9522 • Fax: (856) 985-9488

www.rosecommercial.com

MEDICAL/OFFICE BUILDING FOR LEASE

ROSE

COMMERCIAL REAL ESTATE

813 EAST GATE DRIVE MOUNT LAUREL, NJ

EXCLUSIVE LISTING

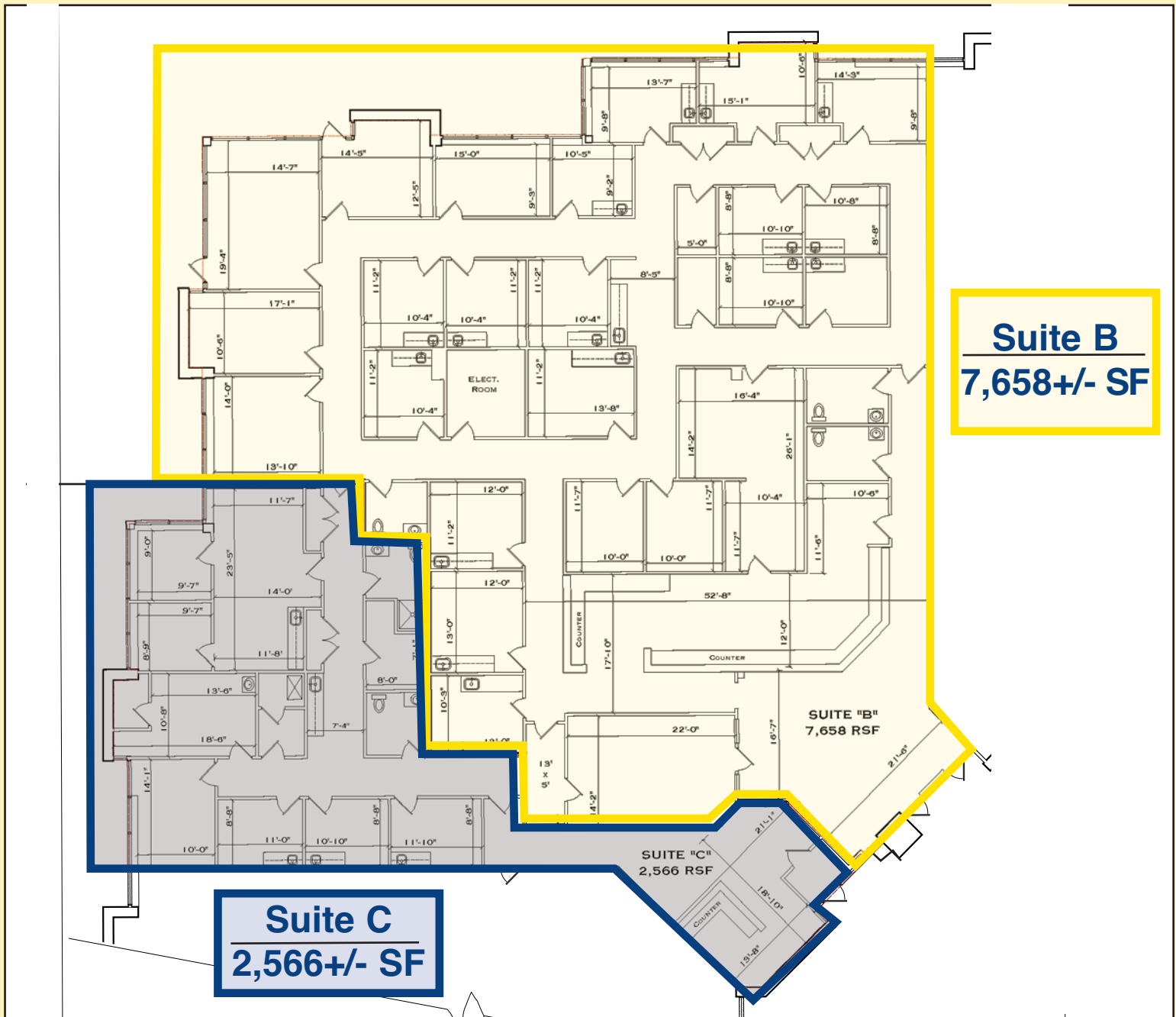

ALL INFORMATION FURNISHED REGARDING PROPERTY FOR SALE, RENTAL OR FINANCING IS FROM SOURCES DEEMED RELIABLE, BUT NO WARRANTY OR REPRESENTATION IS MADE AS TO THE ACCURACY THEREOF AND SAME IS SUBMITTED SUBJECT TO ERRORS, OMISSIONS, CHANGE OF PRICE, RENTAL OR OTHER CONDITIONS, PRIOR SALE, LEASE OR FINANCING OR WITHDRAWAL WITHOUT NOTICE. NO LIABILITY OF ANY KIND IS TO BE IMPOSED ON THE BROKER HEREIN.

651 Route 73 North, Suite 111 • Marlton, NJ 08053 • Phone: (856) 985-9522 • Fax: (856) 985-9488

www.rosecommercial.com