



# FORMER DANFOSS FACILITY

330,000 SF on 41 ACRES  
(facility can be subdivided)

Available for Sale or Lease  
1 Scroll Drive – Arkadelphia, AR

- **100% Fully Air Conditioned**, modern single-story industrial facility
- Ceiling heights up to 32'7" clear to the joists throughout
- Heavy power available
- Rail service possible
- Ideally located in the Clark County Industrial Park on Highway 67 and minutes to Interstate 30

 [View Video](#)

# Highlights

**300,000 SF**

Warehouse Square Feet

**1 (15ton)**

Bridge Cranes

**41 Acres**

Acreage

**100% AC**

HVAC

**24' - 32'7"**

Ceiling Height

**9 Dock High**

Loading Docks



## Floor Plan

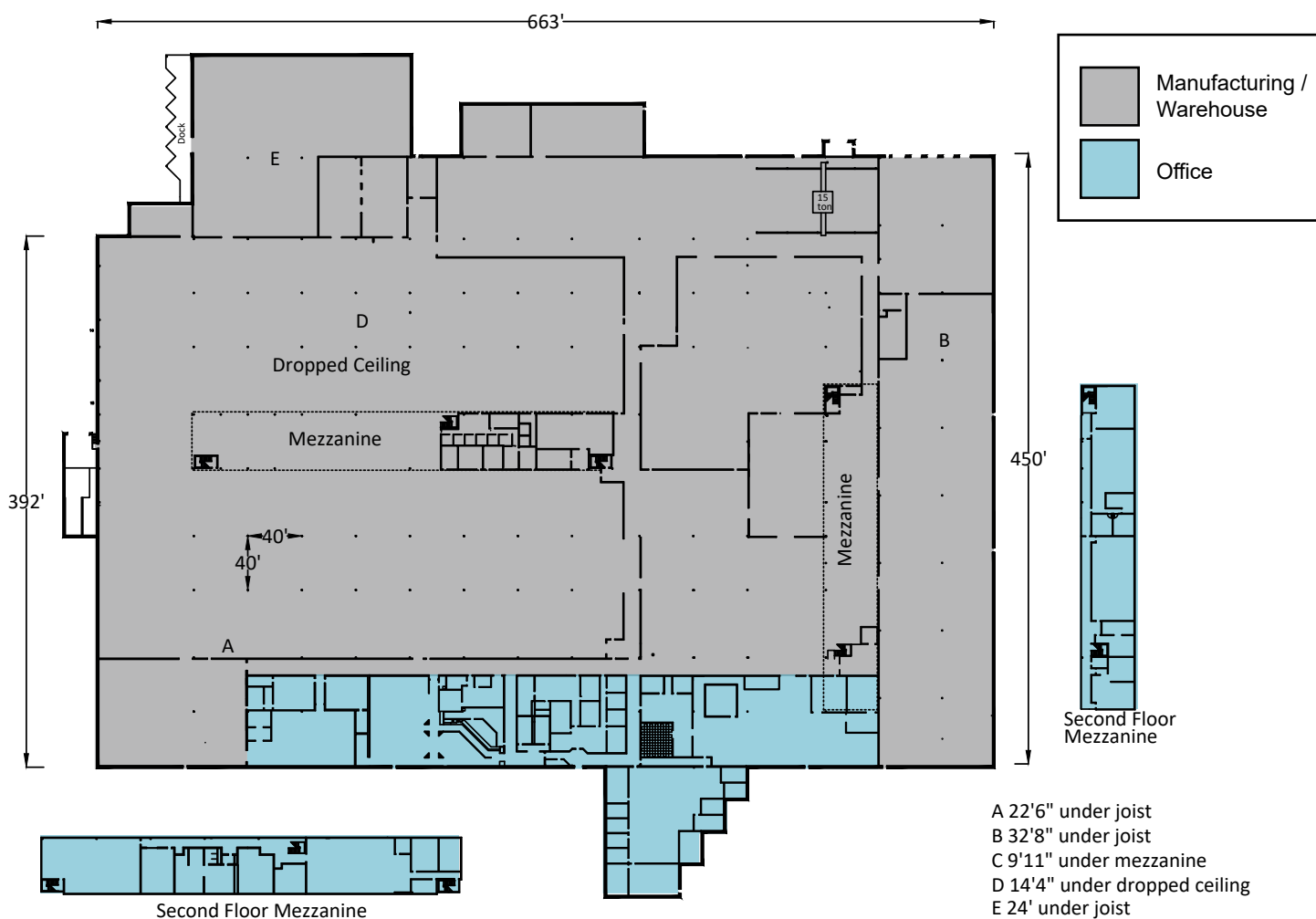





## Warehouse

### HVAC:

Facility is 100% air conditioned via two (2) 550-ton and one (1) 500-ton Carrier Chillers / Marley cooling tower was replaced within the last twelve (12) months; one Cleaver Brooks boiler and one Kewanee boiler

### SPRINKLER:

100% sprinklered via Wet System

### TRUCK LOADING:

Total of nine (9) dock high loading doors, with levelers, seals and dock locks; East side - two (2) – 8'x10'; three (3) – 8'x 8' ; and one (1) 12'x 14' grade level drive in door; North side – four (4) 8' x 10'; 1 – 12' x 14' grade level doors; Northeast corner has covered exterior dock with seven (7) trailer positions

### AIR COMPRESSORS:

Two (2) 315 hp Atlas Copco compressors

### CRANES:

One (1) – 15-ton Bridge crane

### ZONING:

Heavy Industrial

Facility is **100%**  
**Air Conditioned**

### Dock Doors



### Crane





## Interior

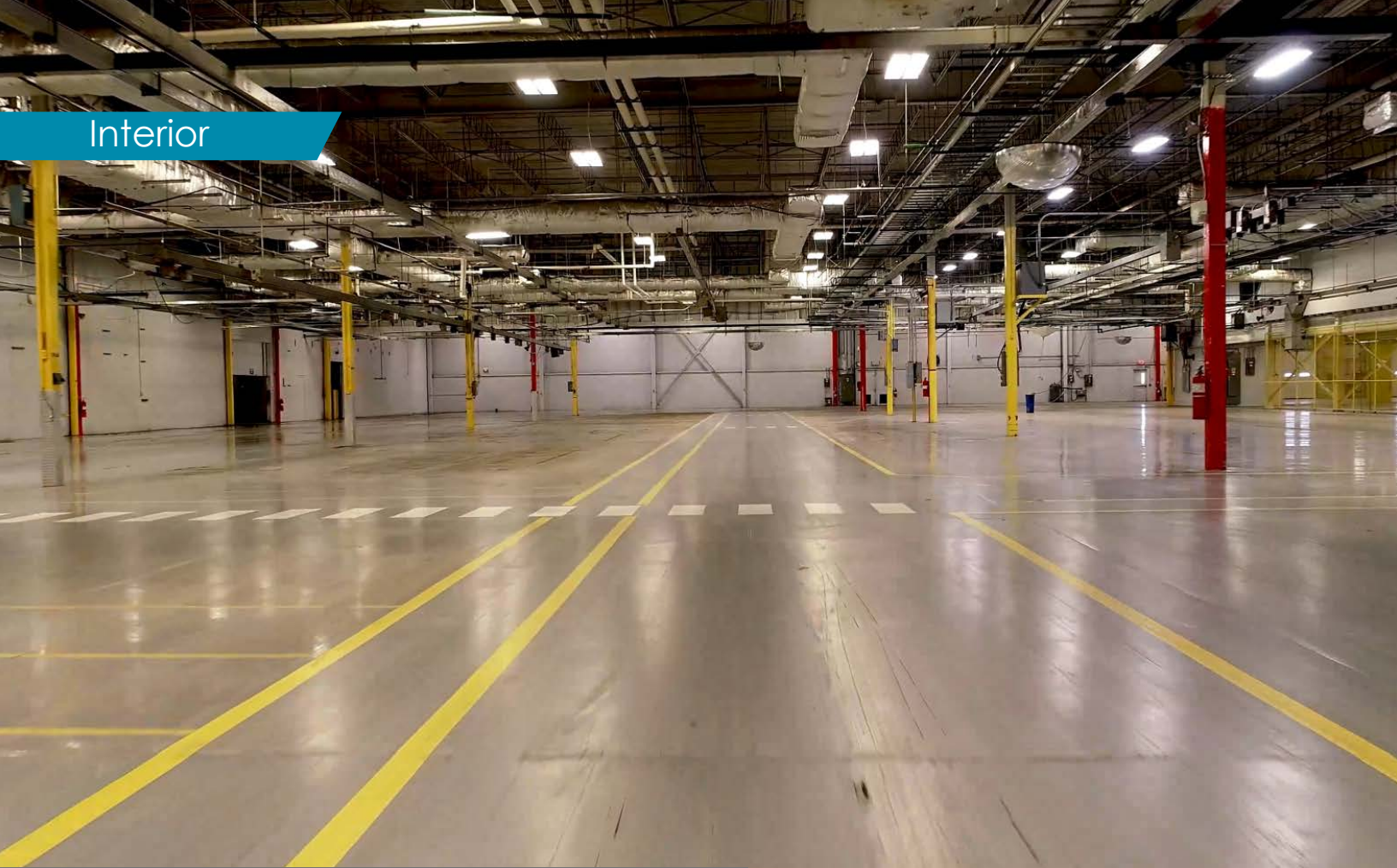

### Infrastructure

#### FLOORS:

6" reinforced concrete (some 12")

#### WALLS:

Tilt wall concrete panel to 7' with insulated metal sandwich panel to the roof deck

#### ROOF:

Built up metal deck with TPO surface

#### COLUMN SPACING:

High Bay 37' x 50' and 46' x 50' rest of the space varies from 39'x50', 40'x60' and 40'x40'

#### CEILING HEIGHTS:

Majority of the space is 24' clear to the joists throughout; High Bay (38,400 sf) 32'7" to the joist; 22'6" in some sections of the manufacturing area and 14'4" under drop ceiling

#### RAIL:

Union Pacific rail serves the industrial park and a rail spur is possible

### Utilities

#### LIGHTING:

Combination of T-5 fluorescent lighting and LED lighting in the high bay area

#### WATER:

Supplied by City of Arkadelphia; main -12" and building line - 6"-8"

#### SEWER:

Supplied by City of Arkadelphia; main -12" and building line - 6"-8"

#### GAS:

Supplied by CenterPoint Energy

#### POWER:

Supplied by South Central Electric Cooperative; main power feed is on the mezzanine level four (4) 3,000 KVA transformers (24,960 volt); distribution panels are 480/277 volt; 4,000 amps throughout



## Aerials

### Location:

- Ideally located in the Clark County Industrial Park
- On Highway 67 and minutes to Interstate 30
- 75 miles from Hillary and Bill Clinton National Airport and Interstate 40

### Distance to Major Cities

Memphis, TN  
209 miles

Dallas/ Fort Worth  
250 miles

Port of Houston  
370 miles

Little Rock, AR  
75 miles





## Cafeteria



## Boiler



## Air Compressor



## Amenities:

### OFFICE:

Approximately 30,000 sf of fully air-conditioned office space featuring conference rooms, private offices, break room, acoustical tile ceiling and fluorescent lighting

### PARKING:

Paved and lighted parking for up to approximately 500 cars

### RESTROOMS:

Men's and Women's restrooms located throughout the manufacturing and office area

### MISCELLANEOUS:

- \* 2 battery charging stations throughout
- \* Guard shack
- \* Mezzanine office throughout the manufacturing areas
- \* Cafeteria

### SECURITY:

Facility has interior / exterior cameras throughout

[View Video](#)

## Contact:



**J. Holmes Davis IV**  
Senior Vice President & Partner

hdavis@binswanger.com  
214.763.3700

The information contained herein is from sources deemed reliable, but no warranty or representation is made as to the accuracy thereof and no liability may be imposed. RMA 10/20

 **BINSWANGER**  
binswanger.com