

FOR LEASE

±27,361 SF DEAD STORAGE SPACE
311 BONNIE CIRCLE, CORONA, CA 92880



LISTING DATA

AVAILABLE SF: ±27,361 SF Dead Storage

- Premier West Corona Location with Easy Freeway Access
- Complete Building Rehab to Interior & Exterior
- 2 - 9x10 Dock High Doors with Levelers
- 24' Clear Height
- 0.45/3,000 SF GPM Calculated Sprinkler System
- Warehouse Lighting & Skylights
- 3000 AMP 277/480 Volt Power
- Flexible M1 Zoning
- Short-Term Leases Ok

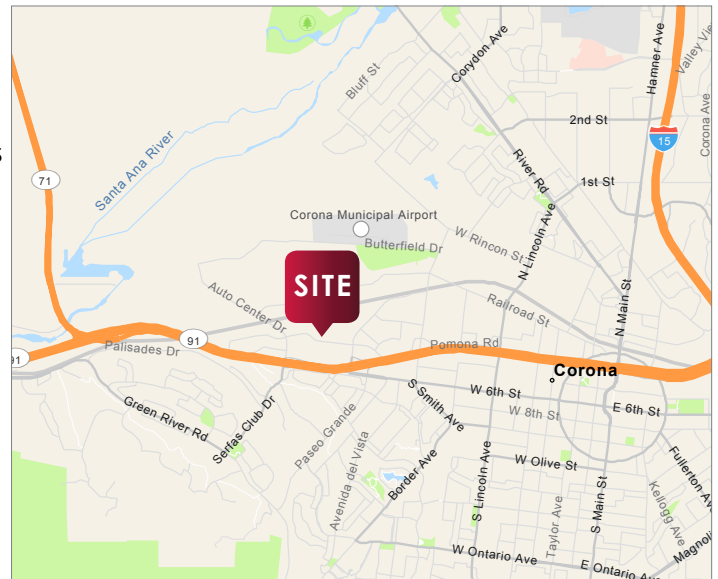

Jeff Ruscigno, SIOR
jruscigno@lee-associates.com
D 951.276.3630
DRE #01030286



Louis Tomaselli
louis.tomaselli@am.jll.com
D 949.885.2985
DRE #01030286



Zach Niles
zach.niles@am.jll.com
D 949.885.2922
DRE #01030286

Owned and Managed By



ASSOCIATES EQUITY FUNDS

All information furnished regarding property for sale, rental or financing is from sources deemed reliable, but no warranty or representation is made to the accuracy thereof and same is submitted to errors, omissions, change of price, rental or other conditions prior to sale, lease or financing or withdrawal without notice. No liability of any kind is to be imposed on the broker herein.

FOR LEASE

±27,361 SF DEAD STORAGE SPACE
311 BONNIE CIRCLE, CORONA, CA 92880

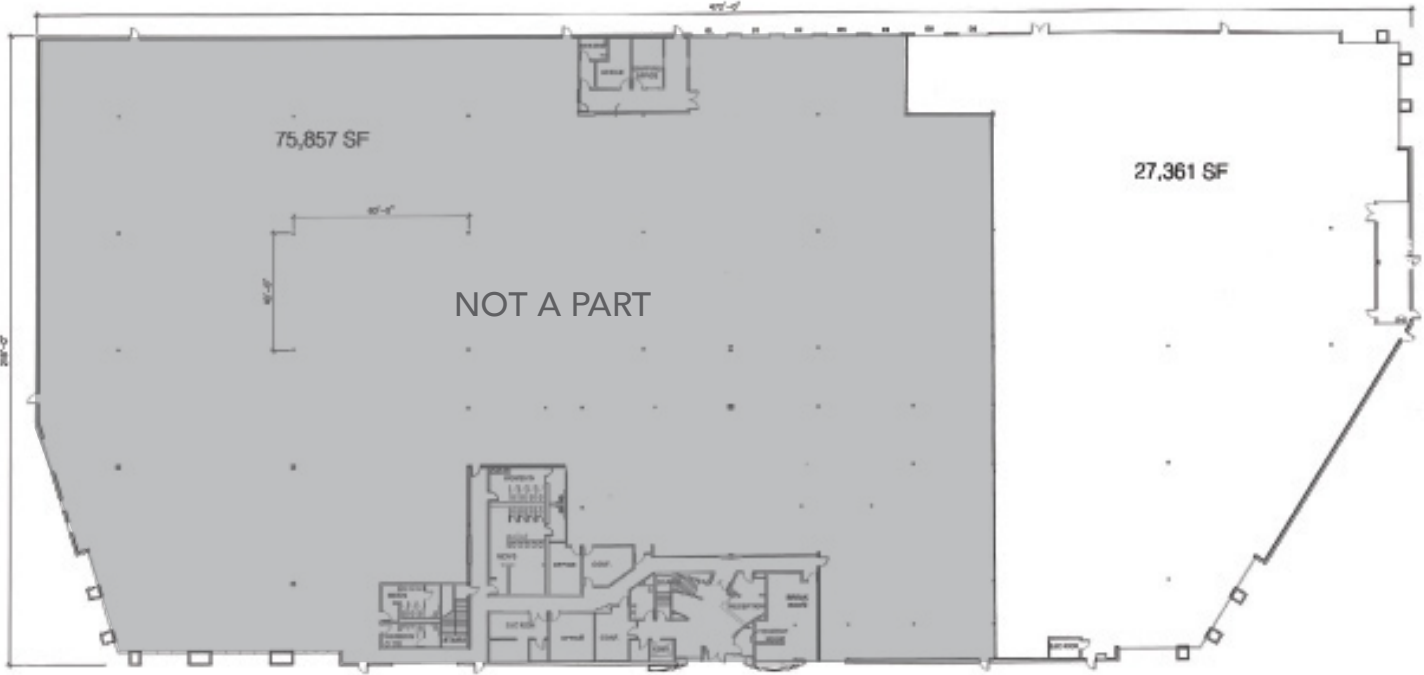

Jeff Ruscigno, SIOR
jruscigno@lee-associates.com
D 951.276.3630
DRE #01030286



Louis Tomaselli
louis.tomaselli@am.jll.com
D 949.885.2985
DRE #00904844



Zach Niles
zach.niles@am.jll.com
D 949.885.2922
DRE #01311756

Owned and Managed By



ASSOCIATES EQUITY FUNDS

All information furnished regarding property for sale, rental or financing is from sources deemed reliable, but no warranty or representation is made to the accuracy thereof and same is submitted to errors, omissions, change of price, rental or other conditions prior to sale, lease or financing or withdrawal without notice. No liability of any kind is to be imposed on the broker herein.