

3621-3651 NORTH WESTERN AVENUE

roscoe village / chicago, il



MID-AMERICA® URBAN

AVAILABLE NOW



- KRISER'S NATURAL PET
- LONG'S HOT OLIVES
- tropical CAFE SMOOTHIE
- ATI PHYSICAL THERAPY
- myeyeDR.

FedEx Office Print & Ship Center

DUNKIN'

POPEYES

SUBWAY

Wendy's



MATTRESS FIRM



Waveland Bowl

AutoZone



Bell Elementary School

Lane Technical High School
4,000 Students

Walgreens

MARIANO'S Fresh Market

Jewel Osco

COSTCO WHOLESALE

TARGET

3621-3651 NORTH WESTERN AVENUE

roscoe village / chicago, il

SPACE DETAILS

ADDRESS

3621-3651 North Western Avenue
Chicago, IL 60618

AVAILABILITY

Endcap Availability – 5,971 SF (Divisible)

DEMOGRAPHICS

	.5M	1M	1.5M
AVG HOUSEHOLD INCOME –	\$155,051	\$129,654	\$120,126
POPULATION –	9,099	50,843	126,265
DAYTIME POPULATION –	8,658	38,998	90,803

CO-TENANTS

Starbucks, Potbelly Sandwich Works, Mattress Firm, Wendy's, Jewel-Osco, Mariano's, Popeyes

FEATURES

Multi-tenant retail development located on heavily traveled Western Avenue north of Addison Street

Join Kriser's Natural Pet, ATI Physical Therapy, MyEyeDr, and Dave's Hot Chicken

Excellent visibility, daytime and evening traffic drivers

Rarely available surface parking opportunity in City of Chicago

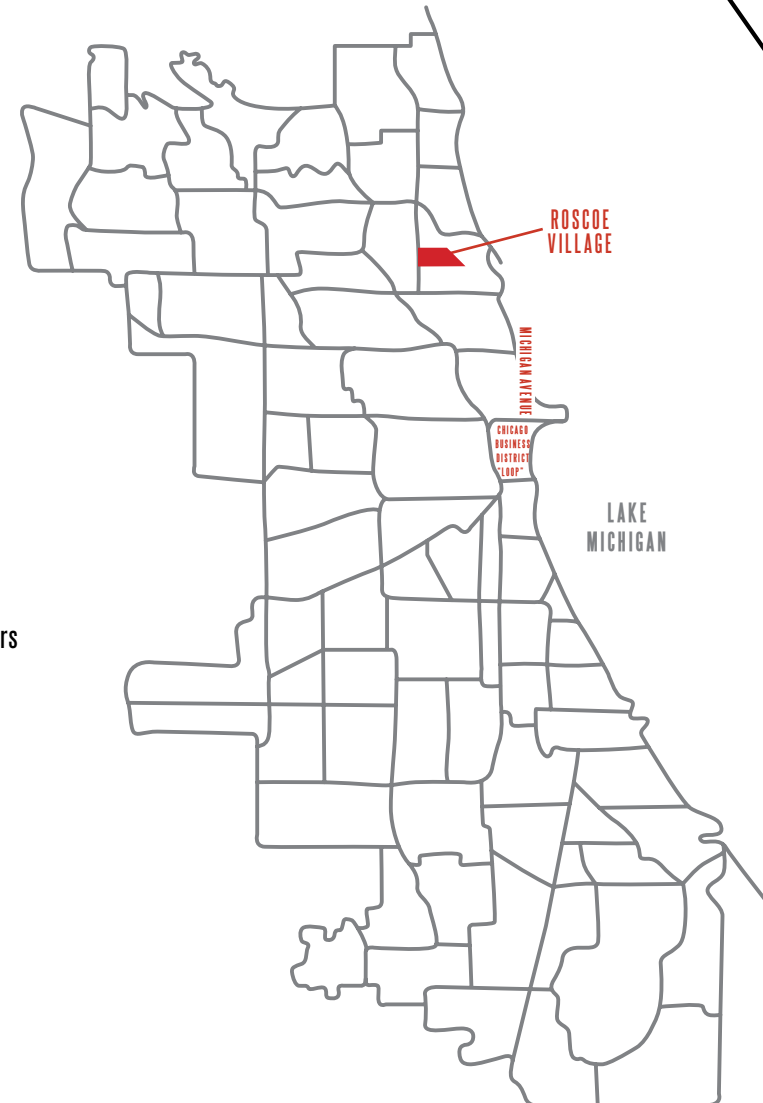

3621-3651 NORTH WESTERN AVENUE

roscoe village / chicago, il

SITE PLAN

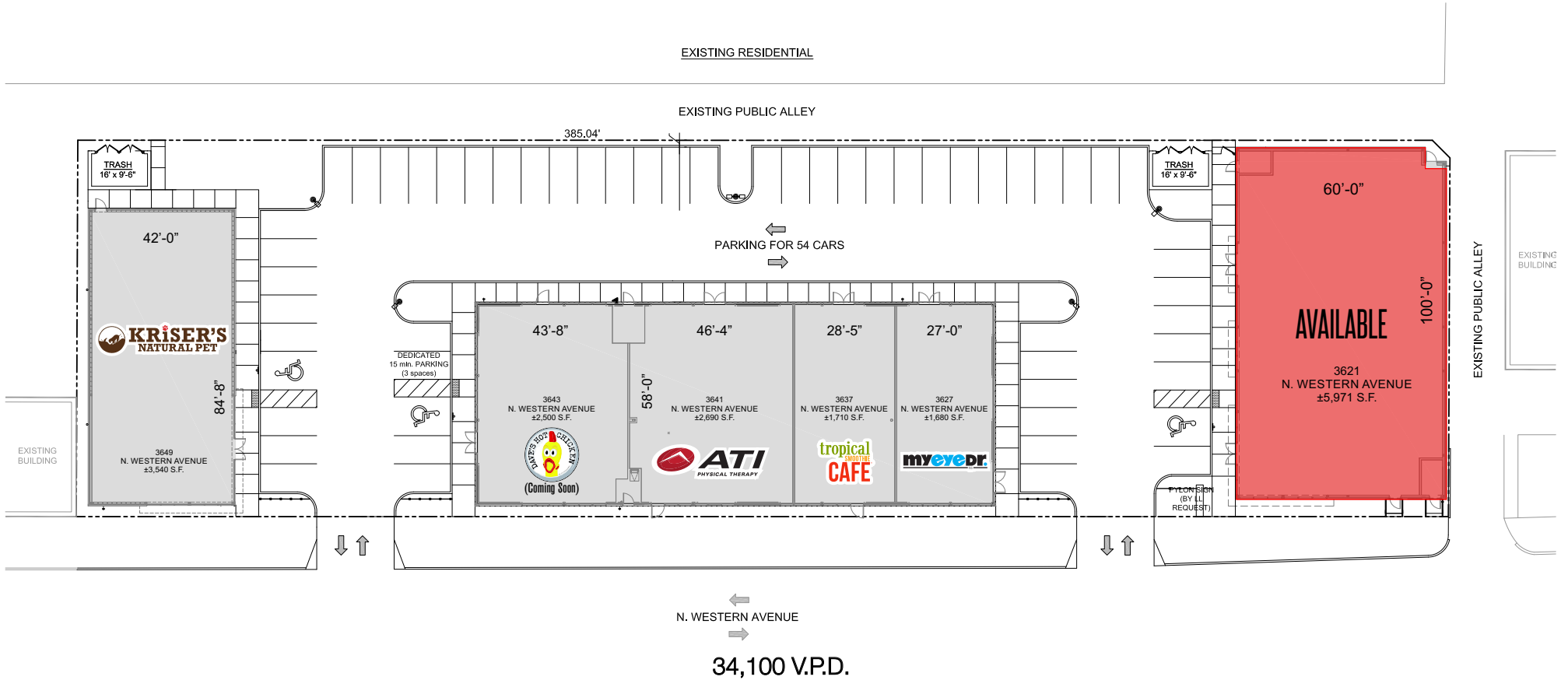

SPACE DETAILS

Endcap Availability – 5,971 SF (Divisible)



3621-3651 NORTH WESTERN AVENUE

roscoe village / chicago, il

AERIAL MAP

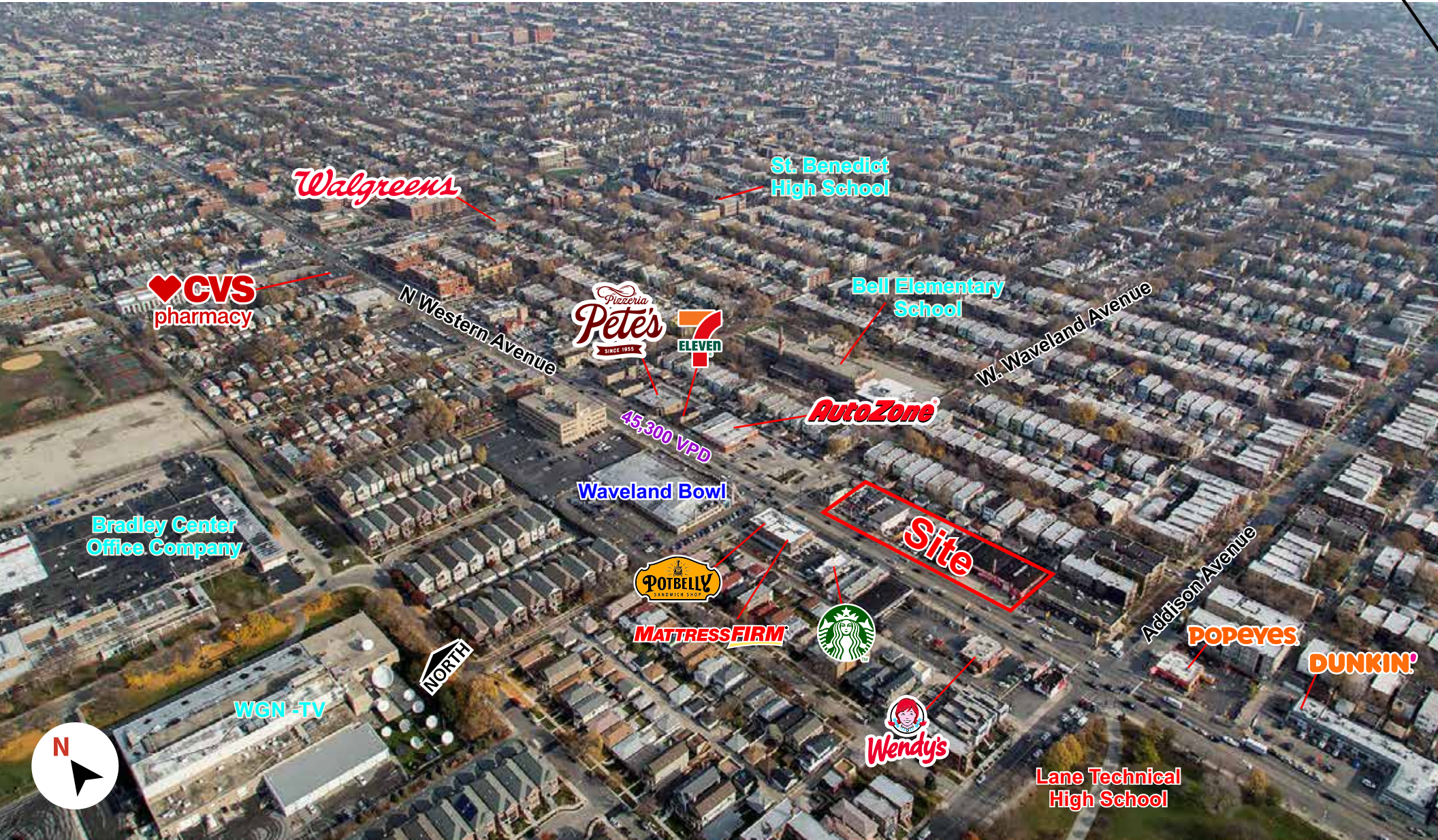

Walgreens

St. Benedict High School

CVS pharmacy

N Western Avenue

Pizzeria Pete's
SINCE 1955
7 ELEVEN

Bell Elementary School

W. Waveland Avenue

45,300 VPD

AutoZone

Waveland Bowl

Bradley Center Office Company

Site

POTBELLY SANDWICH SHOP

MATTRESS FIRM



Addison Avenue

POPEYES

DUNKIN'

WGN-TV

NORTH

Wendy's

Lane Technical High School





let's talk. **BIG IDEAS?**

PAUL BRYANT

Mid-America Real Estate Corporation
630.954.7354
PBryant@MidAmericaGrp.com

WESTIN KANE

Mid-America Real Estate Corporation
630.954.7447
WKane@MidAmericaGrp.com



MID-AMERICA[®] URBAN