

WESTSTATE ARIZONA COMMERCE CENTER

PHOENIX, ARIZONA

7225 WEST ROOSEVELT STREET
825 NORTH 73RD AVENUE

AVAILABLE: 7225 W. ROOSEVELT STREET
SUITE 172: 7,372 SF (9/1/19)
SUITE 180: 7,372 SF (9/1/19)

825 N. 73RD AVENUE
SUITE 134: 32,318 SF (10/1/19)



±231,166 SQUARE FEET IN TWO BUILDINGS

FOR LEASE

All information furnished regarding property for sale, rental or financing is from sources deemed reliable, but no warranty or representation is made to the accuracy thereof and same is submitted to errors, omissions, change of price, rental or other conditions prior to sale, lease or financing or withdrawal without notice. No liability of any kind is to be imposed on the broker herein.

JEFF CONRAD, SIOR
PRINCIPAL
602.954.3743
jconrad@leearizona.com

MATT HOBAICA, SIOR
PRINCIPAL
602.954.3755
mhobaica@leearizona.com

ejm
EJM DEVELOPMENT CO.
www.ejmdevelopment.com

LA LEE & ASSOCIATES
COMMERCIAL REAL ESTATE SERVICES

WESTSTATE ARIZONA COMMERCE CENTER

PHOENIX, ARIZONA

7225 WEST ROOSEVELT STREET

825 NORTH 73RD AVENUE



▲ Truckwell ● Grade Level

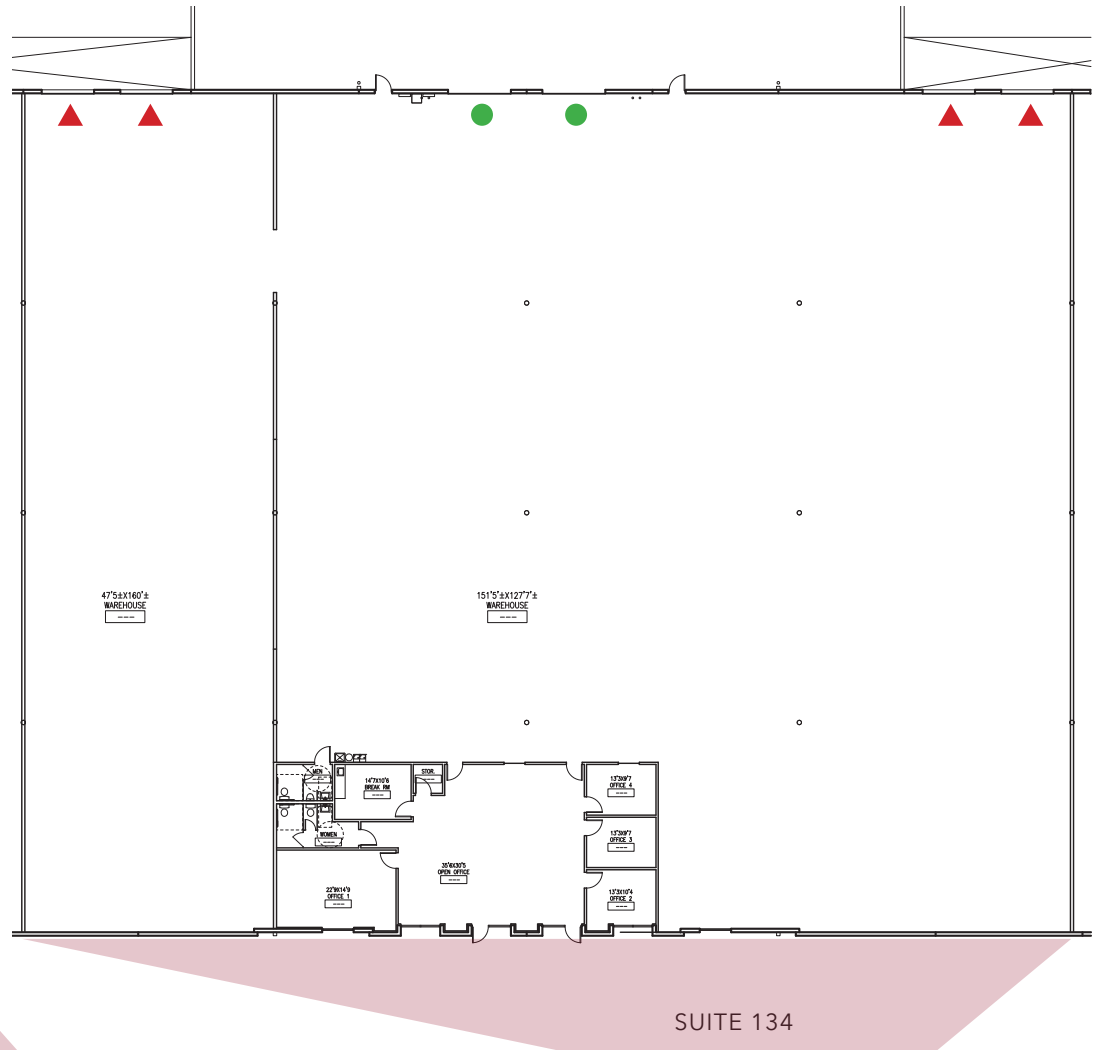
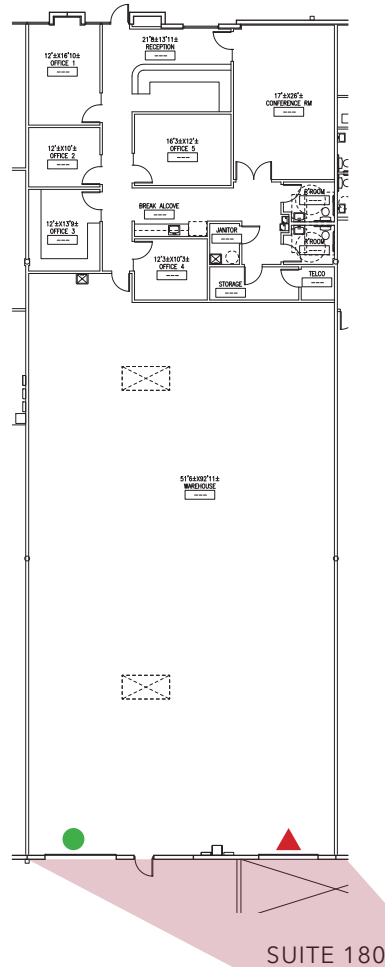
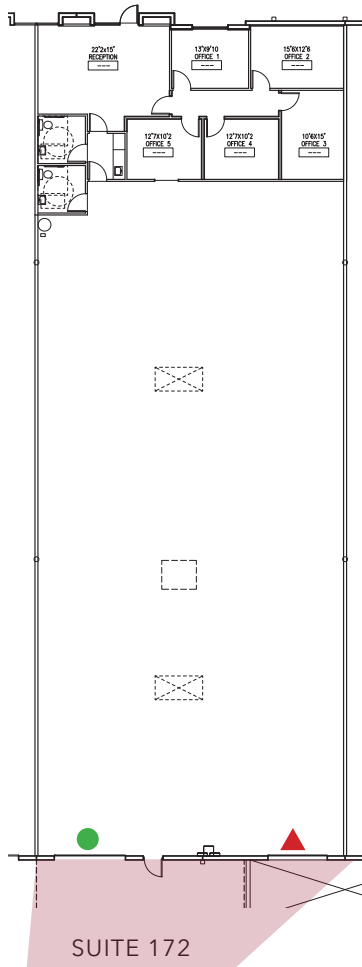

7225 W. ROOSEVELT STREET SUITE 172

- 7,372 SF
- 1,474 SF of Office
- 1 Dock Door /
1 Grade Level Door
- Evap Cooled Warehouse
- 24' Clear
- Power: 200A, 277/480V
- Covered Parking
- Rate: \$.54/SF NNN

SUITE 180

- 7,372 SF
- 2,292 SF of Office
- 1 Dock Door /
1 Grade Level Door
- Evap Cooled Warehouse
- 24' Clear
- Power: 200A, 277/480V
- Covered Parking
- Rate: \$.54/SF NNN

825 N. 73RD AVE SUITE 134

- 32,318 SF
- 2,236 SF of Office
- Evap Cooled Warehouse
- 4 Dock Doors /
2 Grade Level Doors
- 24' Clear
- Power: 200A, 277/480V
- Covered Parking
- Rate: \$.45/SF NNN

WESTSTATE ARIZONA COMMERCE CENTER

PHOENIX, ARIZONA

7225 WEST ROOSEVELT STREET

825 NORTH 73RD AVENUE



FOR LEASE

JEFF CONRAD, SIOR
PRINCIPAL
602.954.3743
jconrad@learizona.com

MATT HOBAICA, SIOR
PRINCIPAL
602.954.3755
mhobaica@learizona.com

ejm
EJM DEVELOPMENT CO.
www.ejmdevelopment.com

LA LEE &
ASSOCIATES
COMMERCIAL REAL ESTATE SERVICES