

BANK BUILDING FOR SALE

3201 LEHIGH STREET, ALLENTOWN, PA

±2,352 SF ON ±.80 ACRES FOR SALE



property highlights.

- Free standing bank building located on bustling Lehigh Street
- Accesible from Lehigh Street and 33rd Street
- Directly across from the largest Mall in Allentown with total GLA: ±405,272 SF; servicing the south side of Emmaus, Salisbury Twp., and Lower Macungie Twp
- Premier Visibility on Lehigh Street with 25,965 VPD
- Zoning: C3
- Property Tax Estimate (2019): \$16,874.56
- Asking Price: \$950,000

stats.

2019 DEMOGRAPHICS*	1 MILE	3 MILES	5 MILES
EST. POPULATION	7,550	71,859	207,501
EST. HOUSEHOLDS	3,225	27,837	77,366
EST. AVG. HH INCOME	\$85,618	\$75,917	\$78,241



METRO[®]
COMMERCIAL
REAL ESTATE, INC.

MetroCommercial.com | PHILADELPHIA, PA | PLYMOUTH MEETING, PA | MOUNT LAUREL, NJ | NAPLES, FL

get in touch.

GREG JONES

office 610.825.5222

direct 610.260.2662

gjones@metrocommercial.com



*DEMOGRAPHICS BASED ON A 5-MILE RADIUS

204,070



TOTAL POPULATION



76,091
AVERAGE HH INCOME



75,851
TOTAL HOUSEHOLDS



200,163
DAYTIME POPULATION

5 Mile Schools and Colleges

- Emmaus High School - 2,619
- Cedar Crest College - 1,885
- South Mountain Middle School - 932
- Dodd Hiram W Elementary School - 648
- St Thomas More School - 618
- Salisbury Middle School - 379
- The Swain School - 320
- Lehigh Park Elementary School - 314
- Jefferson Elementary School - 259
- Western Salisbury Elementary School - 230
- Lehigh Christian Academy - 212

Major Employers

- Lehigh Valley Hospital - 6,579
- Dorney Park & Wildwater Kingdom - 3,000
- Talen Energy Marketing - 1,371
- PPL Corp - 1,200
- Good Shepherd Rehab Network - 1,100
- Rodale Inc - 1,000
- Good Shepherd Rehab Hospital - 909
- Sacred Heart Hospital - 830
- Olympus Corp Of The Americas - 800
- Cedarbrook Nursing Home - 780
- Dun & Bradstreet Corp - 700

Major Attractions

- Dorney Park
- Wildlands Conservancy South Mountain Preserve
- South Mountain Trail
- Lehigh Country Club
- The Promenade Shops at Saucon Valley
- Allentown Rose Gardens

3201 LEHIGH STREET
ALLENTOWN, PA



The information and images contained herein are from sources deemed reliable. However, Metro Commercial Real Estate, Inc. makes no representation whatsoever as to their accuracy or authenticity. Images shown may be modified for illustrative purposes. Images may be out-of-date and not current. 5.14.20

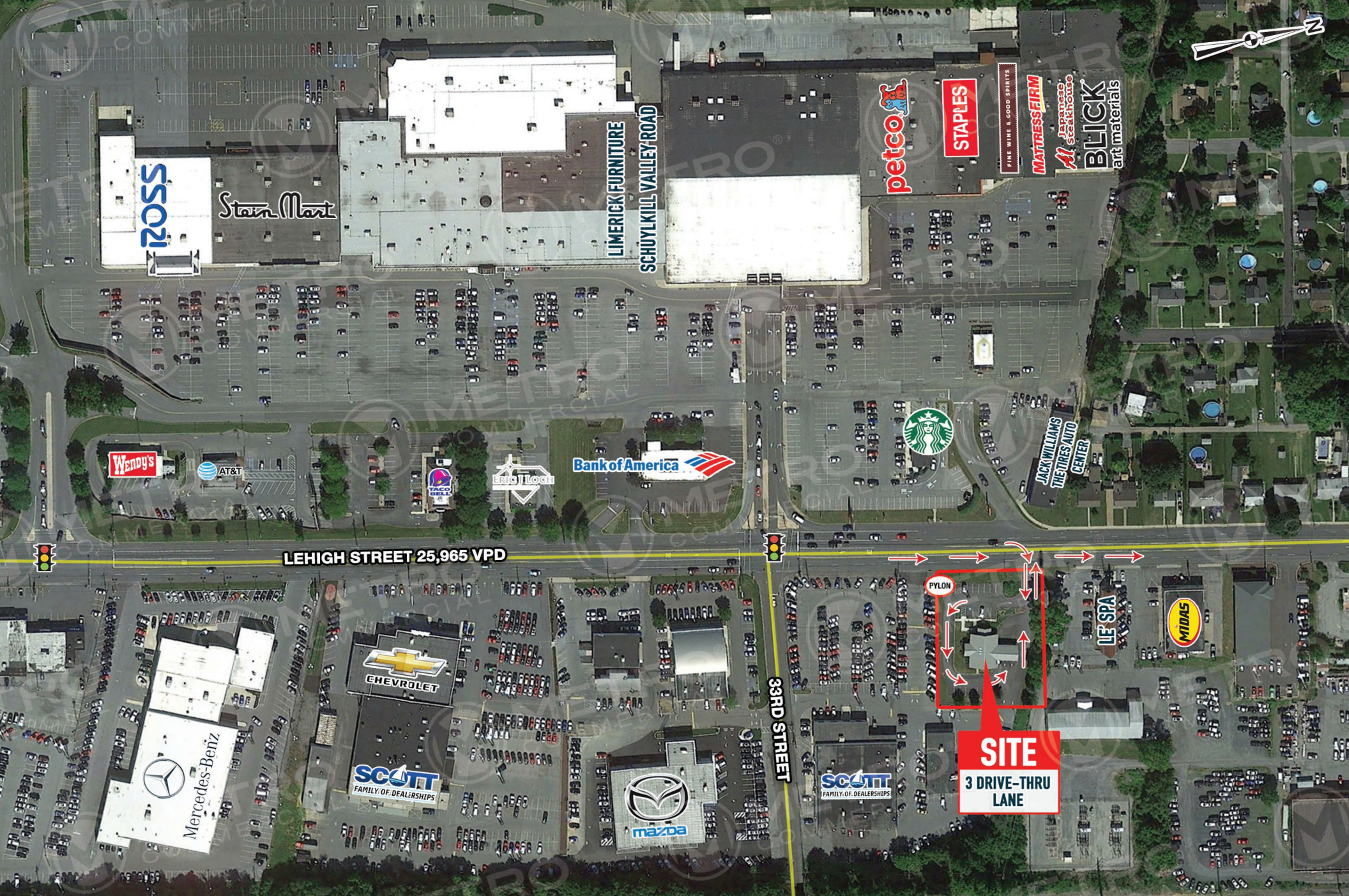

The information and images contained herein are from sources deemed reliable. However, Metro Commercial Real Estate, Inc. makes no representation whatsoever as to their accuracy or authenticity. Images shown may be modified for illustrative purposes. Images may be out-of-date and not current. 5.14.20

**3201 LEHIGH STREET
ALLENTOWN, PA**



LEHIGH STREET 25,965 VPD

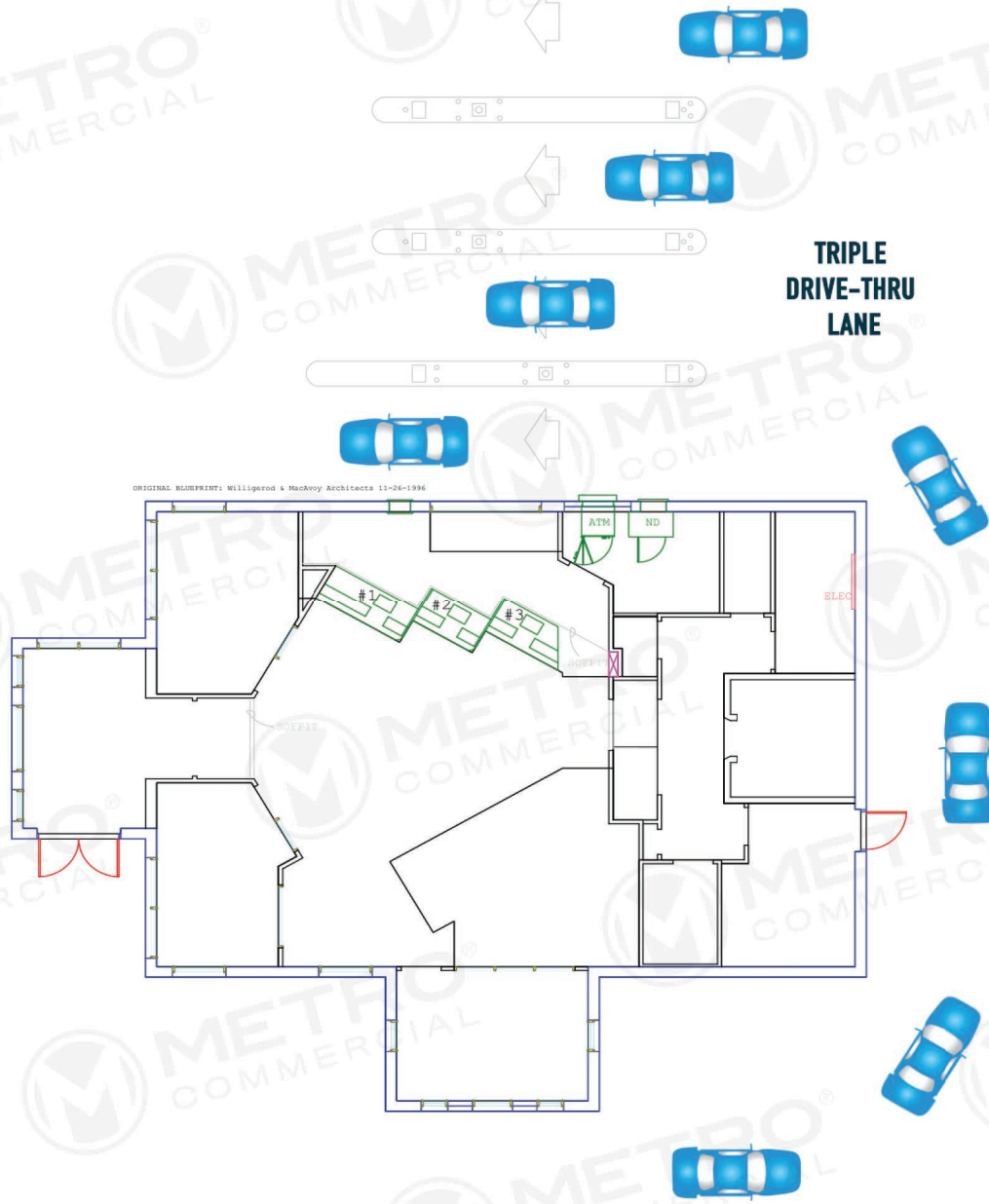

ORIGINAL BLUEPRINTS: Willigerod & Mackay Architects 11-26-1996

The information and images contained herein are from sources deemed reliable. However, Metro Commercial Real Estate, Inc. makes no representation whatsoever as to their accuracy or authenticity. Images shown may be modified for illustrative purposes. Images may be out-of-date and not current. 5.14.20

3201 LEHIGH STREET
ALLENTOWN, PA



The information and images contained herein are from sources deemed reliable. However, Metro Commercial Real Estate, Inc. makes no representation whatsoever as to their accuracy or authenticity. Images shown may be modified for illustrative purposes. Images may be out-of-date and not current. 5.14.20

3201 LEHIGH STREET
ALLENTOWN, PA





The information and images contained herein are from sources deemed reliable. However, Metro Commercial Real Estate, Inc. makes no representation whatsoever as to their accuracy or authenticity. Images shown may be modified for illustrative purposes. Images may be out-of-date and not current. 5.14.20

**3201 LEHIGH STREET
ALLENTOWN, PA**

