

2 CAL PLAZA | 350 SOUTH GRAND



BUILDING SNAPSHOT

Rental Rate: Negotiable

NNN: \$10.90 PSF per annum

Possession: Immediate

Term: 10 Years

Parking: 1,200 Parking Stalls

Total Retail GLA: 80,000 SF

BUNKER HILL SNAPSHOT

1 Cal: 1.2 Million SF of Office Space

2 Cal: 1.4 Million SF of Office Space

Est. Total Office: 10 Million+ SF

BUNKER HILL AMENITIES

Summer Concerts





The Broad Museum

Walt Disney Concert Hall

Dorothy Chandler Pavilion

Colburn School

MOCA

AREA DATA	 TOTAL POPULATION	 RESIDENTIAL POPULATION	 DAYTIME POPULATION	 COLLEGE EDUCATED
1 MILE RADIUS	63,640	30,948	32,692	49.3%
3 MILE RADIUS	494,283	167,521	326,762	37.7%







▲ DAYTIME PLAZA

NIGHTTIME PLAZA ►



PLAZA PLAN



STREET LEVEL

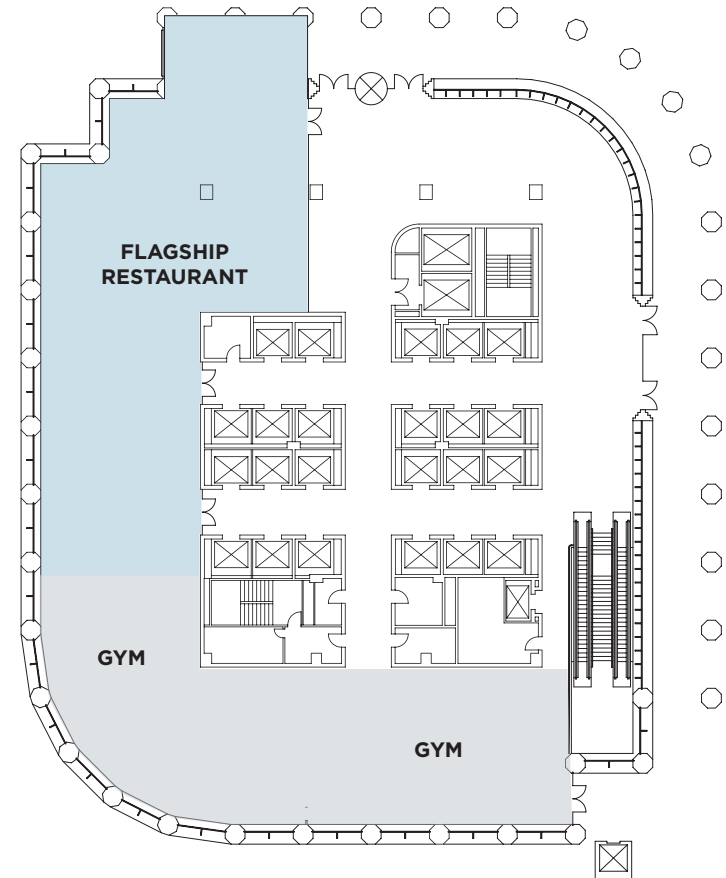



◀ PROPOSED OUTSIDE
PATIO AREA

RESTAURANT
VANTAGE POINT ▶



PLAZA PLAN



STREET LEVEL
GRAND AVENUE

PROPOSED PATIO

5,000-6,568 SF

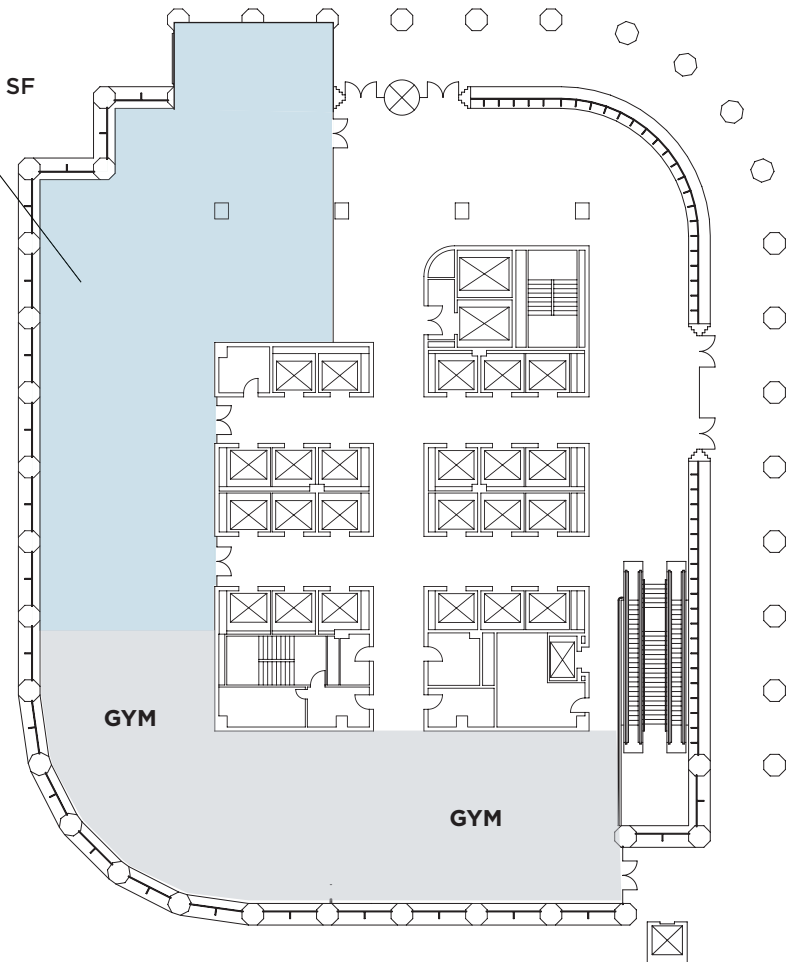

2 CAL PLAZA | GYM

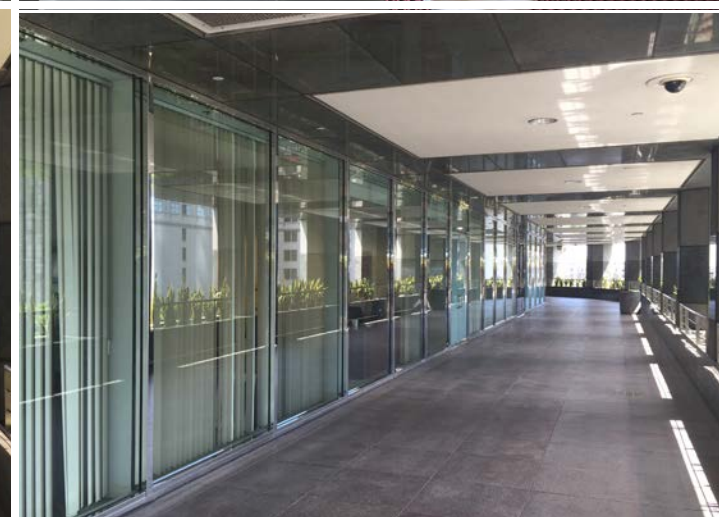
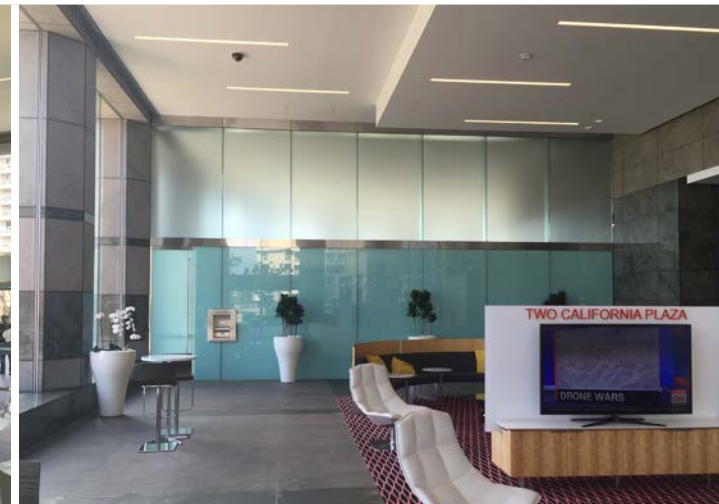
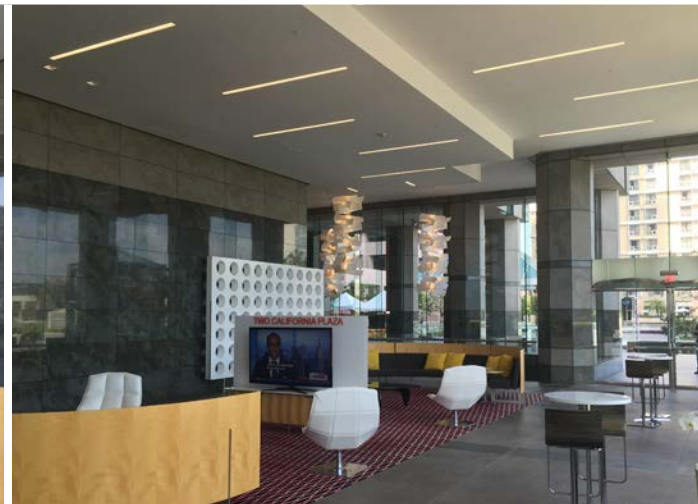

PLAZA LEVEL



STREET LEVEL

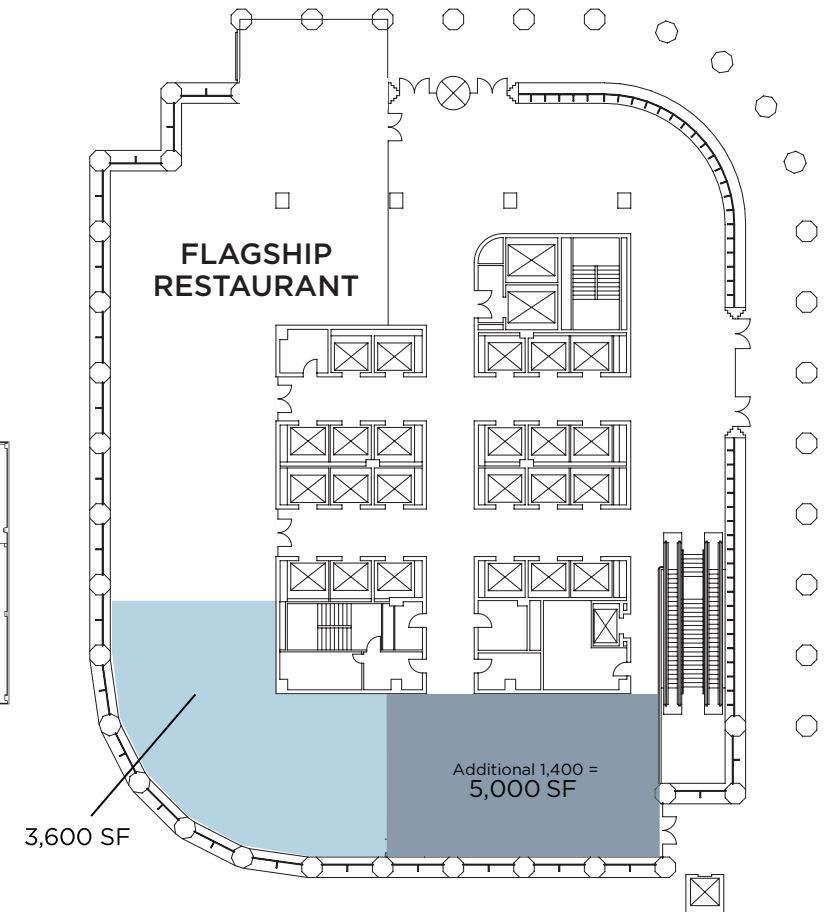

Total = 15,861 SF on two levels



- 1 Omni Los Angeles Hotel
- 2 City National Plaza
- 3 Southern California Gas Company
- 4 Wells Fargo Center
- 5 YMCA
- 6 Equinox
- 7 Bank of America
- 8 Downtown LA Farmers Market
- 9 Perch
- 10 Chase Bank
- 11 La Cita Bar
- 12 Citibank
- 13 The Standard Hotel
- 14 McCormick & Schmick's
- 15 Blue Cow Kitchen & Bar
- 16 Mixt Greens
- 17 Mendocino Farms
- 18 Pez Cantina
- 19 California Pizza Kitchen
- 20 Ocho Mexican Grill
- 21 Starbucks
- 22 Coffee Bean
- 23 Westin Bonaventure
- 24 City National Plaza
- 25 Drago Centro
- 26 Million Dollar Theatre
- 27 Bunker Hill Bar & Grill
- 28 Bank of the West
- 29 Colburn School
- 30 Museum Tower Apartments
- 31 MOCA
- 32 Noe Restaurant
- 33 Horse Thief BBQ
- 34 Grand Central Market

MUSEUMS AND HOTELS



2 **THE BROAD**

3 **LA PHIL** | WALT DISNEY CONCERT HALL

4 **DOROTHY CHANDLER PAVILION**

5 **COLBURN**
SCHOOL

6 **OMNI HOTEL**

7 **EQUINOX HOTEL**

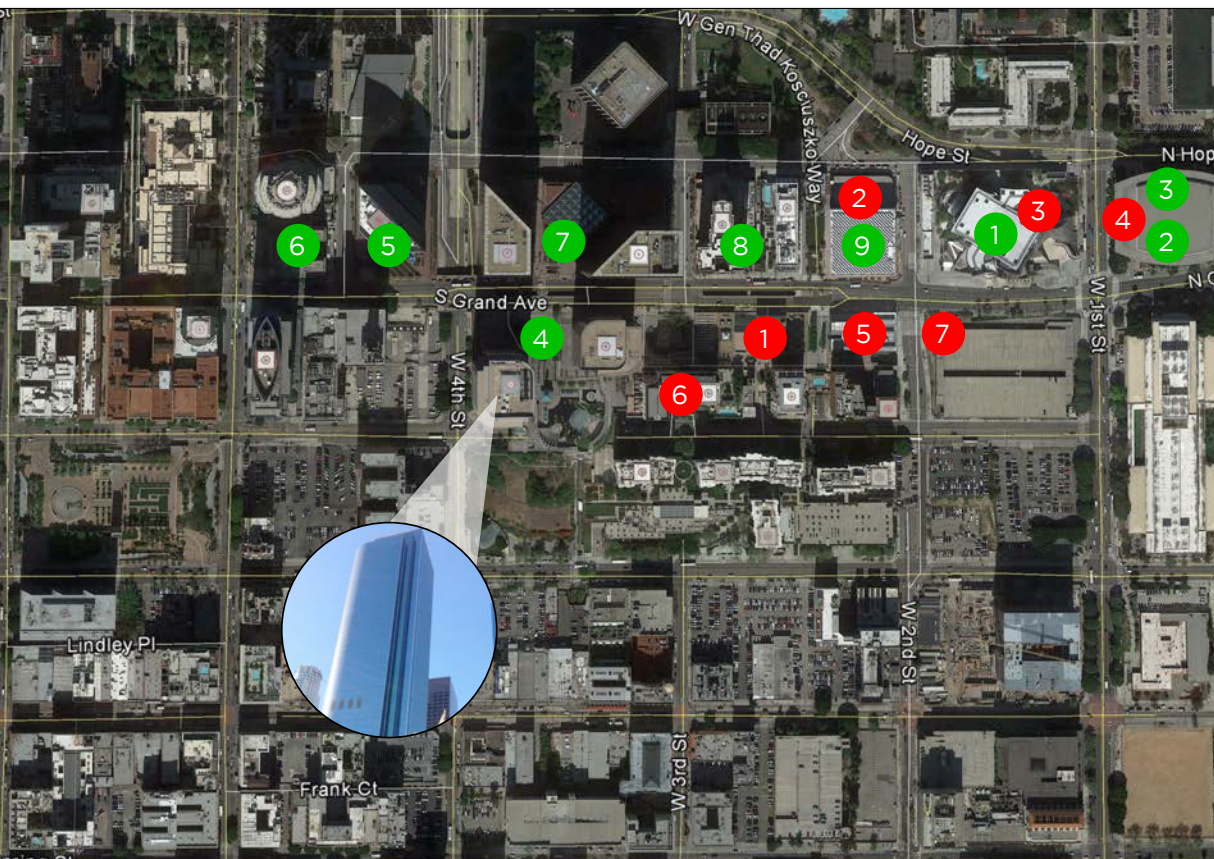

FULL SERVICE SIT DOWN RESTAURANTS

1 **PATINA**

2 **KENDALL'S | BRASSERIE**

3 **pinot grill**

4 **BLUE COW**
kitchen & bar

5 **PEZ CANTINA**
COASTAL MEXICAN KITCHEN

6 **THE BUNKER HILL**
BAR & GRILL

7 **NICK & STEF'S STEAKHOUSE**

8 **Vespaio**

9 **Otium**

For more information please contact:

CARTER MAGNIN

(310)-595-2203

carter.magnin@cushwake.com

Lic. #01909728

MATTHEW FAINCHEIN

(310)-595-2234

matthew.fainchtein@cushwake.com

Lic. #00616335

JAMES DUNCANSON

(310)-595-2213

james.duncanson@cushwake.com

Lic. #01965712



Cushman & Wakefield of California, Inc
10250 Constellation Boulevard, Suite 2200
Los Angeles, CA 90067