



1775

WOODSIDE

[WWW.1775WOODSIDE.COM](http://WWW.1775WOODSIDE.COM)

**Ben Paul**  
Executive Managing Director  
+1 650 401 2123  
[ben.paul@cushwake.com](mailto:ben.paul@cushwake.com)  
LIC #01210872

**Chris Blom**  
Senior Associate  
+1 650 931 2210  
[chris.blom@cushwake.com](mailto:chris.blom@cushwake.com)  
LIC #02031205

Cushman & Wakefield Copyright 2020. No warranty or representation, express or implied, is made to the accuracy or completeness of the information contained herein, and same is submitted subject to errors, omissions, change of price, rental or other conditions, withdrawal without notice, and to any special listing conditions imposed by the property owner(s). As applicable, we make no representation as to the condition of the property (or properties) in question.

View Site Specific  
**COVID-19**  
PREVENTION PLAN



**21,438 RSF**  
AVAILABLE

## PROPERTY HIGHLIGHTS

Full interior, exterior & lobby renovations.  
6 brand new spec suites with all glass  
office/conference rooms and kitchens  
in every suite.

- Covered parking available onsite with EV charging
- Monument signage with nighttime lighting available – High traffic count + visibility

## AVAILABILITIES:

<b>Suite 201</b>	3,312 RSF
<b>Suite 202</b>	2,410 RSF
<b>Suite 203</b>	3,327 RSF
<b>Suite 204</b>	1,893 RSF
<b>Suite 301</b>	4,977 RSF
<b>Suite 302</b>	5,520 RSF
<b>Total:</b>	<b>21,438 RSF</b>



# 1775

## WOODSIDE

[WWW.1775WOODSIDE.COM](http://WWW.1775WOODSIDE.COM)

**Ben Paul**  
Executive Managing  
Director  
+1 650 401 2123  
[ben.paul@cushwake.com](mailto:ben.paul@cushwake.com)  
LIC #01210872

**Chris Blom**  
Senior Associate  
+1 650 931 2210  
[chris.blom@cushwake.com](mailto:chris.blom@cushwake.com)  
LIC #02031205

Cushman & Wakefield Copyright 2020. No warranty or representation, express or implied, is made to the accuracy or completeness of the information contained herein, and same is submitted subject to errors, omissions, change of price, rental or other conditions, withdrawal without notice, and to any special listing conditions imposed by the property owner(s). As applicable, we make no representation as to the condition of the property (or properties) in question.

## 21,438 RSF AVAILABLE

# FLOORPLANS 2ND FLOOR

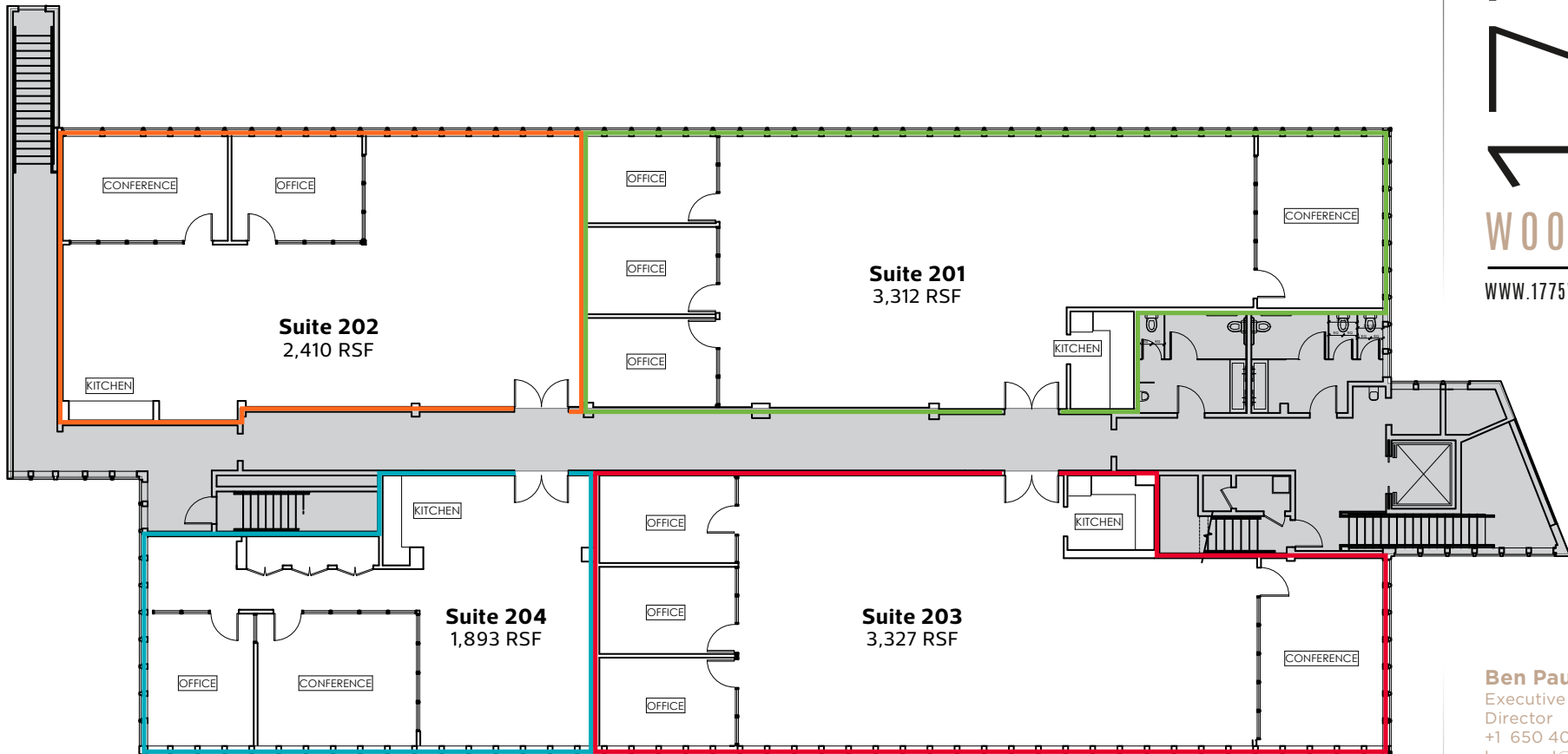

1775

WOODSIDE

WWW.1775WOODSIDE.COM

**Ben Paul**  
 Executive Managing Director  
 +1 650 401 2123  
 ben.paul@cushwake.com  
 LIC #01210872

**Chris Blom**  
 Senior Associate  
 +1 650 931 2210  
 chris.blom@cushwake.com  
 LIC #02031205

Cushman & Wakefield Copyright 2020. No warranty or representation, express or implied, is made to the accuracy or completeness of the information contained herein, and same is submitted subject to errors, omissions, change of price, rental or other conditions, withdrawal without notice, and to any special listing conditions imposed by the property owner(s). As applicable, we make no representation as to the condition of the property (or properties) in question.

# FLOORPLANS 3RD FLOOR

1775

WOODSIDE

WWW.1775WOODSIDE.COM

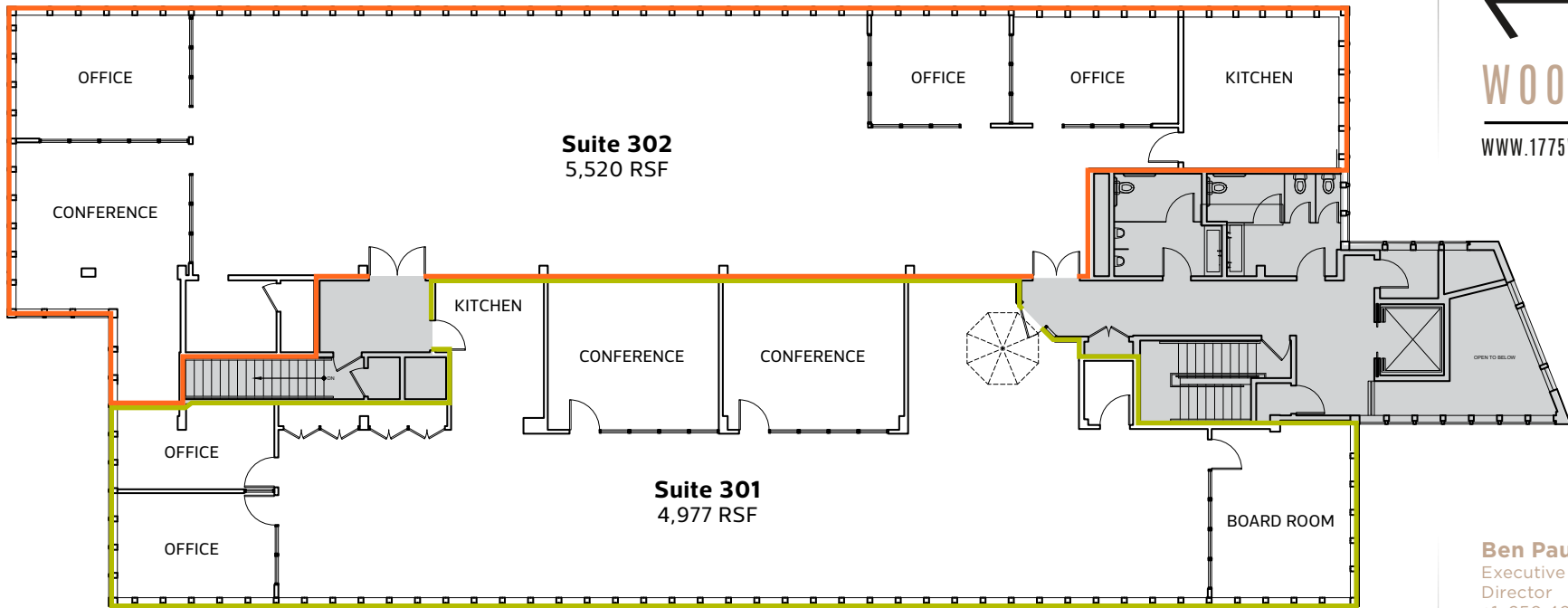

■ - COMMON AREA

**Ben Paul**  
Executive Managing Director  
+1 650 401 2123  
ben.paul@cushwake.com  
LIC #01210872

**Chris Blom**  
Senior Associate  
+1 650 931 2210  
chris.blom@cushwake.com  
LIC #02031205

Cushman & Wakefield Copyright 2020. No warranty or representation, express or implied, is made to the accuracy or completeness of the information contained herein, and same is submitted subject to errors, omissions, change of price, rental or other conditions, withdrawal without notice, and to any special listing conditions imposed by the property owner(s). As applicable, we make no representation as to the condition of the property (or properties) in question.

1775  
WOODSIDE  
WWW.1775WOODSIDE.COM

4 MINUTES TO HIGHWAY 280  
7 MINUTES TO HIGHWAY 101  
10 MINUTES TO DOWNTOWN  
REDWOOD CITY AND ACCESS TO  
100's OF AMENITIES

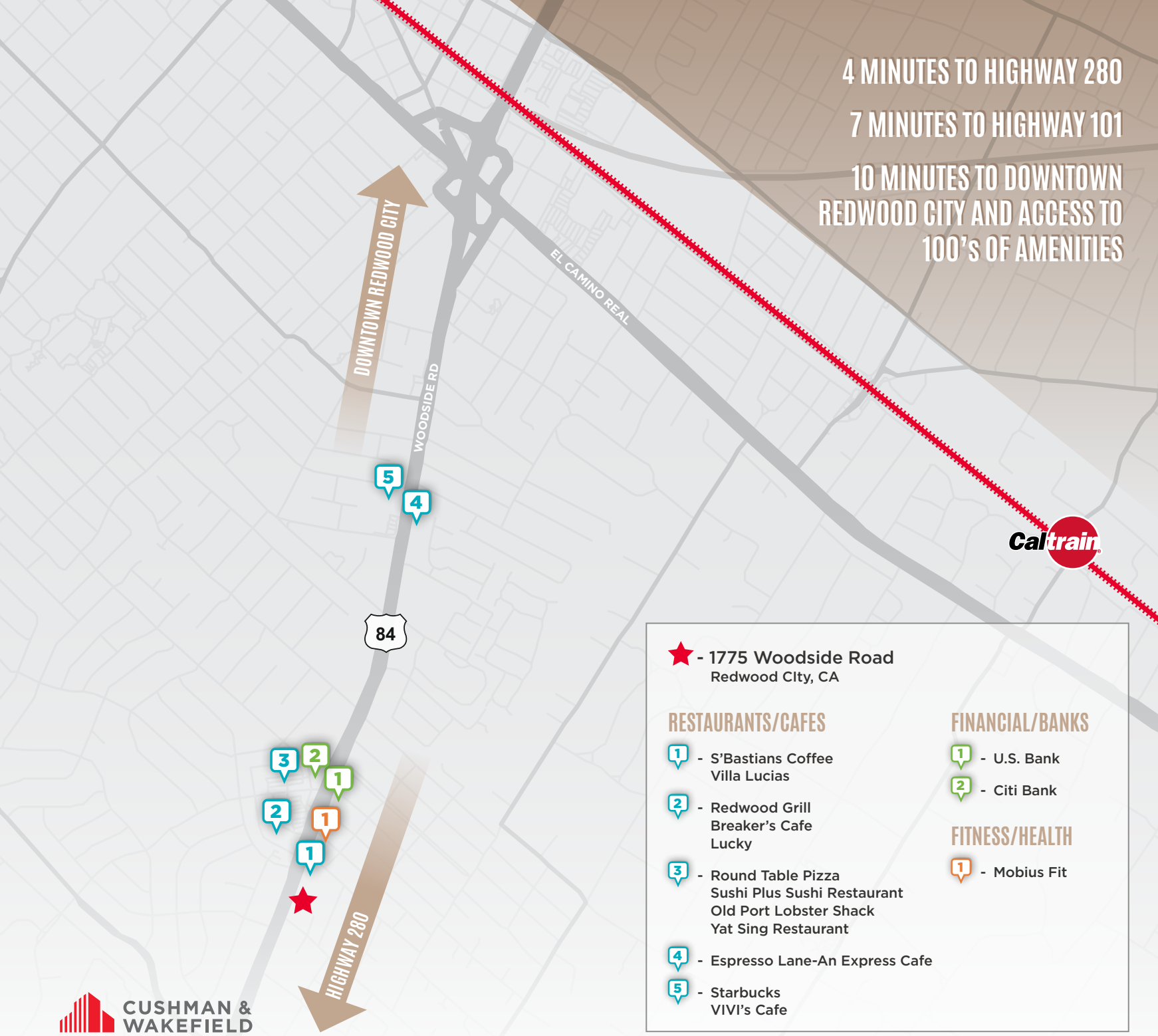

★ - 1775 Woodside Road  
Redwood City, CA

**RESTAURANTS/CAFES**

- 1 - S'Bastians Coffee  
Villa Lucias
- 2 - Redwood Grill  
Breaker's Cafe  
Lucky
- 3 - Round Table Pizza  
Sushi Plus Sushi Restaurant  
Old Port Lobster Shack  
Yat Sing Restaurant
- 4 - Espresso Lane-An Express Cafe
- 5 - Starbucks  
VIVI's Cafe

**FINANCIAL/BANKS**

- 1 - U.S. Bank
- 2 - Citi Bank

**FITNESS/HEALTH**

- 1 - Mobius Fit



**Ben Paul**  
Executive Managing Director  
+1 650 401 2123  
ben.paul@cushwake.com  
LIC #01210872

**Chris Blom**  
Senior Associate  
+1 650 931 2210  
chris.blom@cushwake.com  
LIC #02031205

Cushman & Wakefield Copyright 2020. No warranty or representation, express or implied, is made to the accuracy or completeness of the information contained herein, and same is submitted subject to errors, omissions, change of price, rental or other conditions, withdrawal without notice, and to any special listing conditions imposed by the property owner(s). As applicable, we make no representation as to the condition of the property (or properties) in question.