

## Capital Medical Office Buildings I & II

601 McPhee Road SW  
Olympia, WA

New construction Class "A"  
Medical Office Buildings

Located adjacent to Capital  
Medical Center

BUILDING I - ±2,400 SF up to  
±15,552 SF available

BUILDING II - 100% leased to  
Capital Medical Center  
-Imaging Center and  
Outpatient Clinic  
-Advanced Wound Care

Tenant improvement allowance  
available

Great Parking: Ratio of  
4.61/1000

Rental Rate: \$20.00 PSF, NNN

Signage available



### Contact

**Evan Parker**  
360.705.0174  
eparker@kiddermathews.com

## Capital Medical Office Buildings I & II

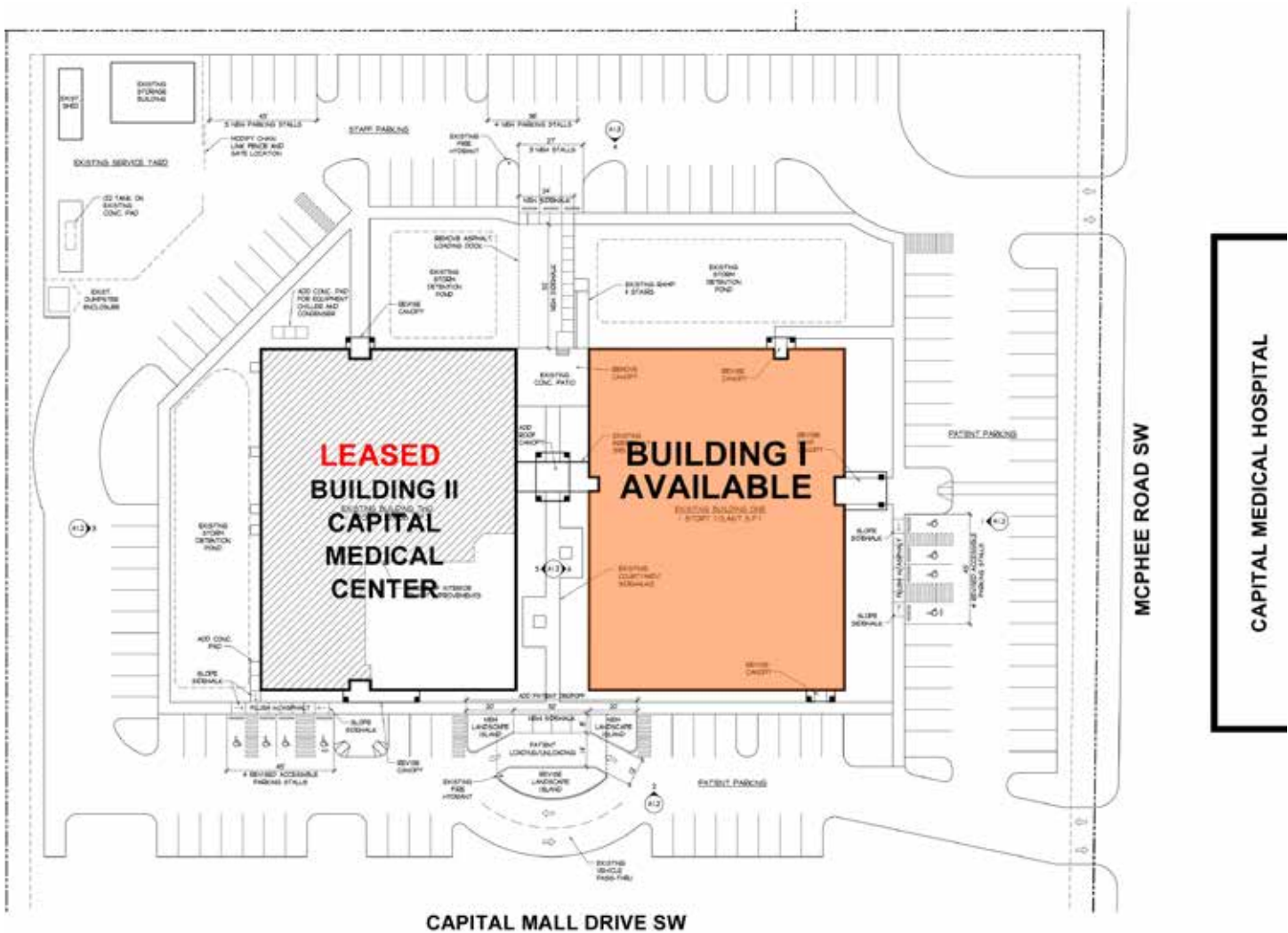

### Contact

**Evan Parker**  
360.705.0174  
[eparker@kiddermathews.com](mailto:eparker@kiddermathews.com)

## Capital Medical Office Buildings I & II

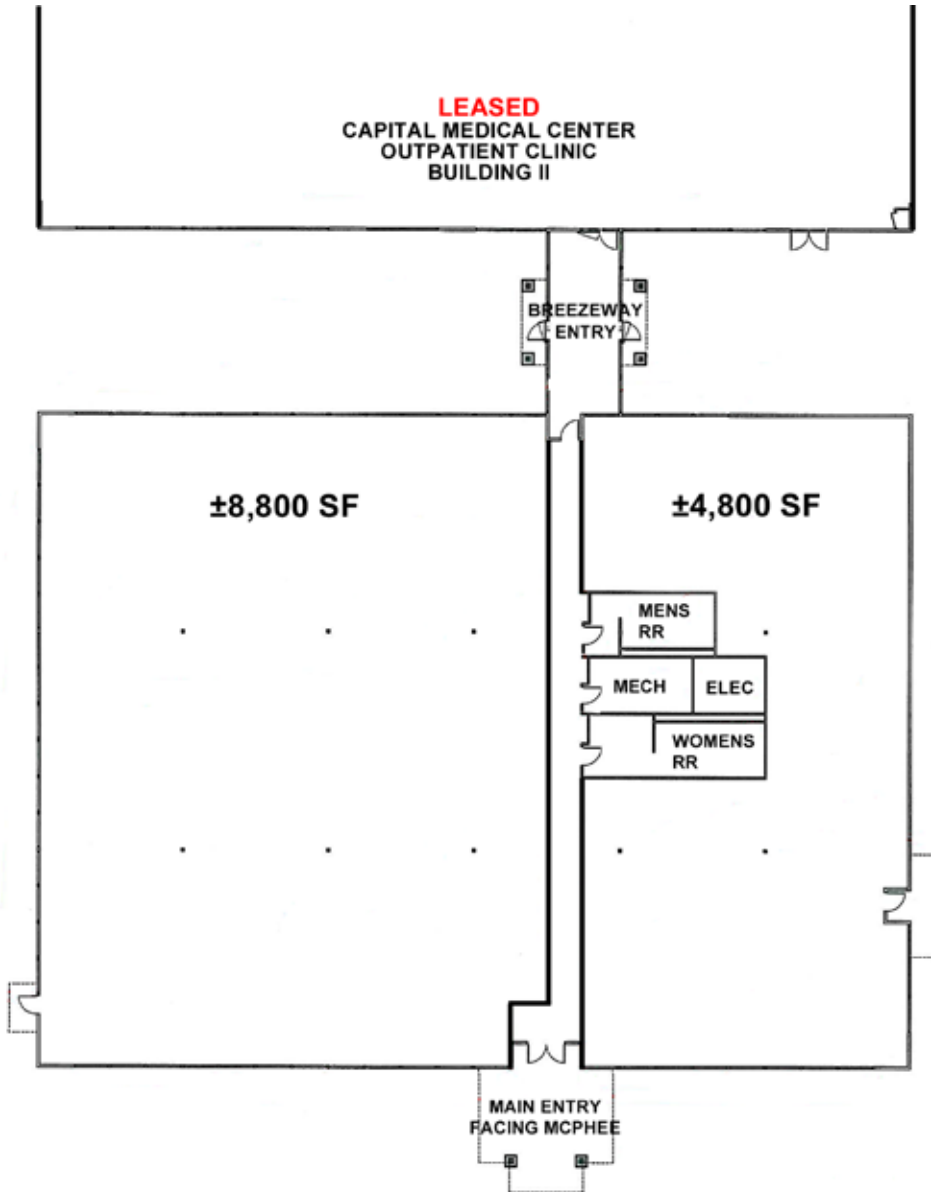

**CAPITAL MEDICAL CENTER - BLDG I**

### Contact

**Evan Parker**  
360.705.0174  
eparker@kiddermathews.com