

3409 West 12600 South, Riverton, UT 84065

OFFICE
FOR LEASE

Oquirrh Shadow Offices

3409 West 12600 South
Riverton, UT 84065

OFFICE
FOR LEASE



PROPERTY INFORMATION

- > Suite 210: 2,283 SF \$17.00 NNN
- > Suite 200: 2,218 USF \$20.00 Full service
- > Gorgeous finishes in a beautiful colonial style
- > Close Location To Bangerter Highway
- > Ample Parking
- > Monument Signage and Exterior Building Signage
- > One Block From the Riverton Hospital

DEMOGRAPHICS

	1 MILE	3 MILE	5 MILE
POPULATION			
2019 EST	15,693	111,811	243,049
2024 PROJ	16,861	119,904	260,568
HOUSEHOLDS			
2019 EST	5,850	45,393	101,965
2024 PROJ	6,311	48,917	109,841
INCOME			
2019 AVG	\$120,770	\$118,888	\$102,501
2019 MED	\$89,835	\$87,468	\$76,327

Source: Sites USA 2019

NAI Premier

7455 Union Park Avenue Ste. A, Midvale, Utah 84047
801 255 3333 | naipremier.com

NAI Premier

COMMERCIAL REAL ESTATE SERVICES, WORLDWIDE

7455 Union Park Avenue Ste. A,
Midvale, Utah 84047

801 255 3333 | naipremier.com

Jim McLachlan

d 801 619 2707

c 801 750 7991

jim@naipremier.com

NO WARRANTY OR REPRESENTATION, EXPRESS OR IMPLIED, IS MADE AS TO THE ACCURACY OF THE INFORMATION CONTAINED HEREIN, AND THE SAME IS SUBMITTED SUBJECT TO ERRORS, OMISSIONS, CHANGE OF PRICE, RENTAL OR OTHER CONDITIONS, PRIOR SALE, LEASE OR FINANCING, OR WITHDRAWAL WITHOUT NOTICE, AND OF ANY SPECIAL LISTING CONDITIONS IMPOSED BY OUR PRINCIPALS NO WARRANTIES OR REPRESENTATIONS ARE MADE AS TO THE CONDITION OF THE PROPERTY OR ANY HAZARDS CONTAINED THEREIN ARE ANY TO BE IMPLIED.

Suite 210 - 2,283 SF, \$17.00 NNN



Common Area

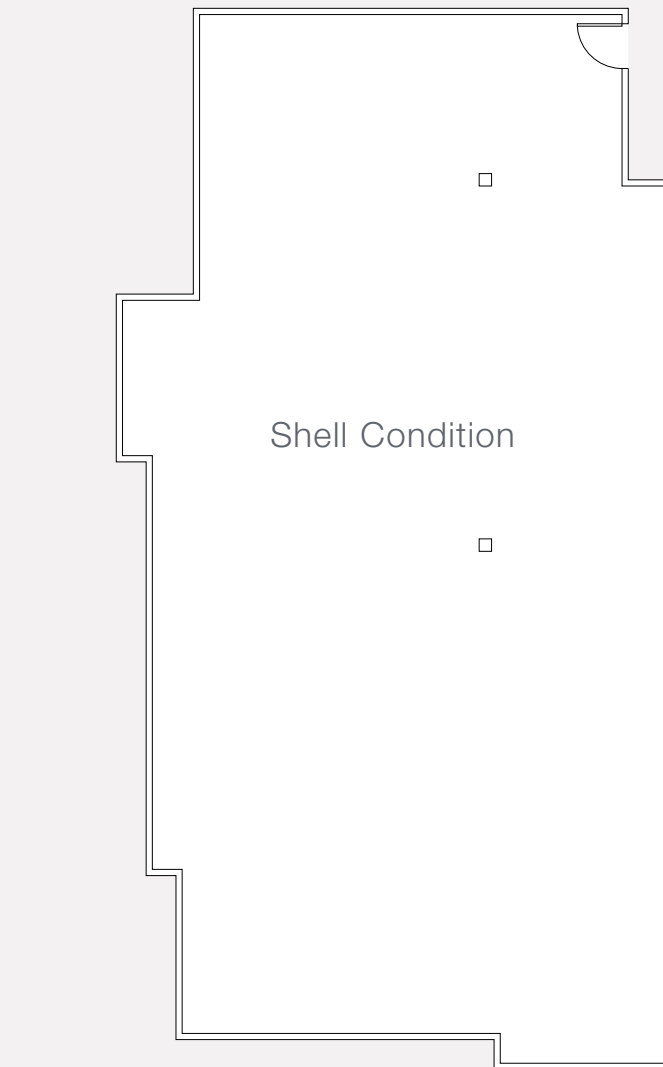

Suite 200 - 2,218 USF, \$20.00 full service

