

FOR LEASE 2,000 - 4,000 SF INDUSTRIAL SPACE

1243 GREENFIELD DRIVE, EL CAJON, CA 92021



PROPERTY OVERVIEW

- Suite E-F: 2,000 - 4,000 SF Industrial (Can Be Divided)
- Warehouse with (2) Two Grade Level Roll Doors
- 10 Parking Spaces
- Easy Access to/from Hwy 67 & I-8 Fwy
- Zoned IL in The City of El Cajon, with a General Commercial Overlay and Many Potential Uses
- Lease Rate: \$1.10/SF Gross + Electric



ROC BEAS
Sales Associate
Roc@caacre.com
BRE Lic # 01985515

MIKE CONGER
Principal
Mike@caacre.com
BRE Lic # 01381193

858.360.3000 | caacre.com

FOR LEASE

2,000 - 4,000 SF INDUSTRIAL SPACE

1243 GREENFIELD DRIVE, EL CAJON, CA 92021



SUITE E - F
2,000 - 4,000 SF

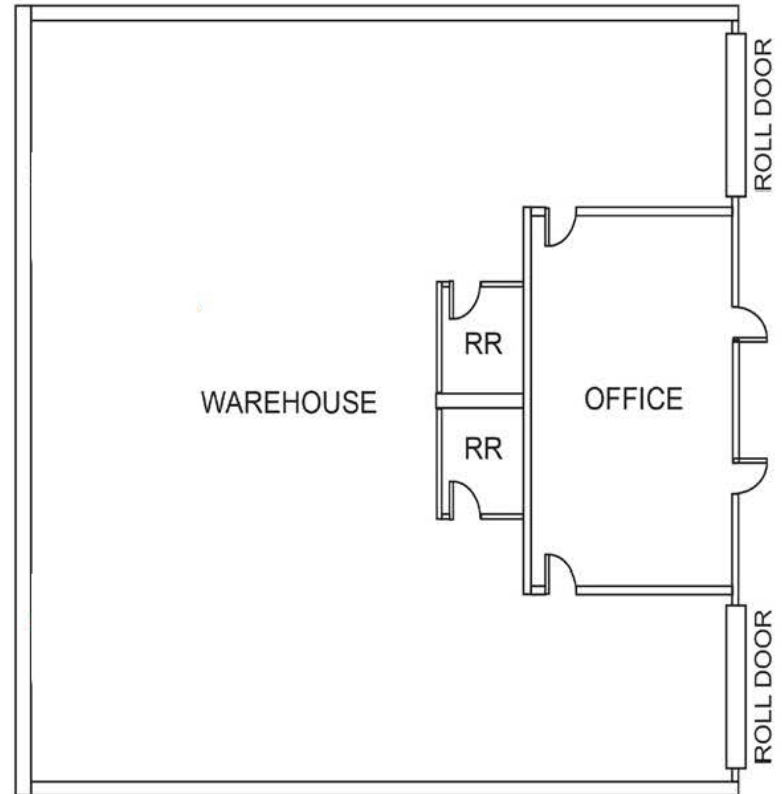

ROC BEAS
Sales Associate
Roc@caacre.com
BRE Lic # 01985515

MIKE CONGER
Principal
Mike@caacre.com
BRE Lic # 01381193

858.360.3000 | caacre.com