

PRIME RETAIL SPACE ADJACENT TO KOHL'S

Hiram, GA 30141 | 5220 Jimmy Lee Smith Parkway | Jimmy Lee Smith Pkwy & Metromont Rd | #440



AVAILABLE SF:
24,800 SF

FRONTAGE:
APPROX. 98'3"

ZONING:
COMMERCIAL

RATES:
CALL FOR DETAILS

AREA ANCHORS



- 24,800 SF junior anchor space available
- Directly next to Kohl's and Ross
- Multiple signalized and full access points
- Center co-tenants include: Target, Sam's Club, Ross, ULTA, Michael's, HomeGoods & Marshall's

DEMOGRAPHICS	1 MILE	3 MILES	5 MILES	TRAFFIC COUNTS	
2018 POPULATION	2,370	27,275	84,263	Jimmy Lee Smith Pkwy	35,700 AADT
2018 DAYTIME POPULATION	6,502	25,941	65,349		
2018 AVERAGE HH INCOME	73,367	79,412	82,047		
2018 MEDIAN HH INCOME	52,106	63,743	66,797		



FOR MORE INFORMATION, CONTACT EXCLUSIVE AGENT(S):
PATRICK BENTLEY • patrick.bentley@tscg.com • 770.955.2434

Demographics: Esri 2018 No warranty expressed or implied has been made as to the accuracy of the information provided herein, no liability assumed for error or omissions.



PRIME RETAIL SPACE ADJACENT TO KOHL'S

Hiram, GA 30141 | 5220 Jimmy Lee Smith Parkway | Jimmy Lee Smith Pkwy & Metromont Rd | #440



FOR MORE INFORMATION, CONTACT EXCLUSIVE AGENT(S):
 PATRICK BENTLEY • patrick.bentley@tscg.com • 770.955.2434



Demographics: Esri 2018 No warranty expressed or implied has been made as to the accuracy of the information provided herein, no liability assumed for error or omissions.

PRIME RETAIL SPACE ADJACENT TO KOHL'S

Hiram, GA 30141 | 5220 Jimmy Lee Smith Parkway | Jimmy Lee Smith Pkwy & Metromont Rd | #440



FOR MORE INFORMATION, CONTACT EXCLUSIVE AGENT(S):
 PATRICK BENTLEY • patrick.bentley@tscg.com • 770.955.2434



Demographics: Esri 2018 No warranty expressed or implied has been made as to the accuracy of the information provided herein, no liability assumed for error or omissions.

PRIME RETAIL SPACE ADJACENT TO KOHL'S

Hiram, GA 30141 | 5220 Jimmy Lee Smith Parkway | Jimmy Lee Smith Pkwy & Metromont Rd | #440

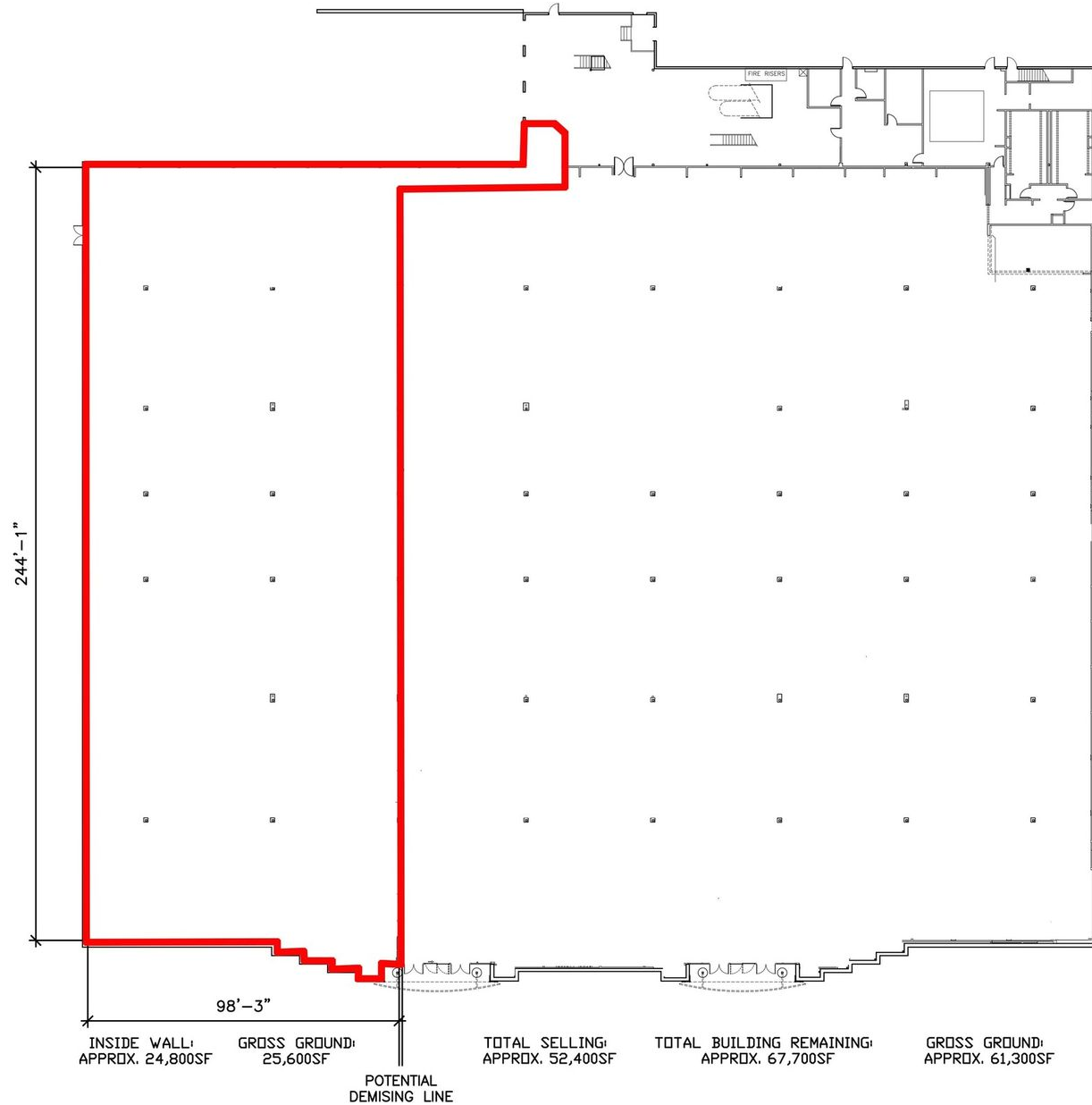

#10440 Hiram, GA
Updated: 3/6/18



FOR MORE INFORMATION, CONTACT EXCLUSIVE AGENT(S):
PATRICK BENTLEY • patrick.bentley@tscg.com • 770.955.2434

