

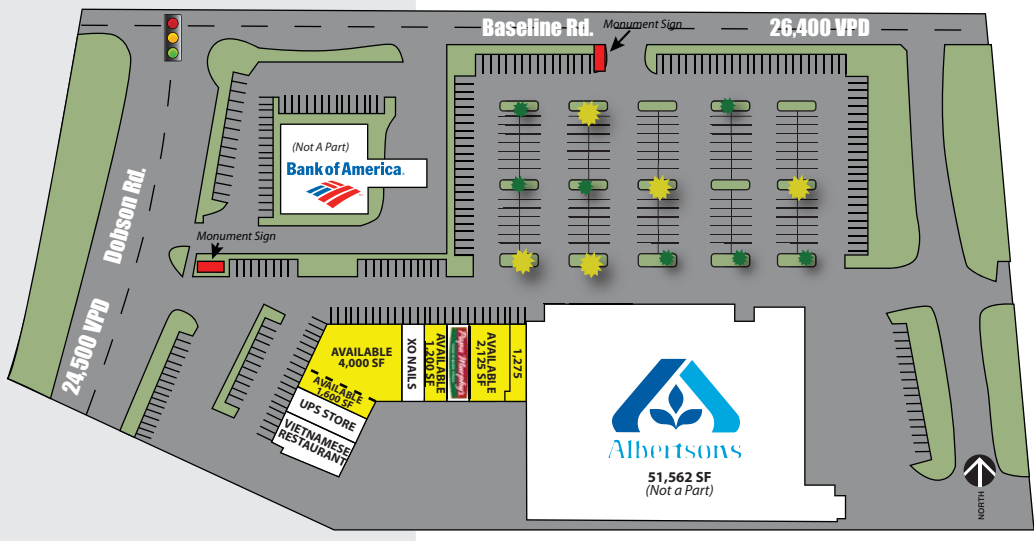

# Dobson Ranch Center

SEC Dobson & Baseline, Mesa AZ 85202



### Available Suites

1,200 Sf, - 5,600 Sf (various sizes)

### Anchor

Albertson's

### PAD Tenants

Bank of America

### Total Businesses:

- 1 mile: 1,265
- 3 miles: 8,200
- 5 miles: 20,450

### Daily Traffic Counts

- 24,500 vpd at Dobson
- 26,400 vpd at Baseline

### Total Population 2018 | Average HH Income 2018

Total Population 2018	Average HH Income 2018
1 mile: 13,789	1 mile: \$76,311
3 miles: 152,674	3 miles: \$68,824
5 miles: 411,641	5 miles: \$70,457



For Leasing Please Contact:

[www.azpre.com](http://www.azpre.com)

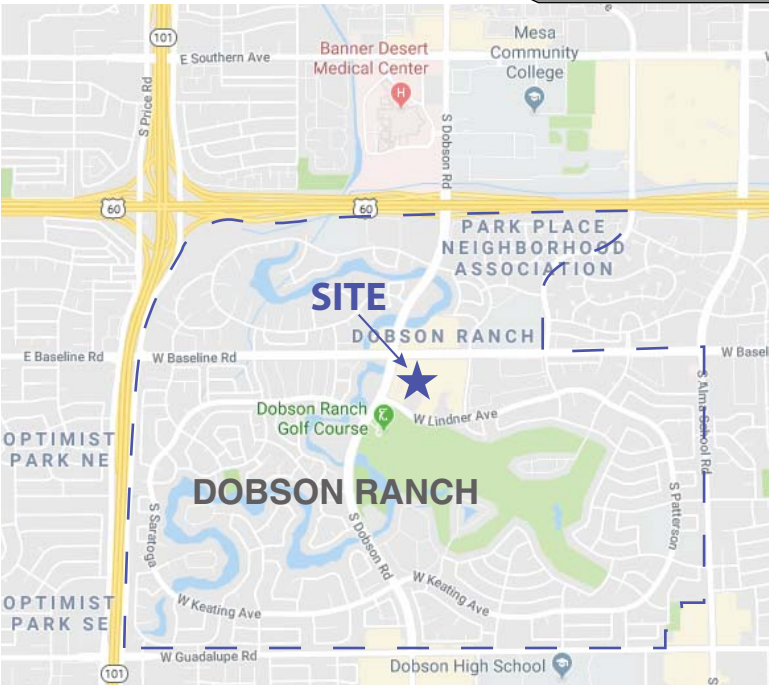

### Center Information:

- \* Located one half (1/2) mile south of **Highway 60**
- \* Located .84 miles East of **Price Freeway 101**
- \* Adjacent to entrance to **Dobson Ranch Master Planned Community**
- \* Dobson Ranch has over **15,000 residents**
- \* Located walking distance from **Rhodes Jr. High School**
- \* Located one half (1/2) mile South of **Mesa Community College (over 23,000 students enrolled in 2013)**
- \* 15 minutes from **Phoenix Sky Harbor Airport**
- \* 3 miles from **Sycamore Light Rail Station**
- \* Adjacent to city of Mesa owned **Dobson Ranch 18 hole golf course**
- \* Located one half (1/2) mile south of **Banner Desert Medical Center / Hospital**

For Leasing Please Contact:

[www.azpre.com](http://www.azpre.com)

Arizona Partners | Mercado Del Lago | 8300 N. Hayden Rd. Ste. A 200 | Scottsdale, AZ 85258 | p 480.368.0111 | f 480.368.0444





For Leasing Please Contact:

[www.azpre.com](http://www.azpre.com)



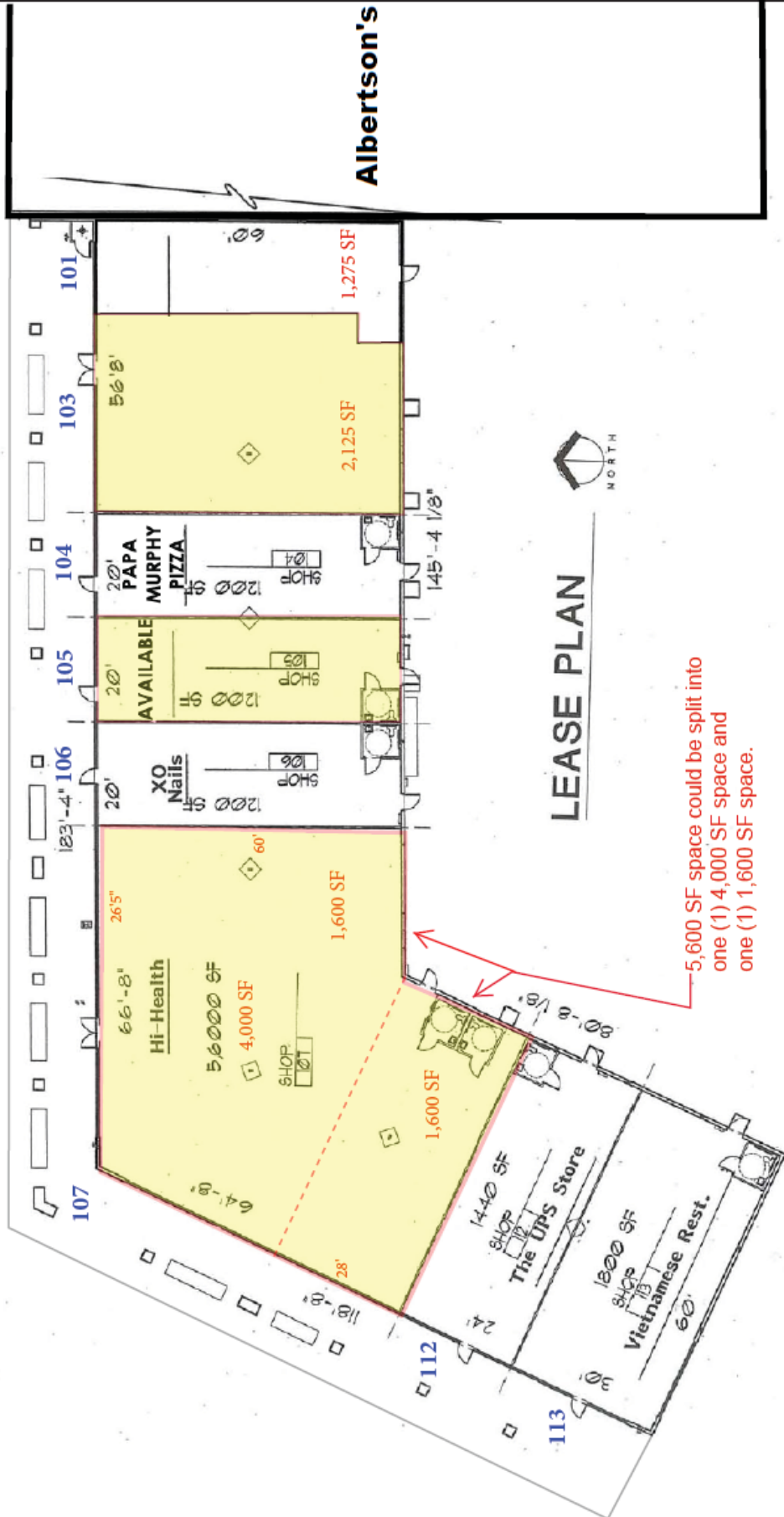

For Leasing Please Contact:

[www.azpre.com](http://www.azpre.com)





For Leasing Please Contact:

[www.azpre.com](http://www.azpre.com)

