



QUEENS
PLACE



QUEENS PLACE

Queens Place is a 221,000 square foot urban shopping mall in Queens, New York with an iconic, cylindrical design. Located on Queens Boulevard, the property is adjacent to the Queens Center Mall in the heart of bustling Elmhurst. An estimated 400,000 cars pass by Queens Place every

day. Queens Place contains a vibrant mix of retailers and restaurants including Target, Macy's Backstage, Best Buy, DSW and Outback Steakhouse. The pedestrian-friendly setting draws shoppers from throughout the entire greater Queens area.



NEIGHBORHOOD

The borough of Queens has a population of approximately 2.3 million. Elmhurst, where Queens Place is located, is one of the most culturally diverse neighborhoods in all of New York City, with over 100 nations represented by its inhabitants. It is considered the strongest retail hub in all of Queens.

- Conveniently located close to mass transit and the Long Island Expressway
- Prominent brand visibility for prospective retailers in strong retail area one block to Queens Center
- Growth area with over 41,000 residents within walking distance and 194,000 residents within one mile

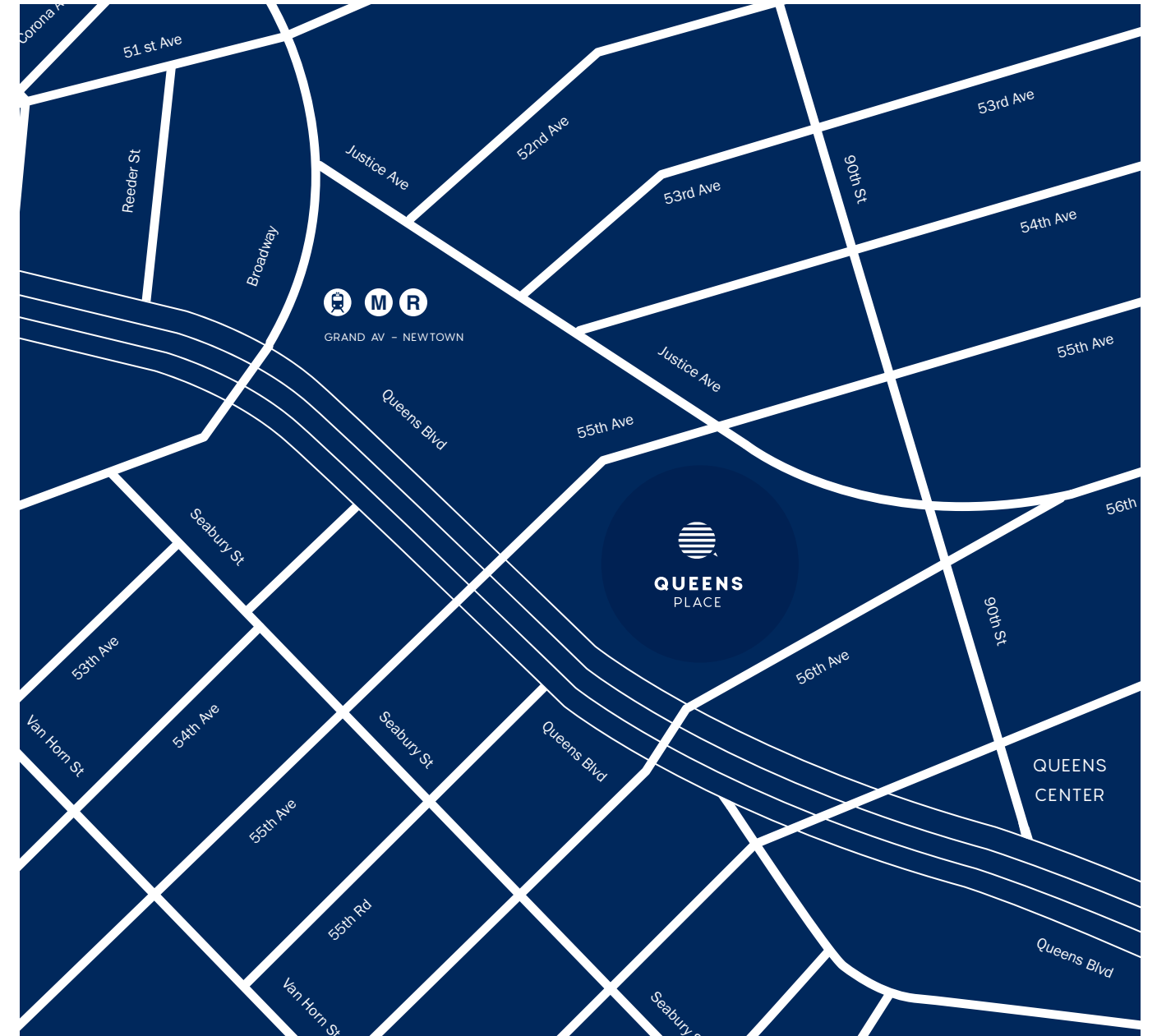

TRANSPORTATION

Queens Place is conveniently situated between the Grand Avenue – Newtown and Woodhaven Boulevard subway stations, which are served by the M and R trains. 468 on-site parking spaces are available in the attached garage, or shoppers can take the Q59 and Q60 buses. Vehicular access via the Long Island Expressway makes access to Queens Place even more convenient.

NEAREST TRAINS



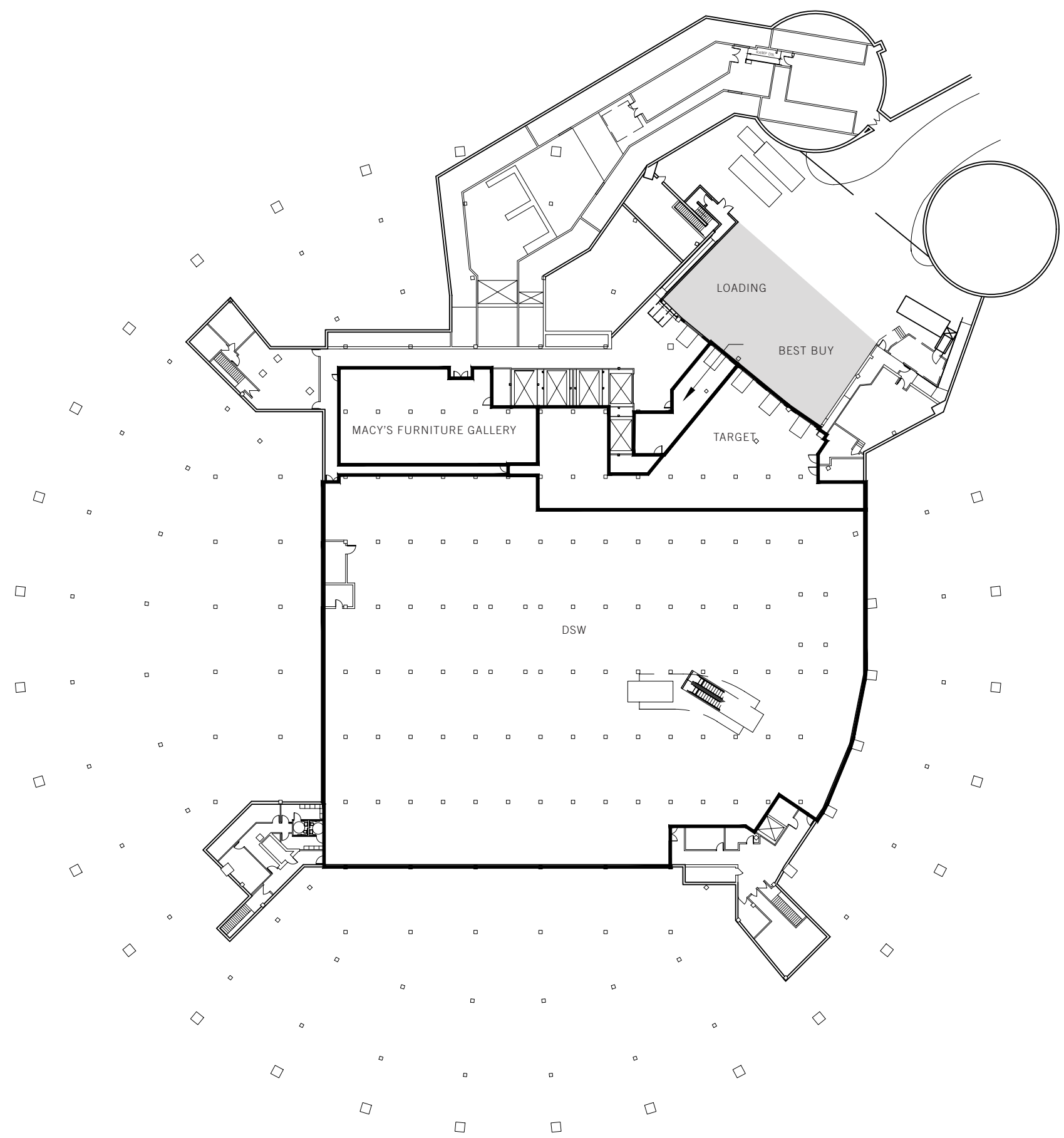

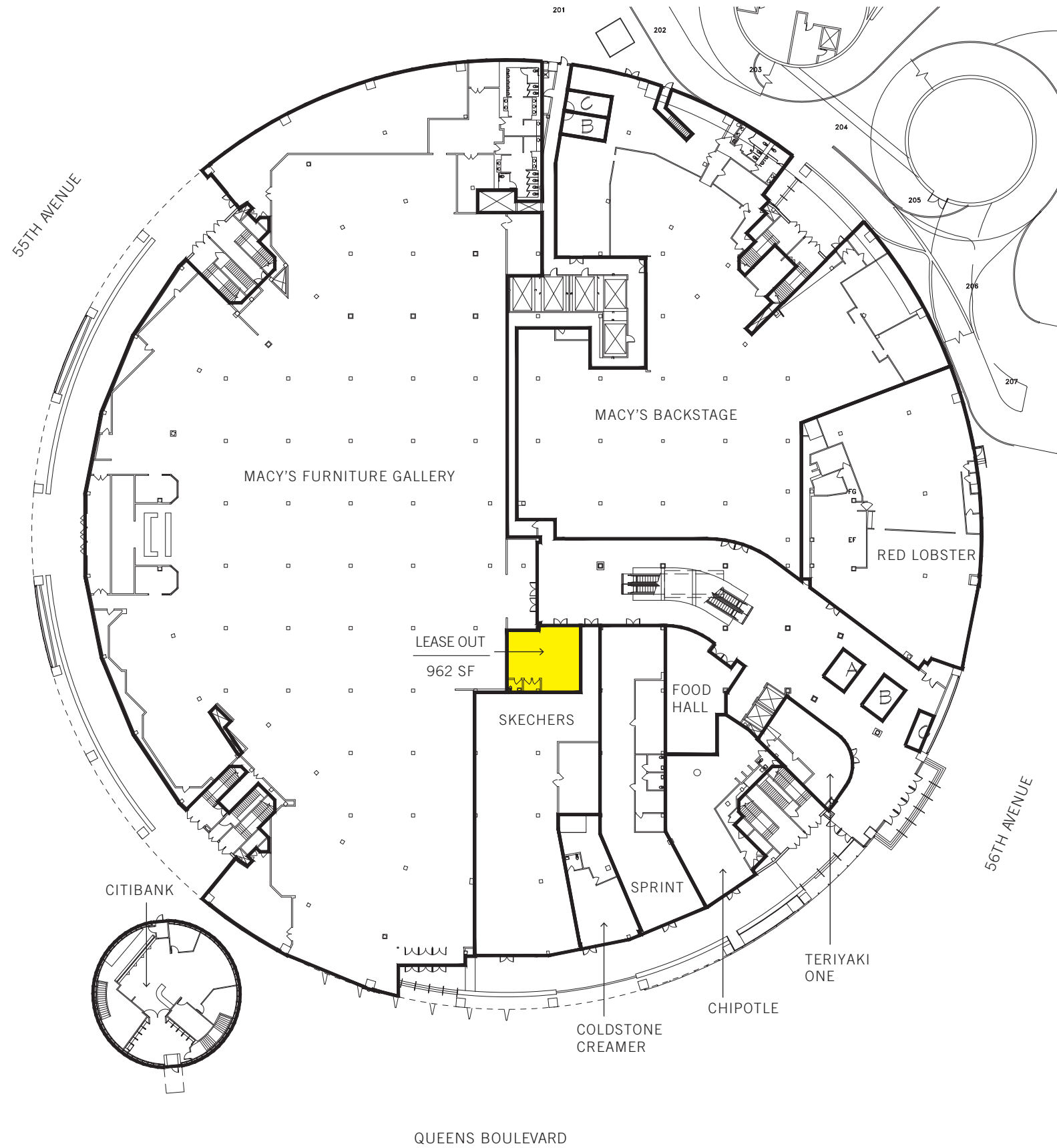

QUEENS PLACE

STREET LEVEL



NTS

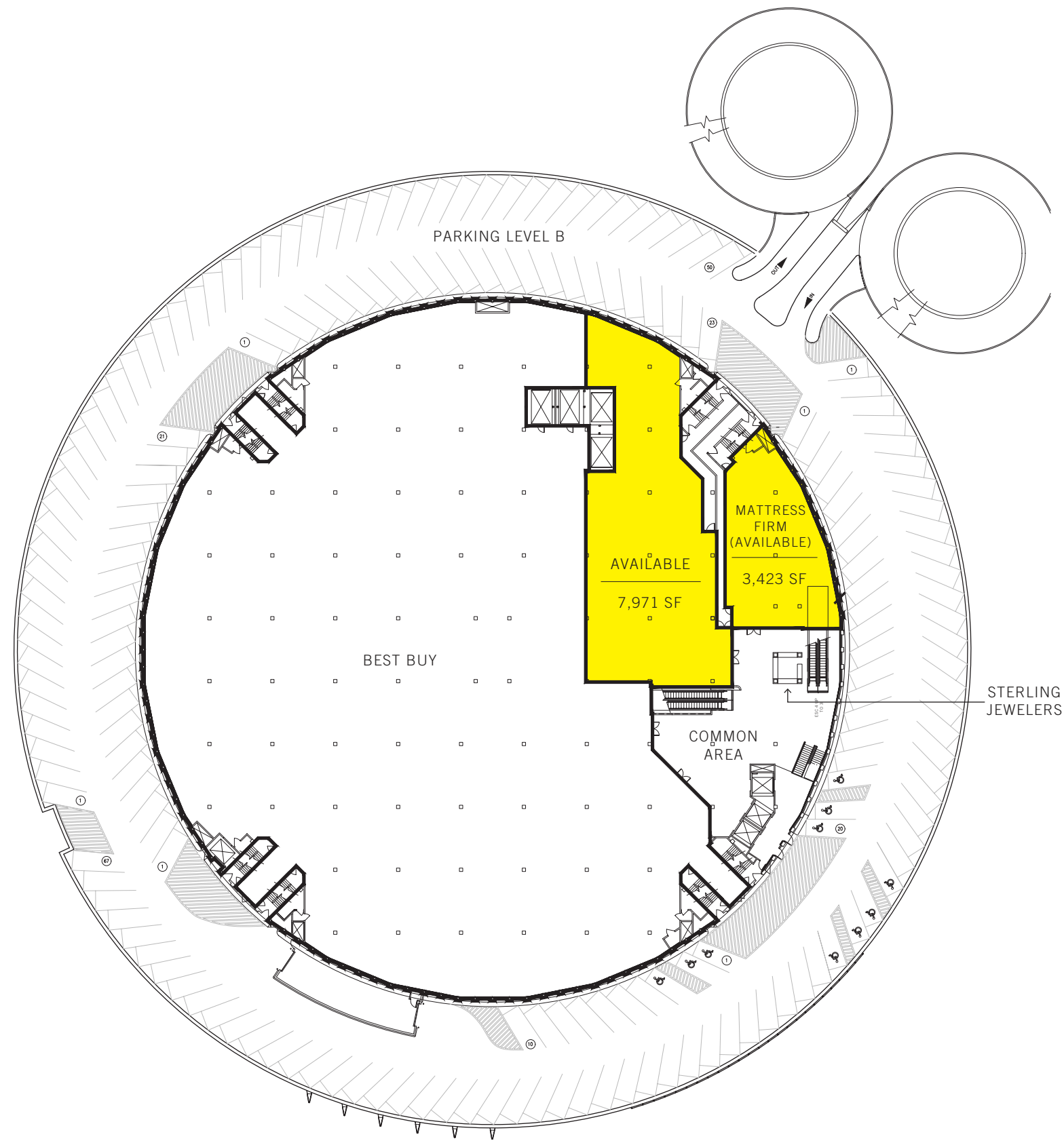



**CUSHMAN &
WAKEFIELD**

DIANA D. BOUTROSS
EXECUTIVE MANAGING DIRECTOR
212.841.5097
DIANA.BOUTROSS@CUSHWAKE.COM

ALAN SCHMERZLER
VICE CHAIRMAN
212.841.5930
ALAN.SCHMERZLER@CUSHWAKE.COM

IAN LERNER
SENIOR DIRECTOR
212.841.5948
IAN.LERNER@CUSHWAKE.COM

BRANDON L. SINGER
MANAGING DIRECTOR
212.841.7837
BRANDON.SINGER@CUSHWAKE.COM

A commission computed and earned in accordance with the rates and conditions of our agency agreement with our Principal, when received from our Principal, will be paid to the cooperating broker who consummates a lease which is unconditionally executed and delivered by and between lessor and lessee (a copy of the rates and conditions referred to above is available upon request). The depiction in the above photograph of any person, entity, sign, logo, or property (other than Cushman & Wakefield's client and the property offered by Cushman & Wakefield) is incidental only, and is not intended to connote any affiliation, connection, association, sponsorship, or approval by or between that which is incidentally depicted by Cushman & Wakefield or its client.