



OFFICE | WAREHOUSE SPACE FOR LEASE

# CRESCENT TEN

1306 LANGHAM CREEK | SUITE 312 | HOUSTON, TEXAS 77084

**CONTACT INFORMATION**

**CARTER THURMOND**

713.490.3784

[carter.thurmond@transwestern.com](mailto:carter.thurmond@transwestern.com)

**JUDE FILIPPONE**

713.270.3318

[jude.filippone@transwestern.com](mailto:jude.filippone@transwestern.com)



OFFICE | WAREHOUSE SPACE FOR LEASE

# CRESCENT TEN

1306 LANGHAM CREEK | SUITE 312 | HOUSTON, TEXAS 77084

**T** TRANSWESTERN®

1900 West Loop South  
Suite 1300  
Houston, Texas 77027



## AERIAL MAP

SUITE 312: 6,125 SF



### CONTACT INFORMATION

**CARTER THURMOND**

713.490.3784

carter.thurmond@transwestern.com

**JUDE FILIPPONE**

713.270.3318

jude.filippone@transwestern.com

The information provided herein was obtained from sources believed reliable; however, Transwestern makes no guarantees, warranties or representations as to the completeness or accuracy thereof. The presentation of this property is submitted subject to errors, omissions, change of price or conditions, prior sale or lease, or withdrawal without notice. Copyright © 2018 Transwestern.

# CRESCENT TEN

1306 LANGHAM CREEK | SUITE 312 | HOUSTON, TEXAS 77084

1900 West Loop South  
Suite 1300  
Houston, Texas 77027



## FLOOR PLAN

SUITE 312: 6,125 SF

A project of



### BUILDING SPECS

- Master-planned environment
- Strategically located in Houston's dynamic Energy Corridor
- Excellent accessibility
- I-10 Access and visibility
- Separate parking and loading areas
- 100% HVAC
- Strong institutional owners
- Strong corporate identity

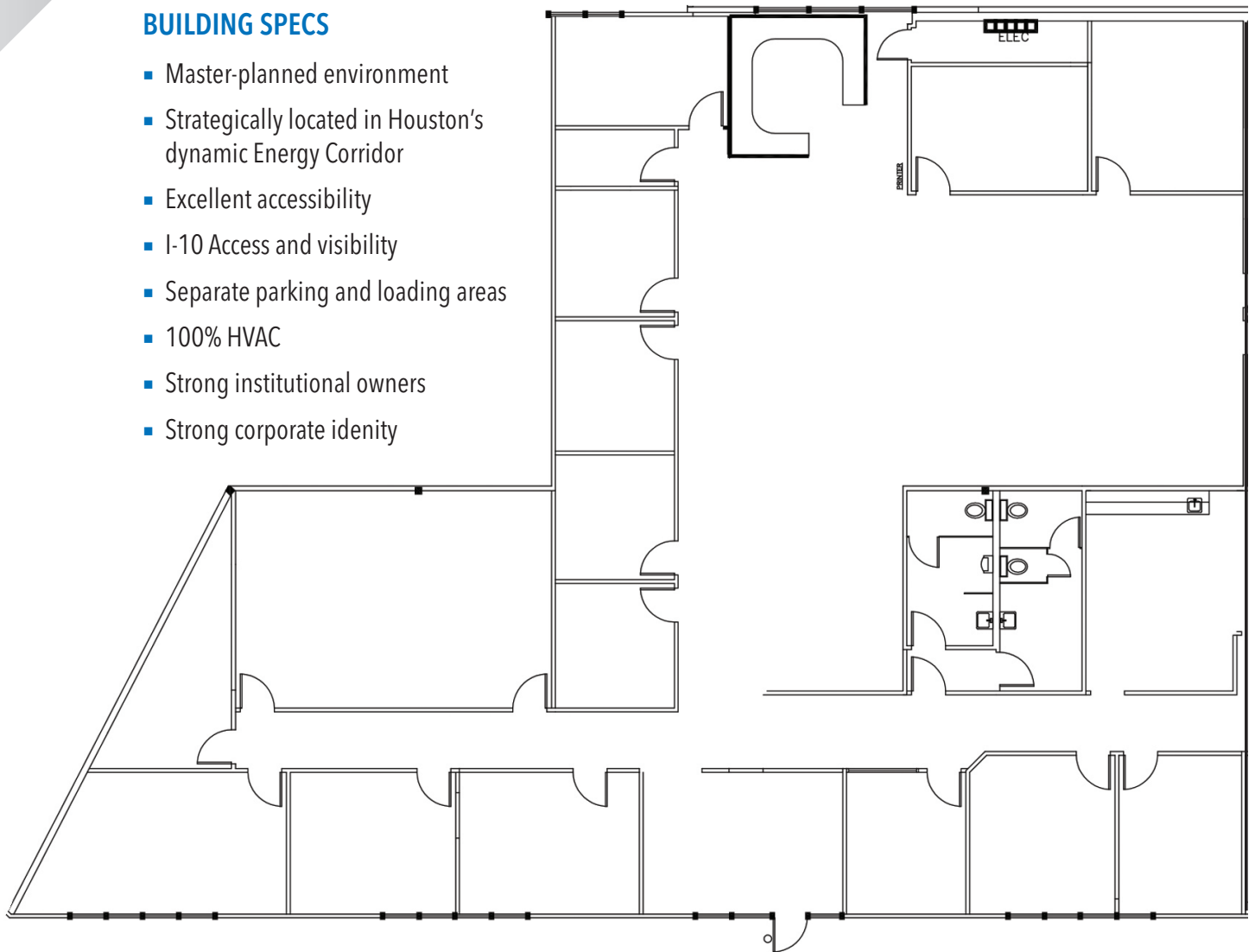

### CONTACT INFORMATION

**CARTER THURMOND**

713.490.3784

carter.thurmond@transwestern.com

**JUDE FILIPPONE**

713.270.3318

jude.filippone@transwestern.com

The information provided herein was obtained from sources believed reliable; however, Transwestern makes no guarantees, warranties or representations as to the completeness or accuracy thereof. The presentation of this property is submitted subject to errors, omissions, change of price or conditions, prior sale or lease, or withdrawal without notice. Copyright © 2018 Transwestern.