

## Park 277

5002 D Street NW  
Building A  
Auburn, WA

**137,333 SF total**

.....

Divisible

.....

2,500 SF office

.....

30' clear height

.....

25 dock-high doors

5 pit levelers

.....

3 grade-level doors

.....

Column spacing 35 x 48

.....

\$0.50/\$0.85 PSF, NNN  
\$0.157 NNN's (2017 est.)

.....

High image/identity park

.....

Excellent access off of SR-167

.....

Available now

.....



### Location



### Contact

**Chris Corr, SIOR**

206.248.7324

ccorr@kiddermathews.com

.....

**Matt Wood, SIOR**

206.248.7306

mwood@kiddermathews.com

.....

## Park 277

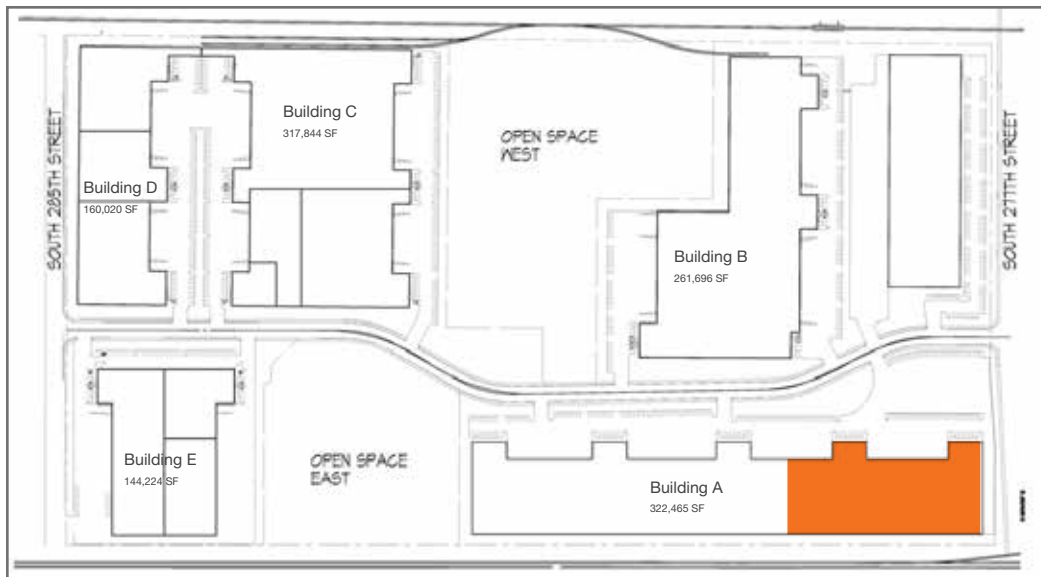
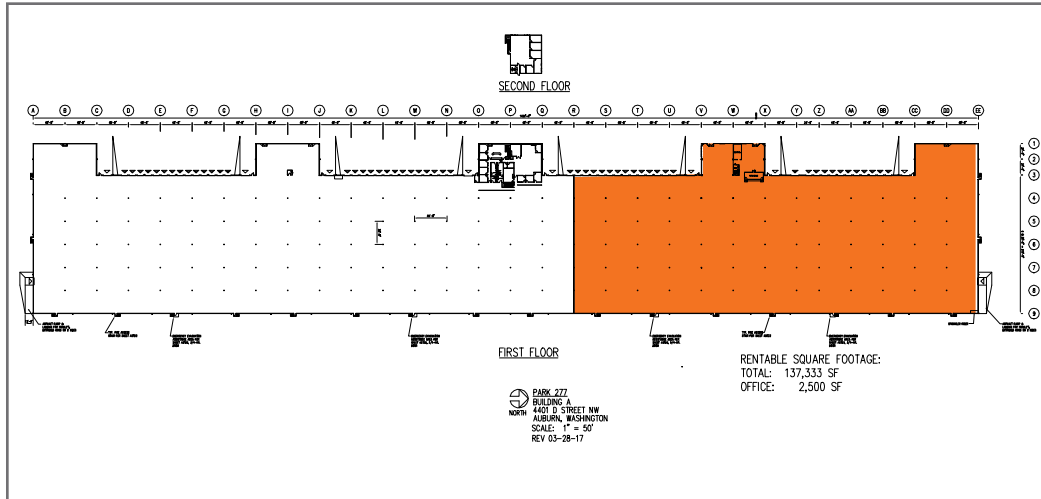

### Contact

**Chris Corr, SIOR**  
206.248.7324  
ccorr@kiddermathews.com

**Matt Wood, SIOR**  
206.248.7306  
mwood@kiddermathews.com