



21212 AVALON BLVD

CARSON, CA 90745 | FOR LEASE



PROPERTY FEATURES

AVAILABLE SF: 32,229 SF Buildings
on 119,009 SF Lot

APN: 7337-003-014

ZONING: CACA* Automotive

- Rare 405 Fwy Visible Property - 520,000 Cars Per Day Traveling North & South
- Eight (8) Service Bays
- 190 Parking Spaces
- 23,015 SF of Office
- Close to Major Amenities (South Bay Pavillion Mall and Future Outlet Mall)
- Former Auto Dealership, Repair, Service, Sales, Etc.
- 2 Year Lease Maximum

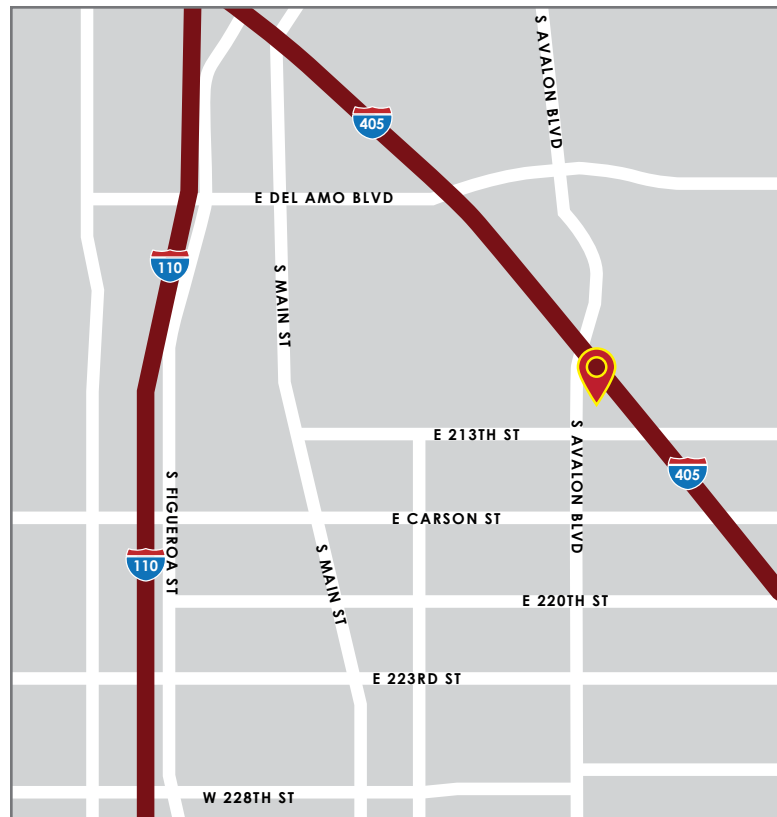

FOR MORE INFORMATION, PLEASE CONTACT:

YOUR LOCAL MARKET EXPERTS



Brandon Carrillo
Principal
BRE# 01745362
PH: 562.354.2510
E: bcarrillo@leelalb.com

Garrett Massaro
Principal
BRE# 01771471
PH: 562.354.2516
E: gmassaro@leelalb.com

Nate Ortega
Associate
BRE# 01989242
PH: 562.354.2531
E: nortega@leelalb.com



21212 AVALON BLVD

CARSON, CA 90745 | FOR LEASE

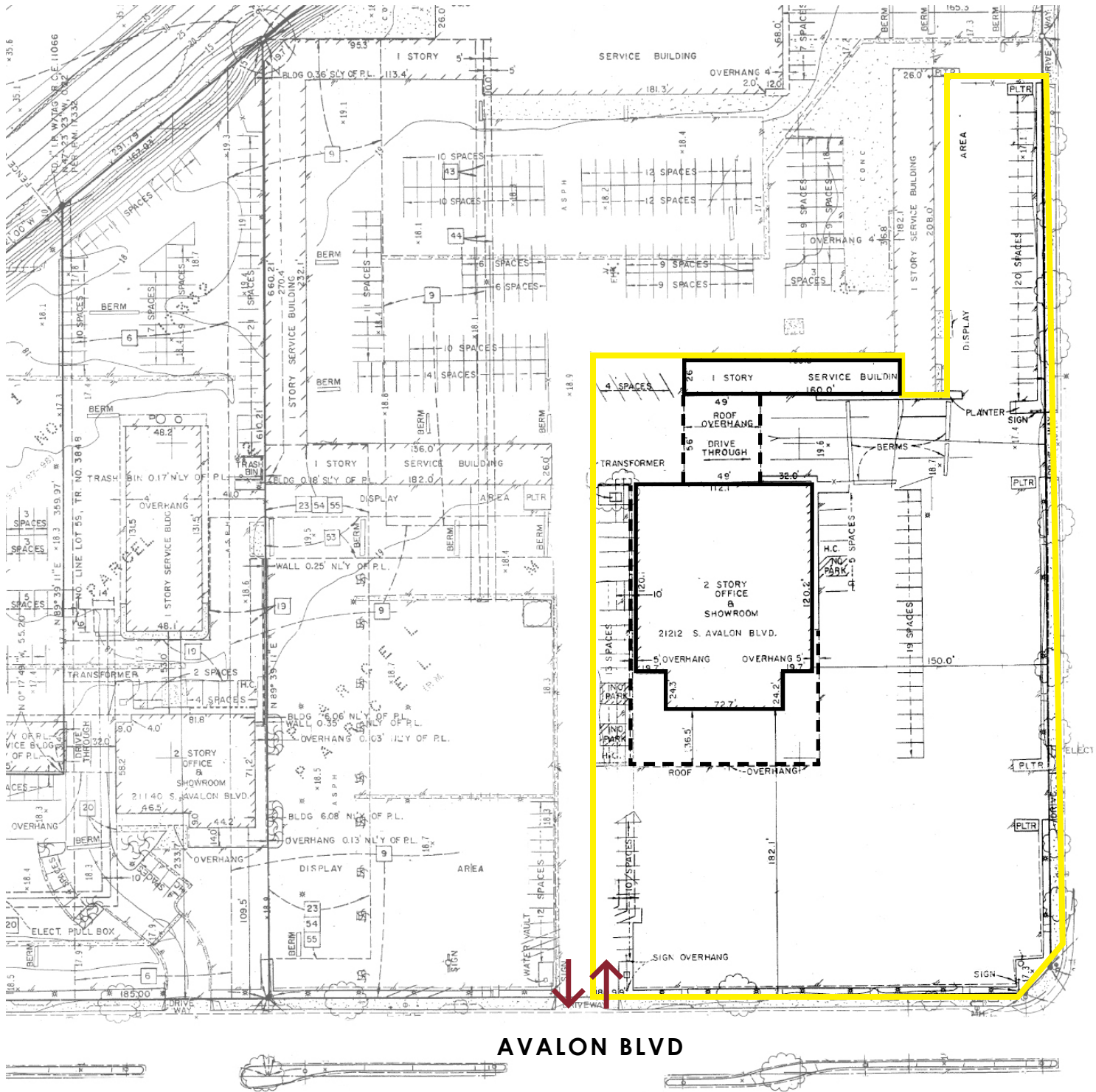

213TH STREET

AVALON BLVD

FOR MORE INFORMATION, PLEASE CONTACT:

YOUR LOCAL MARKET EXPERTS



Brandon Carrillo
Principal
BRE# 01745362
PH: 562.354.2510
E: bcarrillo@leelalb.com

Garrett Massaro
Principal
BRE# 01771471
PH: 562.354.2516
E: gmassaro@leelalb.com

Nate Ortega
Associate
BRE# 01989242
PH: 562.354.2531
E: nortega@leelalb.com



21212 AVALON BLVD

CARSON, CA 90745 | FOR LEASE



Copyright © Lee & Associates. All rights reserved. No part of this work may be reproduced or distributed without written permission of the copyright owner. The information contained in this report was gathered by Lee & Associates from sources believed to be reliable. Lee & Associates, however, makes no representation concerning the accuracy or completeness of such information and expressly disclaims any responsibility for any inaccuracy contained herein. 3.7.17

FOR MORE INFORMATION, PLEASE CONTACT:

YOUR LOCAL MARKET EXPERTS



Brandon Carrillo
Principal
BRE# 01745362
PH: 562.354.2510
E: bcarrillo@leelalb.com

Garrett Massaro
Principal
BRE# 01771471
PH: 562.354.2516
E: gmassaro@leelalb.com

Nate Ortega
Associate
BRE# 01989242
PH: 562.354.2531
E: nortega@leelalb.com