

±3,000 SF
INDUSTRIAL
FOR LEASE

SHORT-TERM
STORAGE
ACCEPTED

BUSS DUCT
AVAILABLE

2-TON CRANE
OVER DOCK
AREA



TRANSWESTERN

REAL ESTATE
SERVICES

7227 W. WILSON AVENUE

Harwood Heights, IL 60706



SPECIFICATIONS

- Building Size: ±28,658 SF
- Available Size: ±3,000 SF
- Ceiling Height: ±14'
- Loading: 1 Dock / 1 DID
- Drive in Doors: 2 (12' x 14')
- Construction: Masonry
- Year Built: 1957
- Power: 800A @ 120/240V
- Heating: Gas
- Sprinklers: Wet
- Lease Rate: \$8.25 PSF MG

AERIAL

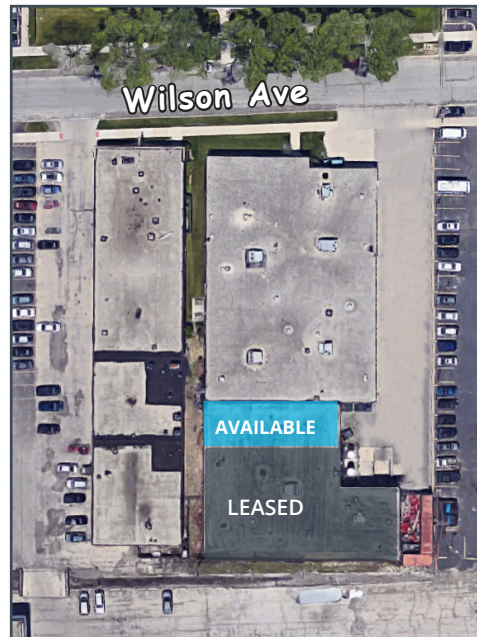

SPACE LAYOUT

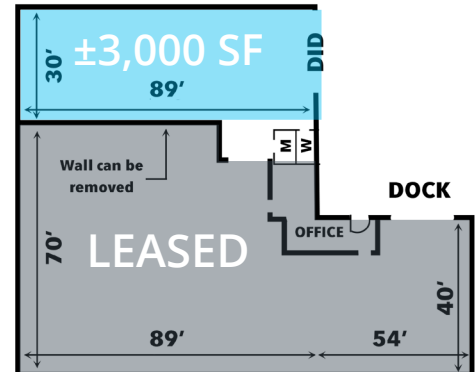

Contact Information:

Terri Alexander, SIOR
Senior Vice President
847.588.5641
terri.alexander@transwestern.com

The information provided herein was obtained from sources believed reliable; however, Transwestern makes no guarantees, warranties or representations as to the completeness of accuracy thereof. The presentation of this property is submitted subject to errors, omissions, change of price or conditions, prior to sale or lease, or withdrawal without notice. Copyright © 2020 Transwestern.