

1521 FIRST AVENUE S > SEATTLE, WASHINGTON 98134



> PREMIER RETAIL SPACE FOR LEASE

Retail space available for lease at Home Plate Center, located directly across the street from Safeco Field

| AVAILABILITIES | SIZE | COMMENTS |
|----------------|--------|---------------------------------------|
| Suite 102 | ±3,103 | Available now for Tenant improvements |



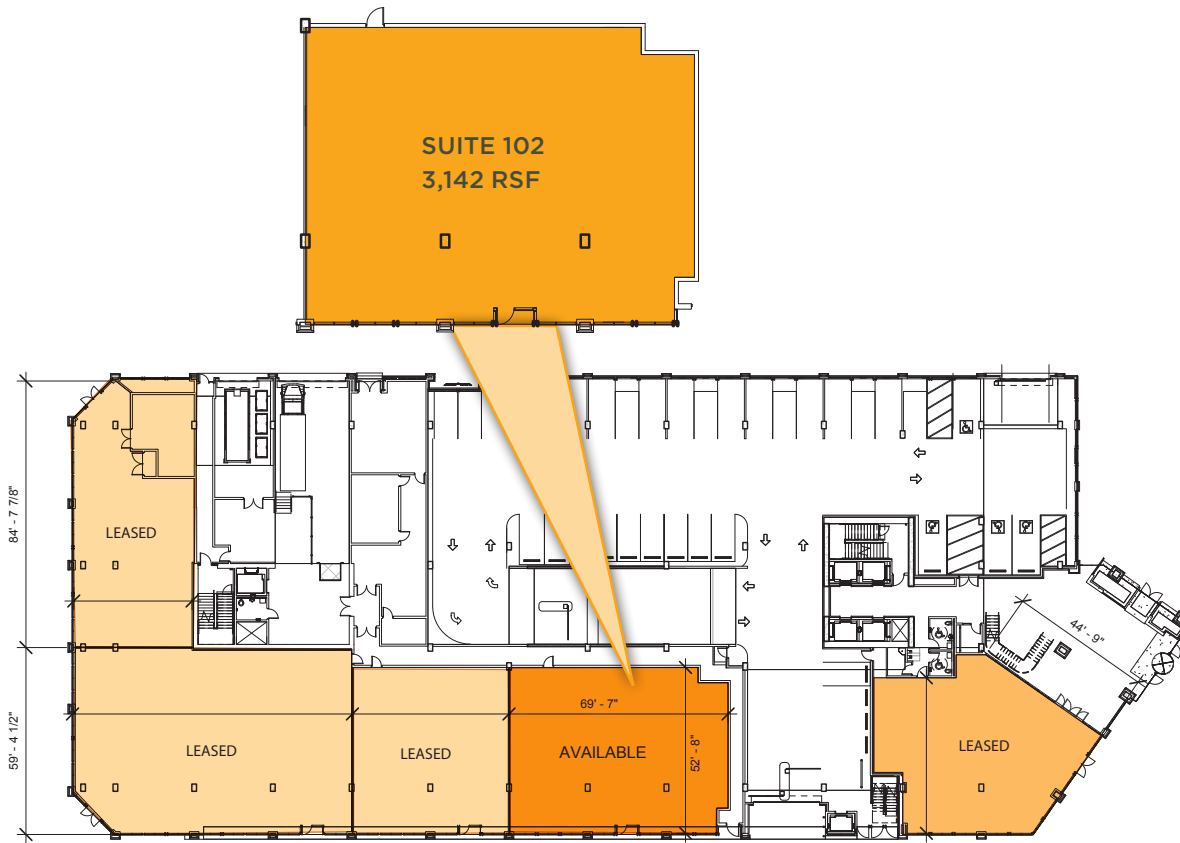

> HIGHLIGHTS

- Excellent access to I-5, I-90, Highway 99 and mass transit including light rail, ferries, and bus systems.
- Generous 500+ stall parking garage located beneath retail space.
- Parking validation program available for retail users.
- Home of King 5, Real Networks, Logic 20/20, Oculus & Seattle Metropolitan Credit Union.
- 1.6 million fans visit Safeco Field annually, home to the Seattle Mariners.
- 1.5 million fans visit CenturyLink Field, home to the Seattle Seahawks and Seattle Sounders.
- Built in customer base.
- ±521,176 SF of office space.

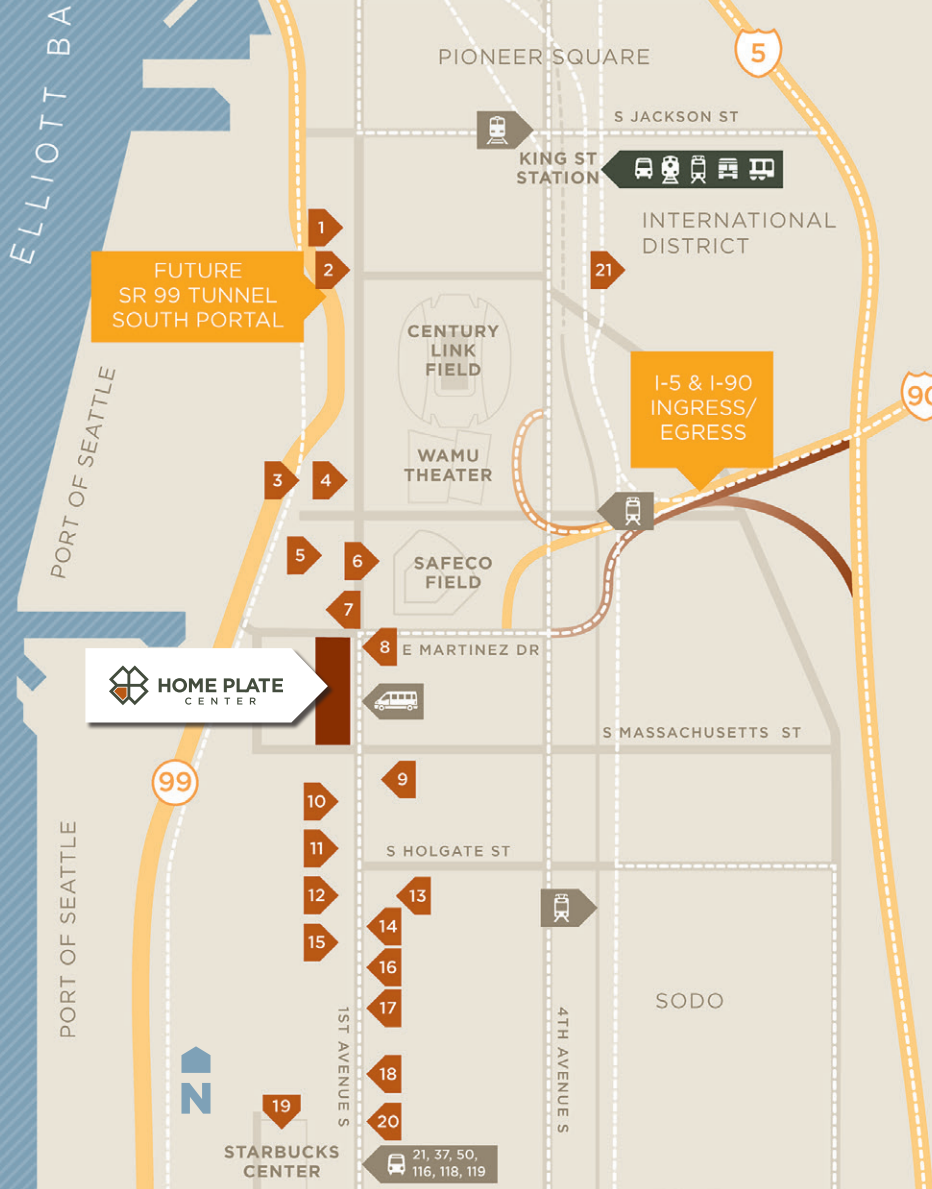

NEIGHBORHOOD AMENITIES

- 1 SLUGGERS SPORTS BAR & GRILL
- 2 ELYSIAN FIELDS
- 3 THE HAWKS NEST BAR & GRILL
- 4 SEATTLE TEAM SHOP
- 5 PYRAMID ALEHOUSE
- 6 BLAZING BAGELS
- 7 JIMMY'S ON FIRST
- 8 HENRY'S TAVERN
- 9 SHOWBOX SODO
- 10 HOOVERVILLE BAR
- 11 ZINNIA BISTRO
- 12 BLAZING BAGELS
- 13 KRISPY KREME
- 14 JIMMY JOHN'S
- 15 MACRINA BAKERY
- 16 MAC'S SMOKEHOUSE
- 17 STARBUCKS
- 18 PECOS PIT BARBEQUE
- 19 SODO KITCHEN
- 20 PHO CYCLO
- 21 UWAJIMAYA



HOME PLATE
CENTER

> For more information, please contact:

JEN POST
+1 206 292 6149
jen.post@cbre.com

SCOTTA ASHCRAFT
+1 206 292 6063
scotta.ashcraft@cbre.com

CBRE, Inc.
1420 5th Avenue, Suite 1700
Seattle, WA 98101

© 2018 CBRE, Inc. All rights reserved. This information has been obtained from sources believed reliable, but has not been verified for accuracy or completeness. You should conduct a careful, independent investigation of the property and verify all information. Any reliance on this information is solely at your own risk. jm010219

