



Kitchen and Dining



Dining Area

THE
BOARDWALK
COMPANY
31640 U.S. Hwy. 19 N, Suite 1
Palm Harbor, Florida 34684



**AVAILABLE
FOR SALE
OR LEASE**

**Retail/Restaurant
Bldg. at 1,575 SF (mol)**



**6200 Haines Rd. N.
St. Petersburg, FL 33702**

THE
BOARDWALK
COMPANY

www.BoardwalkCompany.com
LICENSED REAL ESTATE BROKER

AVAILABLE

THE BOARDWALK COMPANY

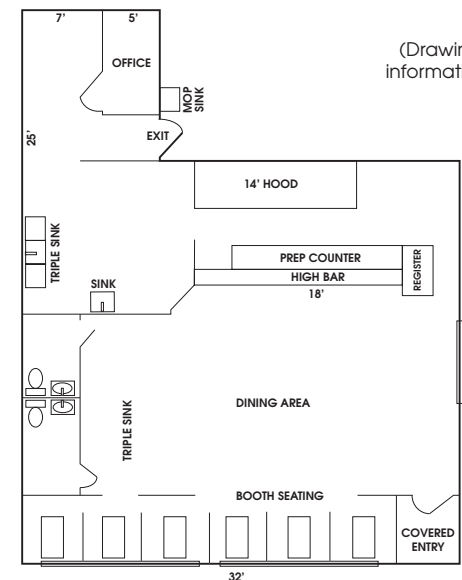

(Drawing not to scale, for informational purposes only)

Demographics:	1 Mile	3 Mile	5 Mile
2013 Population	14,137	119,175	268,693
2013 Median Age	45.1	43.7	43.4
2013 Median HH Income	\$29,756	\$38,804	\$40,381
2013 Average HH Income	\$39,146	\$50,644	\$55,462

Sale Price ONLY \$199,000
Or Lease Opportunity Available

FREESTANDING RETAIL – RESTAURANT BLDG.

Property #4145

- Located at 6200 Haines Rd. N., St. Petersburg, FL 33602
- Freestanding 1,575 SF Building (mol), Zoned C-2
- Situated on the Northwest corner at the signalized intersection of 62nd Ave. and Haines Rd.
- Some restaurant equipment in place and included, Booth Seating, External Walk In Cooler & Freezer, 14 Ft. Hood / Ansul Suppression System, Triple Wash Sink, etc.
- Excellent building exposure along with Pylon Signage at signalized intersection.
- IMMEDIATE OCCUPANCY AVAILABLE!!!!

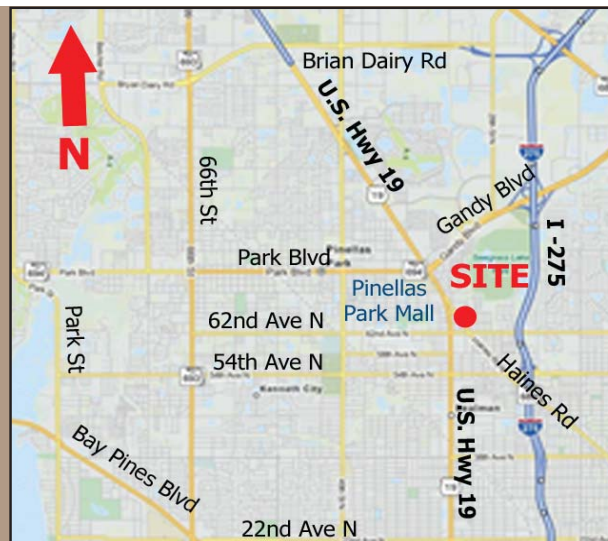

For more information, contact

John Quattrocci
Broker

office: 727.784.1007
fax: 727.784.1008
cell: 727.460.2201

jquattrocci@boardwalkcompany.com

31640 U.S. Hwy. 19 N, Suite 1
Palm Harbor, Florida 34684

www.BoardwalkCompany.com
LICENSED REAL ESTATE BROKER

This information contained herein was collected from sources deemed to be reliable. The Boardwalk Company it's Agents and Seller make no warranties or representations of any manner as to the accuracy, and the same is subject to misstatements of fact, errors or omissions, prior sale, change of price, terms, withdrawal from market without notice or other modifications. Buyer, tenants and/or all other parties shall verify all information independently.