

# Superstition Springs Regional Mall

**FOR LEASE**

NWC Power Rd & US-60  
Mesa, Arizona

## Property & Location Highlights

- Super regional shopping center (over 1,040,000 SF)
- Anchored by Dillard's, JCPenney, Macy's, TJMaxx and Ross Dress for Less
- Convenient access to/from US-60
- Two box spaces available, and select interior mall suites



**Gabe Ortega**

+1 602 852 3415 • gabe.ortega@naihorizon.com

**Shelby Tworek**

+1 602 667 1797 • shelby.tworek@naihorizon.com

**Chris Gerow**

+1 602 852 3413 • chris.gerow@naihorizon.com

**NAI**Horizon

2944 N 44th St, Suite 200, Phoenix, Arizona

+1 602 955 4000

[naihorizon.com](http://naihorizon.com)

# Superstition Springs Regional Mall

## Site Plan

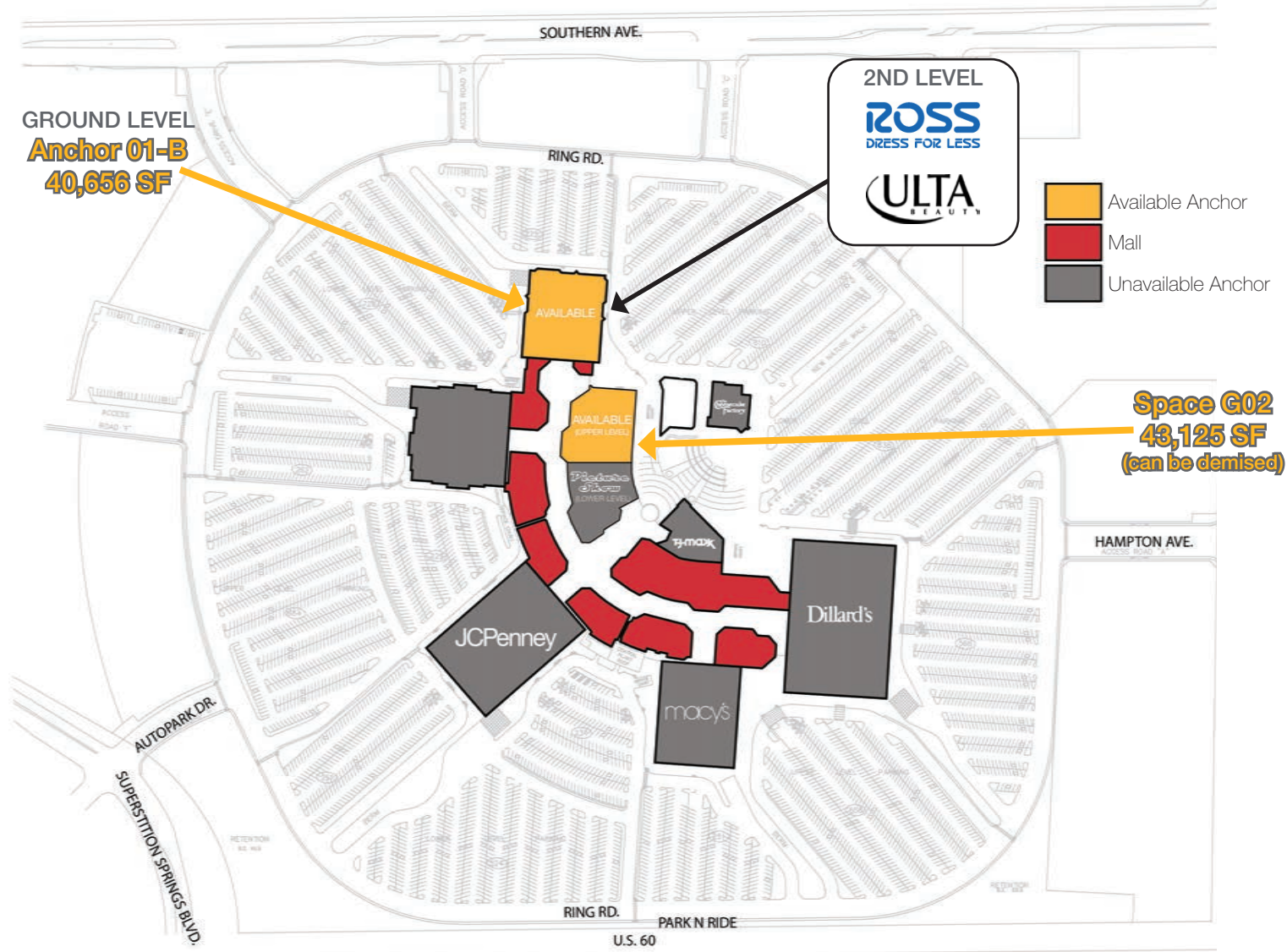

**Gabe Ortega**  
+1 602 852 3415 • gabe.ortega@naihorizon.com

**Shelby Tworek**  
+1 602 667 1797 • shelby.tworek@naihorizon.com

**Chris Gerow**  
+1 602 852 3413 • chris.gerow@naihorizon.com

# Superstition Springs Regional Mall

## Anchor 01-B Lease Plan

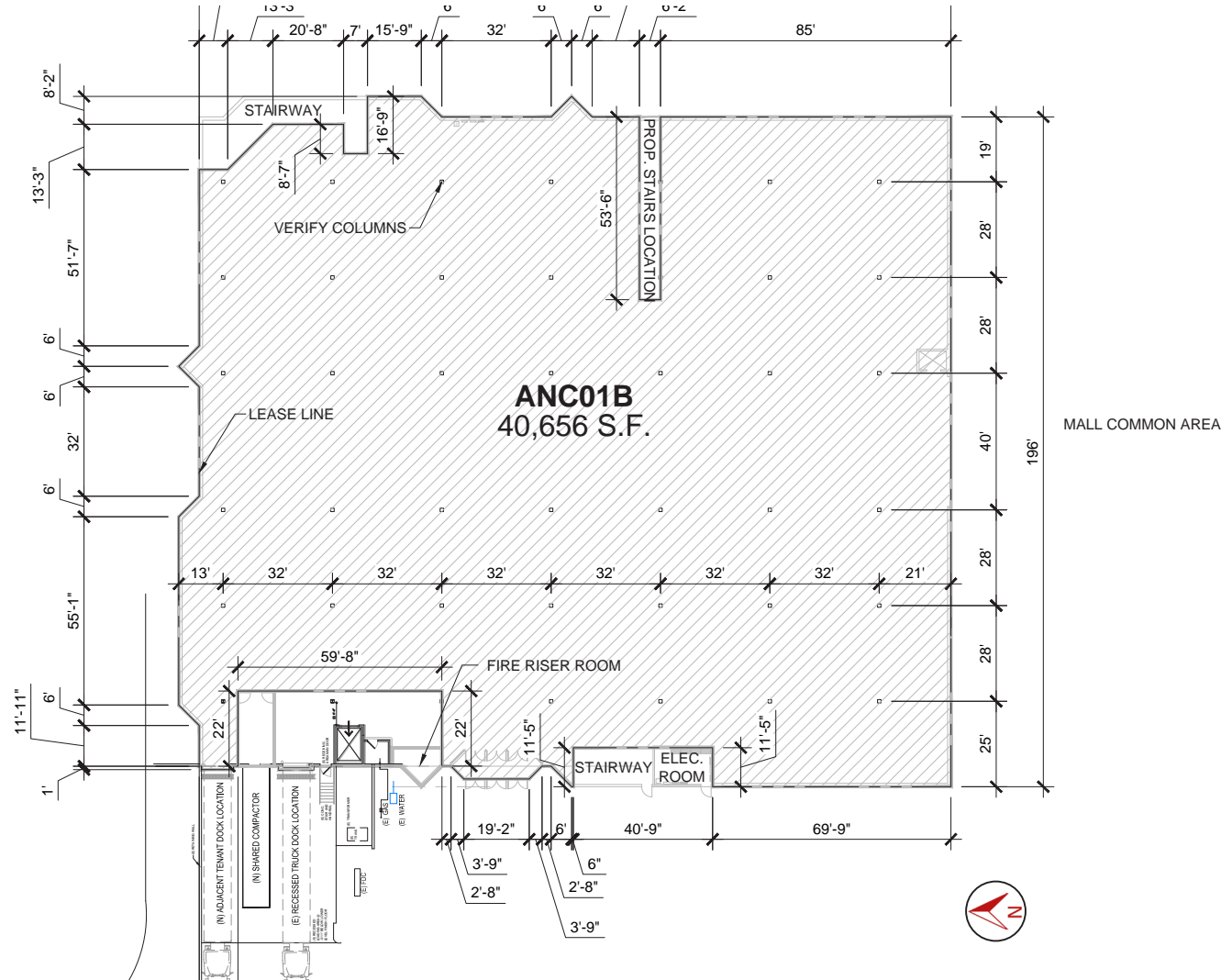

**Gabe Ortega**

+1 602 852 3415 • gabe.ortega@naihorizon.com

**Shelby Tworek**

+1 602 667 1797 • shelby.tworek@naihorizon.com

**Chris Gerow**

+1 602 852 3413 • chris.gerow@naihorizon.com

**NAI**Horizon



# Superstition Springs Regional Mall

## Space G02 Lease Plan



**Gabe Ortega**

+1 602 852 3415 • gabe.ortega@naihorizon.com

**Shelby Tworek**

+1 602 667 1797 • shelby.tworek@naihorizon.com

**Chris Gerow**

+1 602 852 3413 • chris.gerow@naihorizon.com

**NAI**Horizon



# Superstition Springs Regional Mall

## Property Aerial

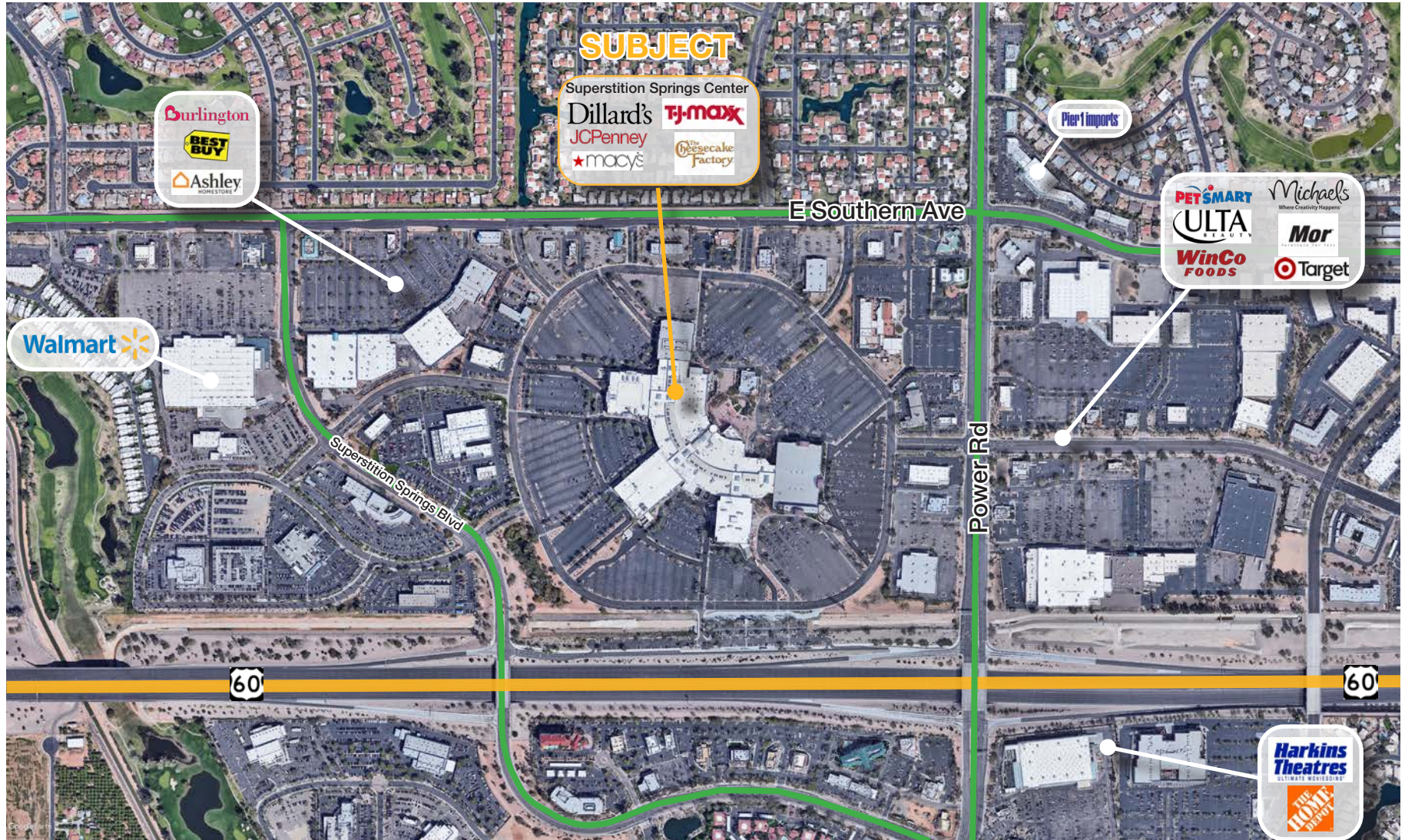

Gabe Ortega  
+1 602 852 3415 • gabe.ortega@naihorizon.com

Shelby Tworek  
+1 602 667 1797 • shelby.tworek@naihorizon.com

Chris Gerow  
+1 602 852 3413 • chris.gerow@naihorizon.com



# Superstition Springs Regional Mall

## Demographics / Highlights

With a population of nearly

# 500,000

Mesa is the 2nd Largest City in the Phoenix MSA

Mesa School District is the Largest District in Arizona with

# 65,000

students (18,500 high school, 44,800 K-8 and 2,000 Pre-K)

Mesa Named

# Best Big City

in the Southwest  
(Money Magazine 2016)

Over

# 220,200

cars drive by Superstition Springs Center daily



**Gabe Ortega**

+1 602 852 3415 • gabe.ortega@naihorizon.com

**Shelby Tworek**

+1 602 667 1797 • shelby.tworek@naihorizon.com

**Chris Gerow**

+1 602 852 3413 • chris.gerow@naihorizon.com

**NAI**Horizon