

FOR LEASE

39,050 SF FLEX SPACE



2100 CORPORATE DRIVE, ADDISON, IL 60101



PROPERTY SUMMARY

LOCATION	Located off of I-355, south of Army Trail Road off Swift Road	SITE SIZE	3.70 acres
BUILDING SIZE	39,050 Total SF	CLEAR HEIGHT	16' 6"
	Office Area A: 5,565 SF	LOADING	Rear and side loading
	Office Area B: 24,044 SF		
	Office Area C: 9,441 SF	TRUCK DOCKS	2 Drive-in doors
ZONING	M-4, Planned Office/Research/Industrial	AIR CONDITIONED	100%
PARKING RATIO	3.46/1,000 (135 spaces)	POWER	Unit 1: 400A, 3P4W, 208/120V
ASKING LEASE RATE	\$10.75 PSF, NNN		Unit 2: 1600A, 3P4W, 480V
			Unit 2: Two 1200-1600A, 3P4W, 120/208V
			Unit 3: 1200A, 3P4W, 208/120V



CONTACT US

DAN BESSEY

First Vice President
+1 847 706 4921
dan.bessey@cbre.com



2100 CORPORATE DRIVE, ADDISON, IL 60101

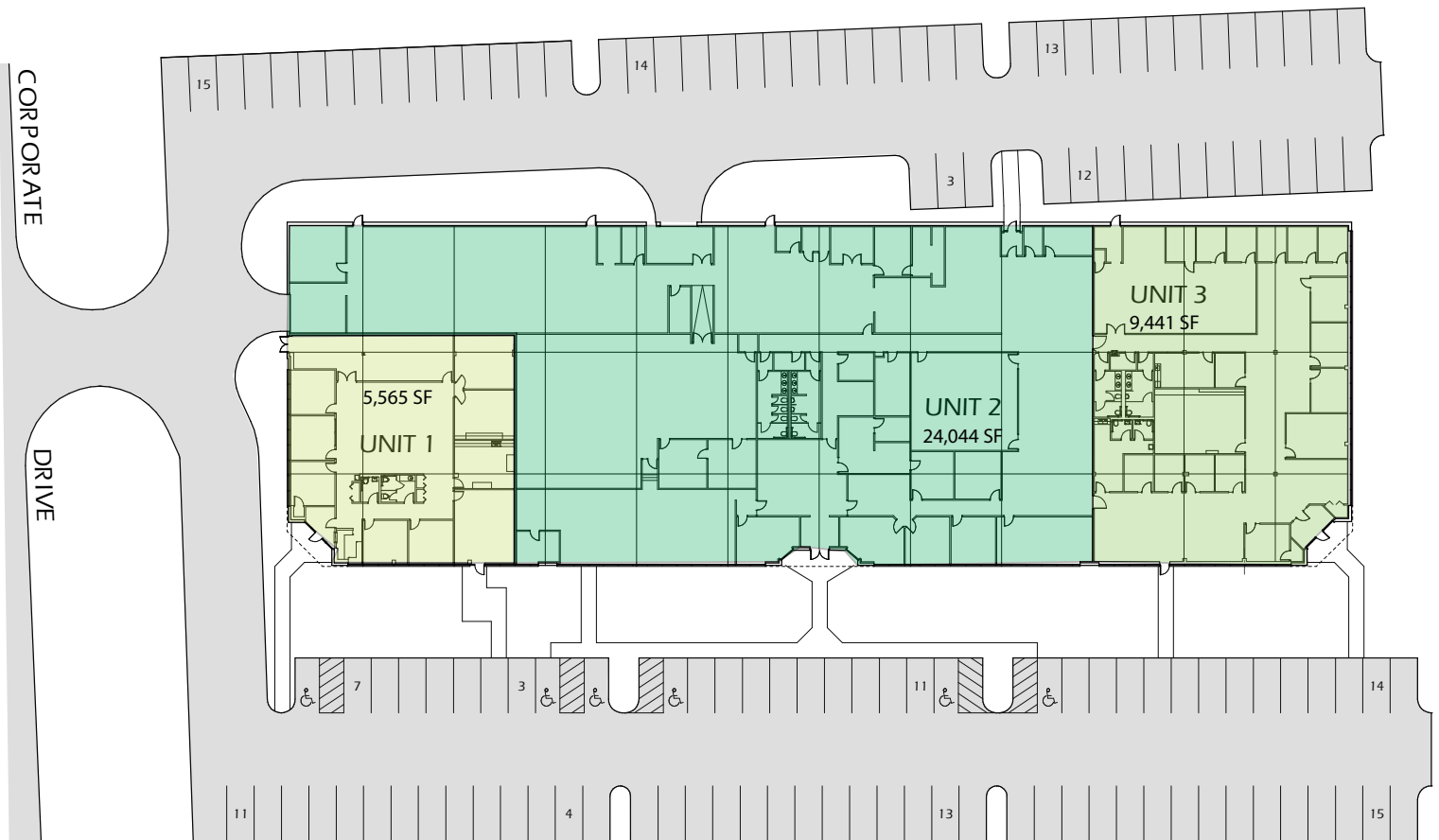

2100 CORPORATE DRIVE, ADDISON, IL 60101



2100 CORPORATE DRIVE, ADDISON, IL 60101

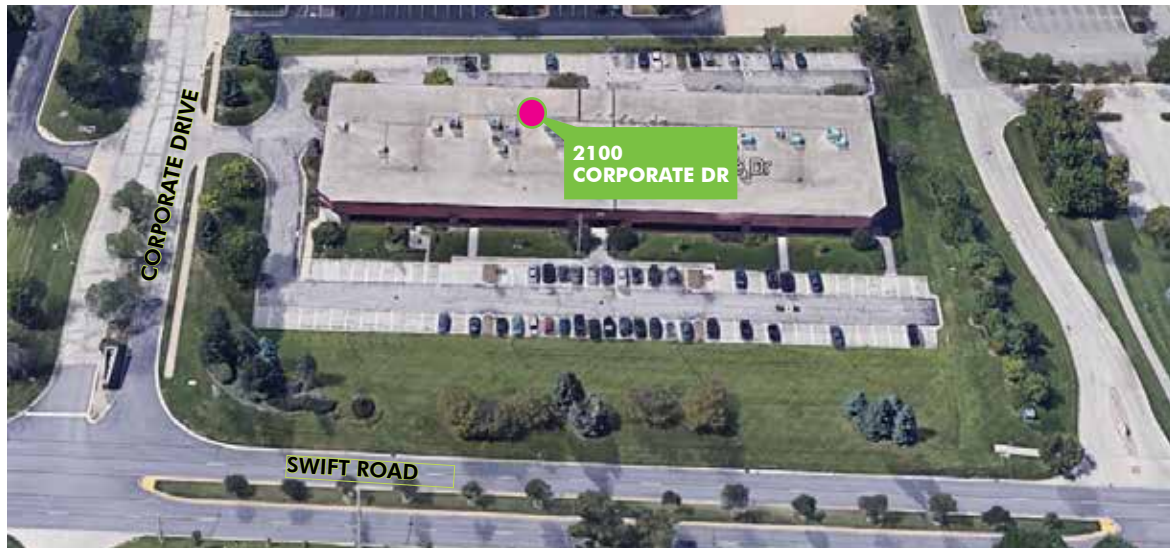
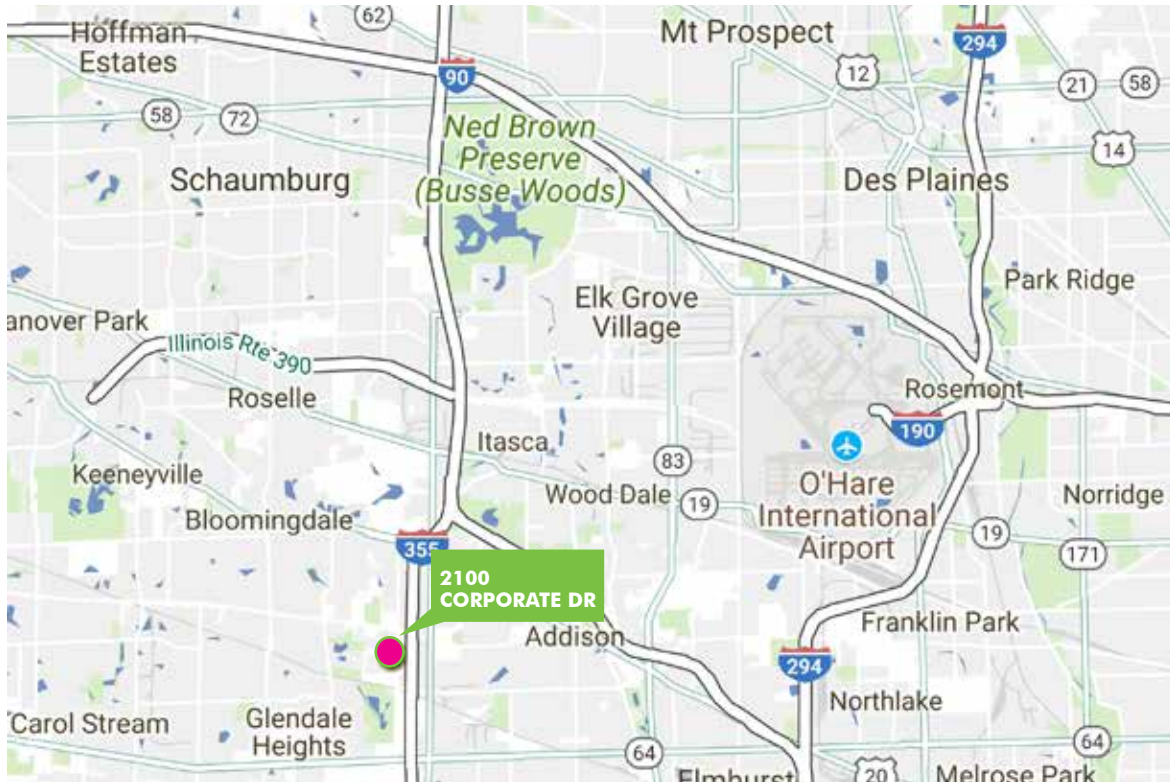

© 2020 CBRE, Inc. All rights reserved. This information has been obtained from sources believed reliable, but has not been verified for accuracy or completeness. You should conduct a careful, independent investigation of the property and verify all information. Any reliance on this information is solely at your own risk. CBRE and the CBRE logo are service marks of CBRE, Inc. All other marks displayed on this document are the property of their respective owners, and the use of such logos does not imply any affiliation with or endorsement of CBRE. Photos herein are the property of their respective owners. Use of these images without the express written consent of the owner is prohibited.