



CAPITOL  
EQUITIES

# DEVELOPMENT SITE

View all of our properties at [capitolequities.com](http://capitolequities.com)

## 3440 North Broadway | Grove City, Ohio 43123



AVAILABLE ACREAGE:	1.704 acres
LAND LEASE RATE:	\$20,000 per acre
PURCHASE PRICE:	\$350,000 per acre
BUILD TO SUIT OPTION:	Up to 13,500 sf city approved Will consider build to suit
ZONING:	Commercial Development
LOCATION:	On Broadway, between Parlin & Addison Next to McDonald's and Burger King and other high profile restaurant/retailers
DAILY TRAFFIC COUNT:	25,590 vehicles per day
KEY DEMOGRAPHICS: (5 mile radius)	Population: 162,779 Households: 62,673 Avg. HH Income \$40,356 Employees: 86,321

### LIKE TO GET MORE INFO?

We'd love to hear from you.

#### Todd Kemmerer

[tkemmerer@capitolequities.com](mailto:tkemmerer@capitolequities.com)

P: 614.760.5660 x 126

#### J.R. Kern

[jrkern@capitolequities.com](mailto:jrkern@capitolequities.com)

P: 614.760.5660 x 124

#### Capitol Equities Realty

P: 614.760.5660

F: 614.798.0015

580 N. Fourth Street, Suite 120  
Columbus, Ohio 43215

[capitolequities.com](http://capitolequities.com)

The information contained herein was furnished by sources believed to be reliable, but it is not guaranteed, warranted or represented by Capitol Equities. The presentation of this property is submitted subject to errors, omissions, change of price or condition prior to sale or lease, or withdrawn without notice.



CAPITOL  
EQUITIES

# DEVELOPMENT SITE

3440 North Broadway | Grove City, Ohio 43123



## CURRENT SITE PLAN

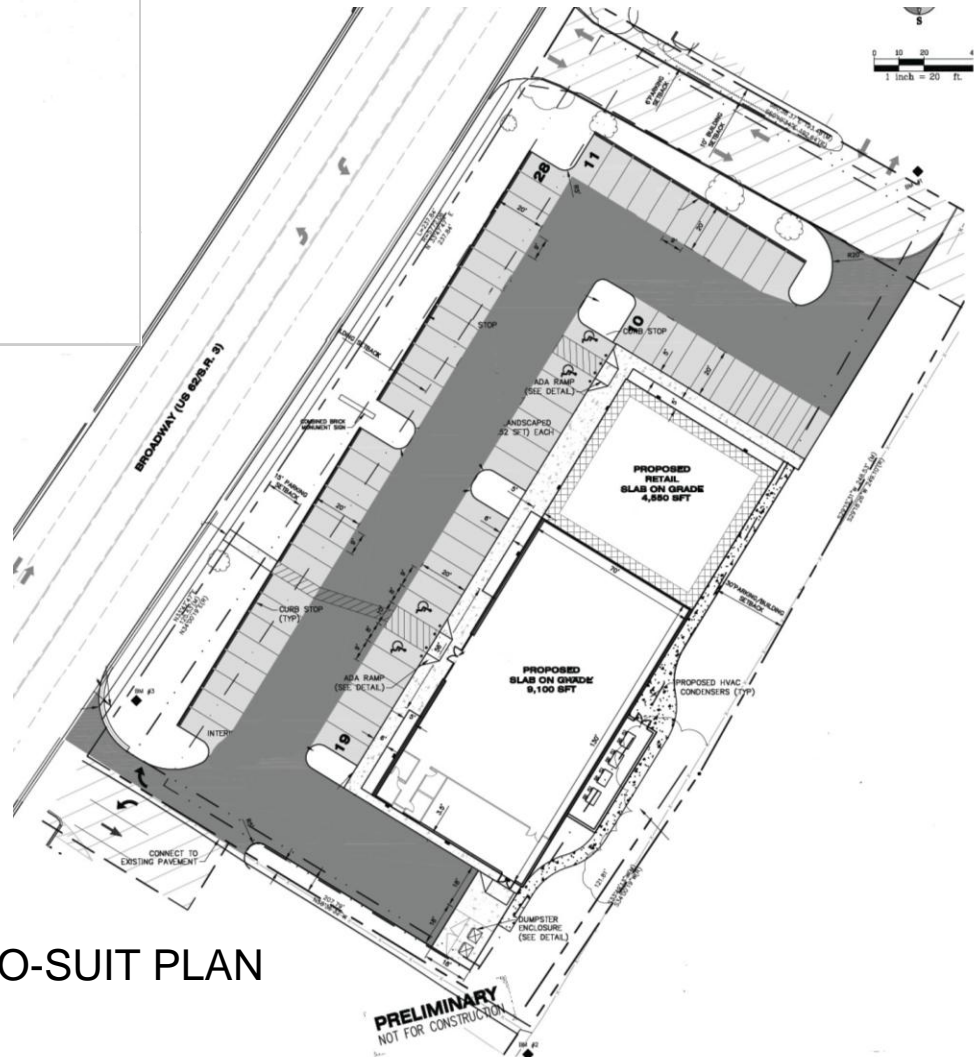

## SAMPLE BUILD-TO-SUIT PLAN