

For Lease

±15,988 Sq. Ft. | HIGH IMAGE

1250 N. Hancock Street, Anaheim, CA 92807



Property Details

- ±15,988 Total Square Feet
- ±3,000 Square Feet of Office
- 24' Warehouse Clear Height
- One (1) Ground Level Loading Door
- One (1) Truckwell
- 400 Amps of Power
- Part of a Larger High Image Corporate Headquarters
- ±2,784 Sq. Ft. of Mezzanine *(Included in Square Footage)*
- Fire Sprinklers
- Low Anaheim Utility Rates

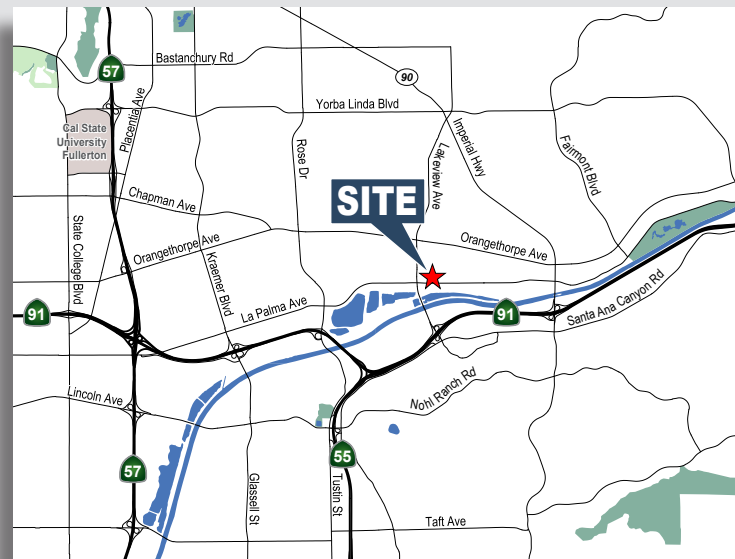

Robert J. Socci
Executive Vice President
714.935.2314
rsocci@voitco.com
Lic. #00936016

Hayden H. Socci, CCIM
Vice President
714.935.2379
hsocci@voitco.com
Lic. #0105038

Voit
REAL ESTATE SERVICES

±15,988 Square Feet

High Image Corporate Headquarters

1250 N. Hancock Street, Anaheim, CA 92807

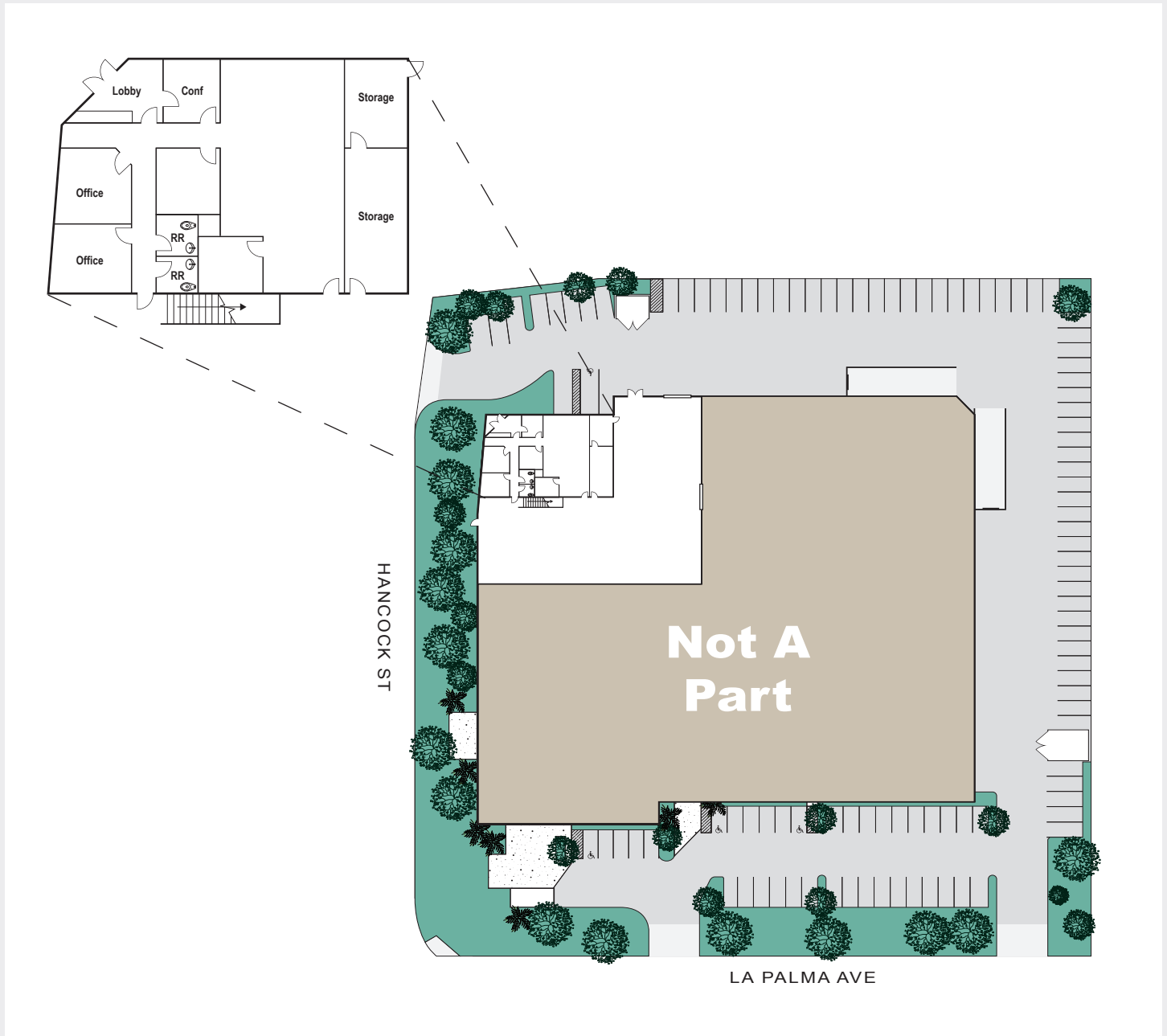

Robert J. Socci
Executive Vice President
714.935.2314
rsocci@voitco.com
Lic. #00936016

Hayden H. Socci, CCIM
Vice President
714.935.2379
hsocci@voitco.com
Lic. #0105038

2400 E. Katella Ave., Suite 750, Anaheim, CA 92806
714.978.7880 • 714.978.9431 Fax • Lic #01333376 | www.voitco.com

The information contained herein has been obtained from sources we deem reliable. While we have no reason to doubt its accuracy, we do not guarantee it.
©2015 Voit Real Estate Services, Inc. All Rights Reserved. Real People. Real Solutions.® is a registered trademark of Voit Real Estate Services.

Voit
REAL ESTATE SERVICES