

FOR SUBLEASE

# PLUG & PLAY CALL CENTER

910

WEST CARVER ROAD

Tempe, AZ 85284

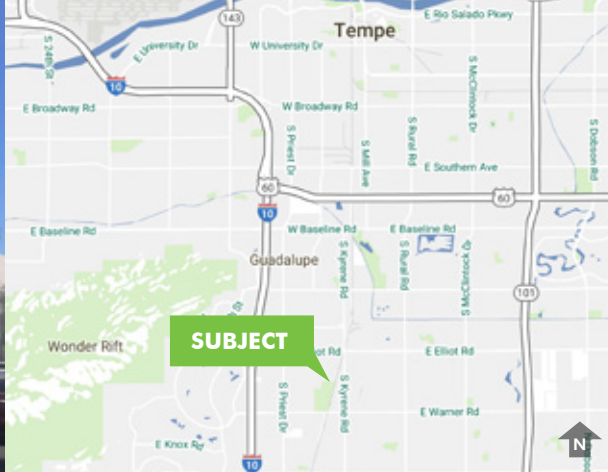

NOT TO SCALE



## PROPERTY OVERVIEW

<b>SPACE AVAILABLE</b>	±30,000 RSF Available April 1 <sup>st</sup> , 2017 ±30,000 RSF Additional space available ±60,000 RSF TOTAL
<b>PARKING</b>	7:1,000
<b>SUBLEASE RATE</b>	\$15.50/SF, NNN
<b>SUBLEASE TERM</b>	Expires December 31, 2019
<b>WORKSTATION COUNT</b>	FIRST FLOOR: ±318 Production Workstations (4' x 6') and 11 Manager Workstations (6' x 8') SECOND FLOOR: ±304 Production Workstations (4' x 6') and 24 Manager Workstations (6' x 8')
<b>TRAINING ROOMS</b>	6 (23 seats per room)
<b>CEILING HEIGHT</b>	±10'6"
<b>GENERATOR SPECS</b>	Kholer 1,000 kw
<b>UNIVERSAL POWER SUPPLY ("UPS"):</b>	75KVA

ALL MEASUREMENTS ARE APPROXIMATE



## CONTACT US

**JAMIE SWIRTZ**

+1 602 735 5630

jaime.swirtz@cbre.com

**MICHAEL CONNER**

+1 602 735 5537

michael.conner@cbre.com

[www.cbre.com/phoenix](http://www.cbre.com/phoenix)

**CBRE**

# FOR LEASE PLUG & PLAY CALL CENTER

910  
WEST CARVER ROAD  
Tempe, AZ 85284



## FLOOR PLANS

FIRST FLOOR



SECOND FLOOR



NOT TO SCALE  
MEASUREMENTS ARE APPROX.

# FOR LEASE PLUG & PLAY CALL CENTER

910  
WEST CARVER ROAD  
Tempe, AZ 85284



## PROPERTY PHOTOS

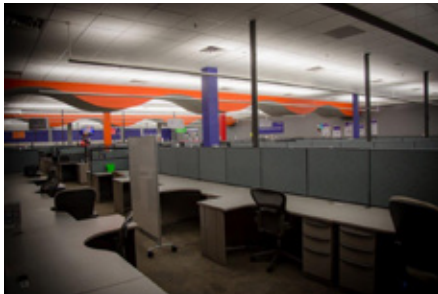
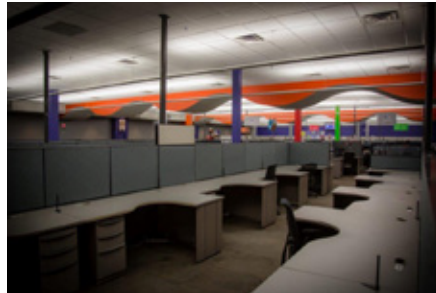
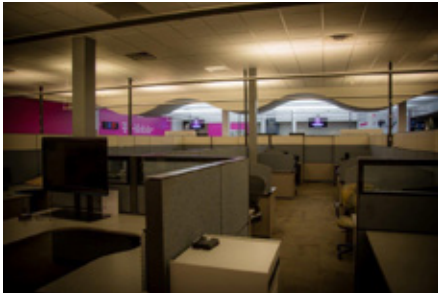

## CONTACT US

**JAMIE SWIRTZ**

+1 602 735 5630

[jaimе.swirtz@cbre.com](mailto:jaimе.swirtz@cbre.com)

**MICHAEL CONNER**

+1 602 735 5537

[michael.conner@cbre.com](mailto:michael.conner@cbre.com)

© 2017 CBRE, Inc. All rights reserved. This information has been obtained from sources believed reliable, but has not been verified for accuracy or completeness. You should conduct a careful, independent investigation of the property and verify all information. Any reliance on this information is solely at your own risk. CBRE and the CBRE logo are service marks of CBRE, Inc. and/or its affiliated or related companies in the United States and other countries. All other marks displayed on this document are the property of their respective owners. Photos herein are the property of their respective owners and use of these images without the express written consent of the owner is prohibited.

[www.cbre.com/phoenix](http://www.cbre.com/phoenix)

**CBRE**