

ONE GRAND CENTRAL PLACE

— 60 EAST 42ND STREET —

Grand Block Central Location

Contact us to learn more

Artist's Rendering

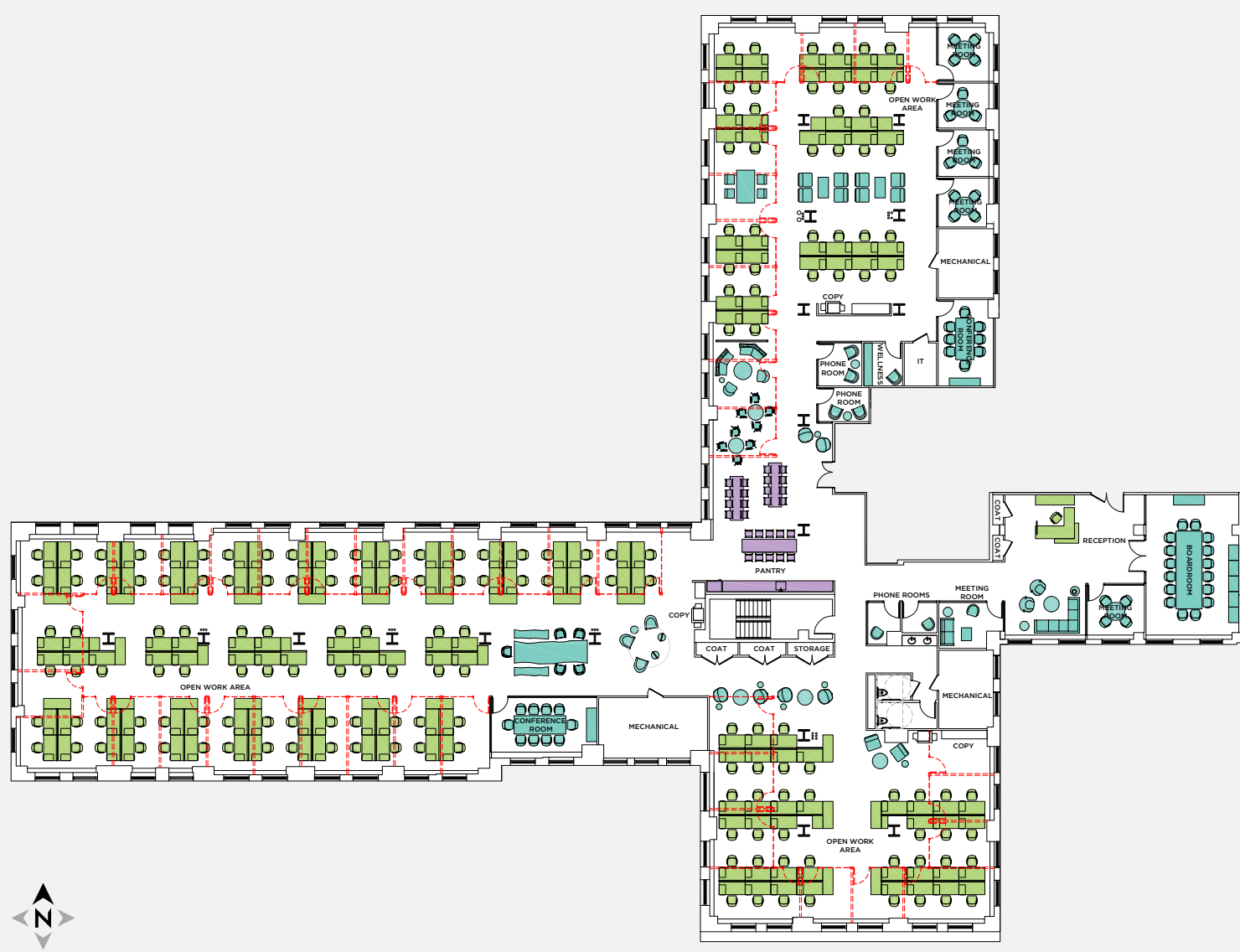

SUITE 1620 — 25,687 SQ.FT.

OPTIONAL OFFICES

9 conference/meeting rooms, 168 workstations

24/7 tenant-controlled A/C

Contact us to learn more



Tenants include Allianz, GLG, JP Morgan Chase, ServiceNow, Robertson Foundation, 3i and iCapital Network



Three in-building dining options

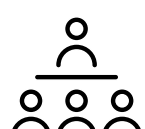

In-building visitor center and new tenant-only conference center

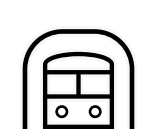

In-building access to Grand Central Terminal and 5 subway lines **4 5 6 7 S** **MTA** Metro-North Railroad



Wired Certified Platinum

Thank you for the opportunity to compete for your business.

EMPIRE STATE
REALTY TRUST

ESRT
LISTED
NYSE
REBNY

Julie M. Christiano 212-697-0696 • jchristiano@empirestaterealtytrust.com

Leslie Nadel 212-850-2616 • lnadel@empirestaterealtytrust.com



William G. Cohen 212-372-2233 • wcohen@ngkf.com

Brittany Silver 212-372-2219 • bsilver@ngkf.com

Jamie Jacobs 212-372-2487 • jjacobs@ngkf.com



onegcp.com • 100% Commission on lease signing

Procuring broker shall only be entitled to a commission, calculated in accordance with the rates approved by our principal only if such procuring broker executes a brokerage agreement acceptable to us and our principal and the conditions as set forth in the brokerage agreement are fully and unconditionally satisfied. Although all information furnished regarding property for sale, rental, or financing is from sources deemed reliable, such information has not been verified and no express representation is made nor is any to be implied as to the accuracy thereof and it is submitted subject to errors, omissions, change of price, rental or other conditions, prior sale, lease or financing, or withdrawal without notice and to any special conditions imposed by our principal.