

# BLUE ASH COMMONS

4150 Hunt Road  
Blue Ash, OH 45236

## FOR LEASE

1,600- 14,000 SF Available

### HIGHLIGHTS

- Small Shop Space Available for Lease 1,600 SF - 14,000 SF
- Strategically located in the heart of Blue Ash on Hunt Rd and Plainfield Rd (21,657 VPD) in a desirable retail market
- Join anchor tenants Kroger, Kohl's, Big Lots, and across the street from Target
- Other tenants in the area include Pet Supplies Plus, GNC, Great Clips, McDonalds and Dunkin' Donuts
- Located within 5 minutes of University of Cincinnati Blue Ash Campus: 4,780 students
- Several access points off Hunt Rd and Plainfield Rd

### TRAFFIC COUNTS

- 53,501 VPD on Ronald Reagan Cross County Highway
- 21,657 VPD north on Plainfield Road

### DEMOGRAPHICS

2020 Estimates	1 miles	3 miles	5 miles
Population	9,495	68,260	160,649
Households	4,222	30,788	72,529
Average HH Income	\$104,809	\$100,936	\$99,614
Daytime Employees	4,009	76,310	167,378

### CONTACT: 513-784-1106

Jason Gibson [jgibson@anchor-associates.com](mailto:jgibson@anchor-associates.com)  
Amy Holter [aholter@anchor-associates.com](mailto:aholter@anchor-associates.com)

Anchor  
ASSOCIATES



## ANCHOR ASSOCIATES

3825 Edwards Road  
Suite 630  
Cincinnati, OH 45209

513-784-1106

[www.anchor-associates.com](http://www.anchor-associates.com)

A MEMBER OF  
**CHAINLINKS**  
RETAIL ADVISORS



# BLUE ASH COMMONS

4150 Hunt Road  
Blue Ash, OH 45236



The information herein is not guaranteed. Although obtained from reliable sources, it is subject to errors, omissions and withdrawal from the market without notice.



# BLUE ASH COMMONS

4150 Hunt Road  
Blue Ash, OH 45236



# BLUE ASH COMMONS

4150 Hunt Road

Blue Ash, OH 45236

**Anchor**  
ASSOCIATES

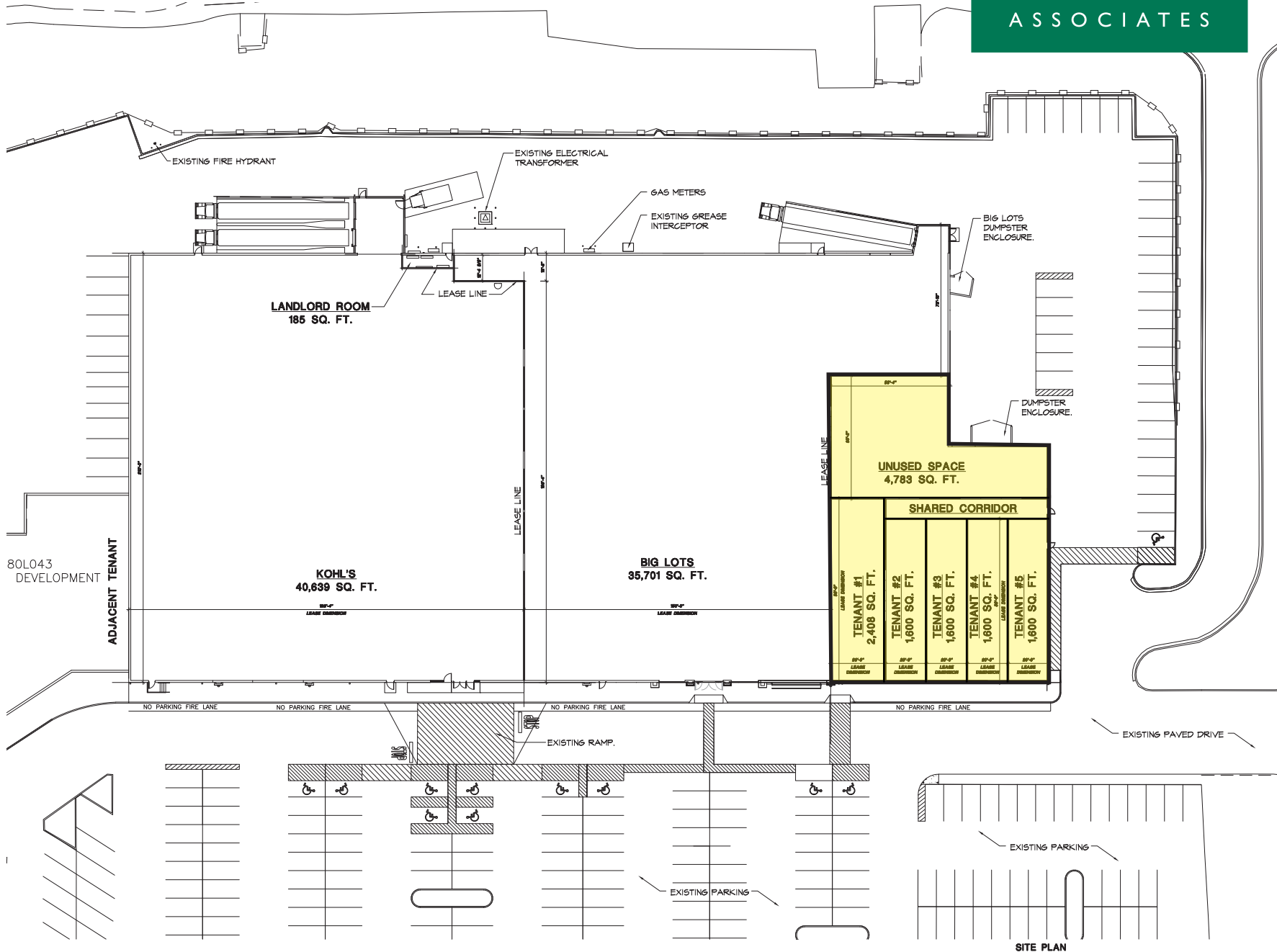

NO WARRANTIES ARE MADE BY ARCHITECTS FOR THE ACCURACY OF THE INFORMATION CONTAINED HEREIN. THE ARCHITECTS SHALL NOT BE RESPONSIBLE FOR THE DESIGN OF ANY SYSTEMS OR EQUIPMENT NOT SPECIFICALLY IDENTIFIED IN THE CONTRACT DOCUMENTS. THE ARCHITECTS SHALL NOT BE RESPONSIBLE FOR THE DESIGN OF ANY SYSTEMS OR EQUIPMENT NOT SPECIFICALLY IDENTIFIED IN THE CONTRACT DOCUMENTS.

Date: 04-10-18  
Issu: L01

Drawn By:  
Project No.:

80L043  
DEVELOPMENT

ADJACENT TENANT

NO PARKING FIRE LANE

EXISTING RAMP

EXISTING PAVED DRIVE

EXISTING PARKING

EXISTING PARKING

SITE PLAN

**BLUE ASH**  
FORMER K-MART

**HERSCH ARCHITECTS**  
1130 S R F 01  
2001 DENY ROAD  
CLEVELAND, OH  
TEL: (216) 2  
FAX: (216) 1  
www.herscharchitects.com

SITI