

FOR LEASE

6139 West 79th Street
Indianapolis, IN 46278



*Rendering subject to change

±148,640 SF AVAILABLE

Can be modified to your specific requirement

Property Highlights

±148,640 SF available 6/1/2021

Divisible

Located in the heart of the well-established Park 100 business park with convenient access to I-465 & I-65

Build-to-Suit office

Several amenities located within minutes including: restaurants, retail and major shipping locations (FedEx and UPS ground customer service centers)

±10.261 acres

Zoned C-S (Commercial - Special District) Zoning allows for a wide variety of uses

Several well-known corporate neighbors nearby including, but not limited to: Chip Ganassi Racing, Medxcel, AIT Bioscience, Specialty Coatings, Rolls Royce, Butler MacDonald and PAR North America.

Contact

TODD T. VANNATTA, SIOR
Senior Director
+1 317 639 0455
todd.vannatta@cushwake.com

MICHAEL W.M. WEISHAAR, SIOR
Executive Director
+1 317 639 0494
michael.weishaar@cushwake.com

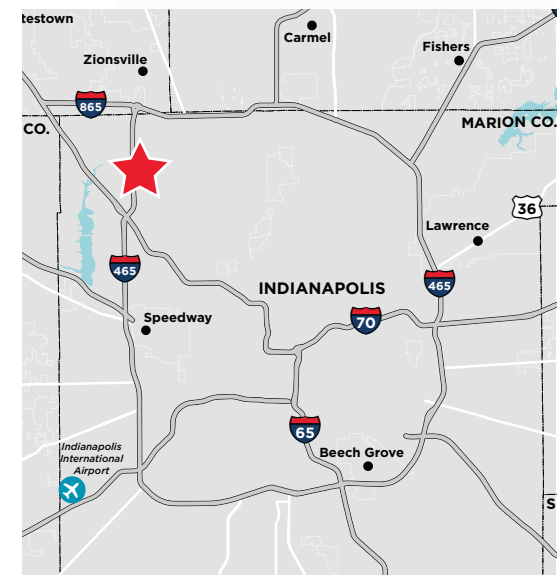

CUSHMAN & WAKEFIELD
One American Square | Suite 1800
Indianapolis, IN 46282
cushmanwakefield.com

FOR LEASE

6139 West 79th Street
Indianapolis, IN 46278



Building Size	±148,640 SF (285' x 520')
Office	BTS
Site	±10.261 Acres
Zoned	C-S
Column Spacing	52' x 56'3" 60' Speed Bays
Clear Height	32'
Drive-in Doors	2 (12' x 14')
Docks	14 (9' x 10')
Knockouts	14
Car Parking	108 (exclusive) 7.7/1,000 SF

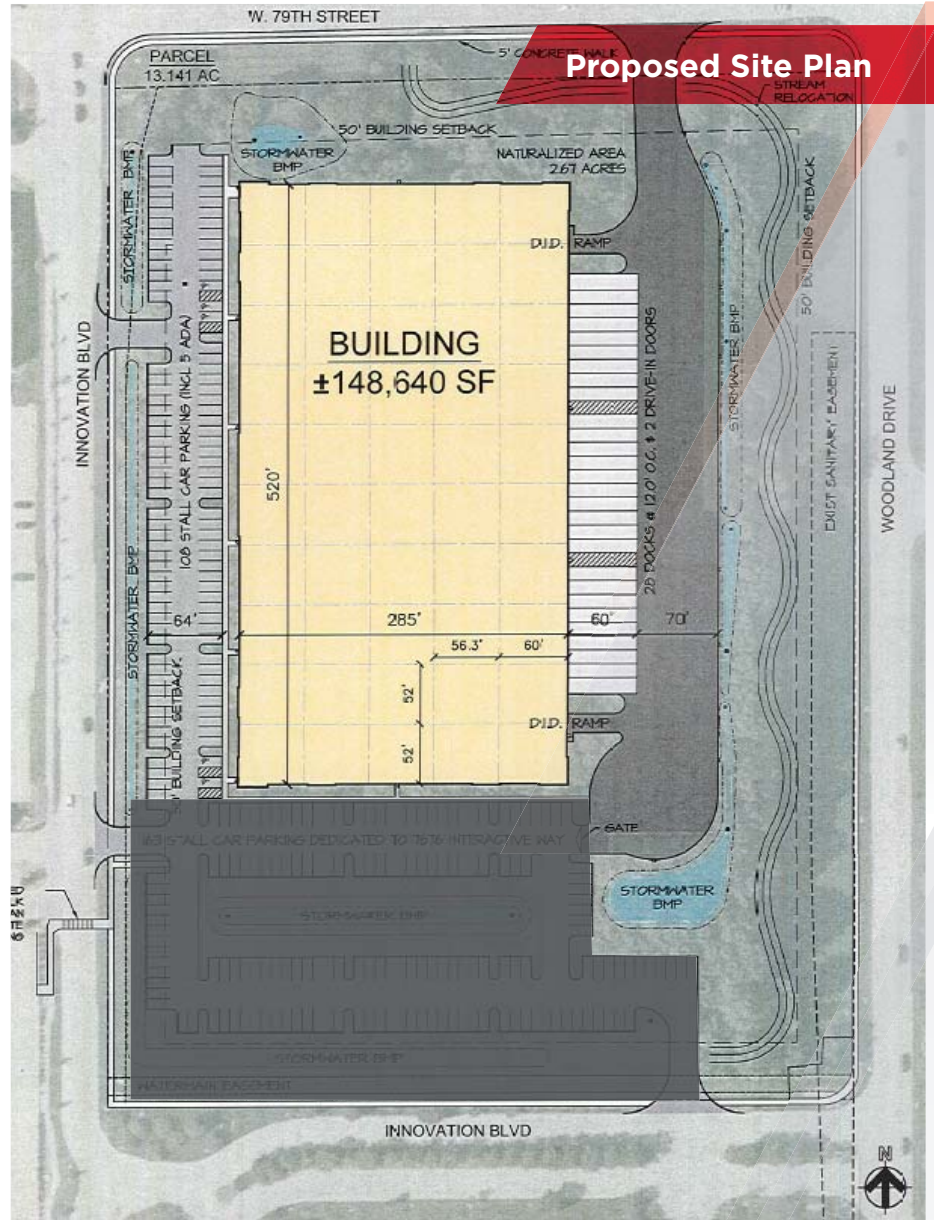

Contact

TODD T. VANNATTA, SIOR
Senior Director
+1 317 639 0455
todd.vannatta@cushwake.com

MICHAEL W.M. WEISHAAR, SIOR
Executive Director
+1 317 639 0494
michael.weishaar@cushwake.com



CUSHMAN & WAKEFIELD
One American Square I Suite 1800
Indianapolis, IN 46282
cushmanwakefield.com