

1855 DORNOCH CT  
SAN DIEGO, CA

For Sale or Lease

# 216,249 SF Distribution-Industrial Facility

155,494 SF AVAILABLE



## CONTACT

**Mickey Morera**  
Kidder Mathews  
858.369.3030 | mmorera@kiddermathews.com  
LIC #00950071



**Chris Holder, SIOR**  
Colliers International  
858.677.5372 | chris.holder@colliers.com  
LIC #00894854



PROFESSIONALLY  
OWNED AND  
MANAGED BY

LBA Logistics 

# 1855 DORNOCH CT SAN DIEGO, CA

## For Sale or Lease

### FEATURES

216,249 SF industrial building

155,494 SF available (divisible to 76,587 SF)

26' - 28' clear height

20,508 SF of office

ESFR sprinklers

277/480V/4,000 amps

13 dock doors (possible to add more docks)

Secure, fenced yard

Lease Rate: \$0.60 SF NNN/month

Sale Price: Negotiable

### LOCATION

Immediate access to SR-905 and SR-125

Freeway frontage

Located in the foreign trade zone

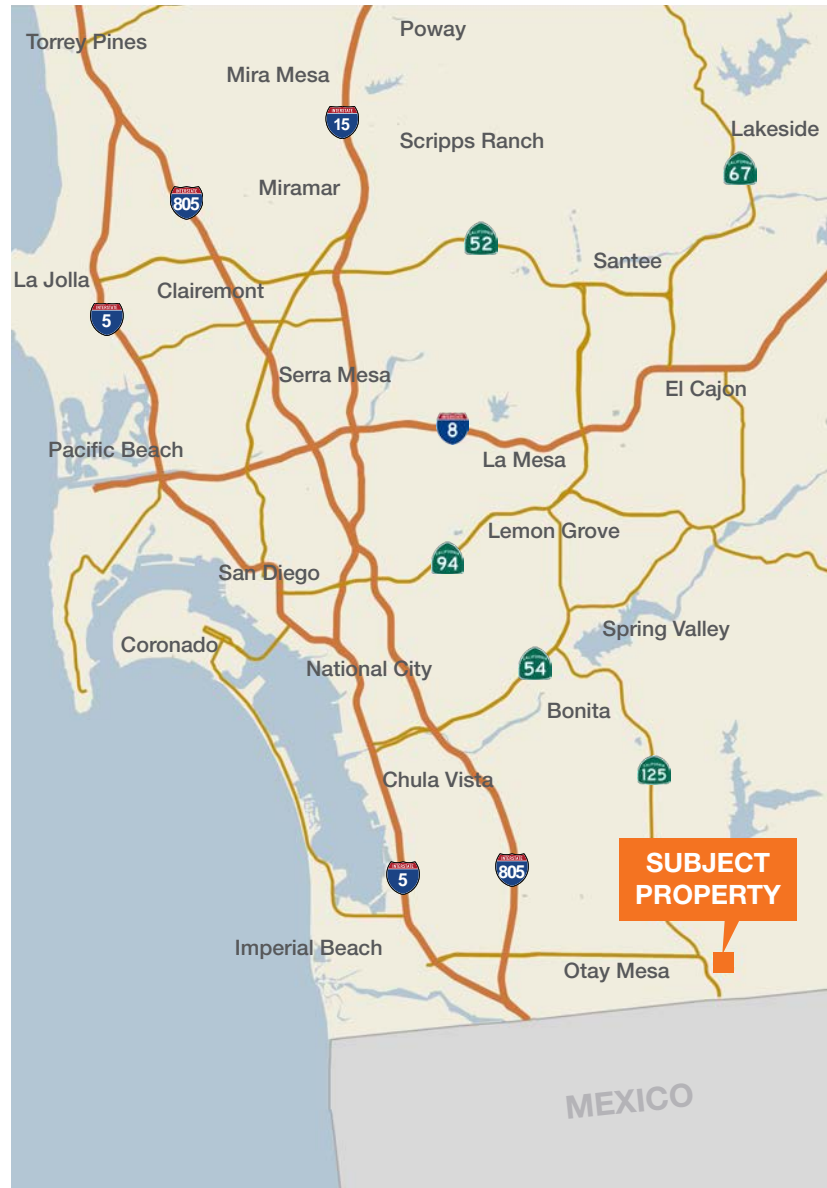

### CONTACT

#### Mickey Morera

Kidder Mathews

858.369.3030 | mmorera@kiddermathews.com

LIC #00950071

kiddermathews.com

#### Chris Holder, SIOR

Colliers International

858.677.5372 | chris.holder@colliers.com

LIC #00894854

colliers.com/sandiego

PROFESSIONALLY OWNED  
AND MANAGED BY

LBA Logistics 

This information supplied herein is from sources we deem reliable. It is provided without any representation, warranty or guarantee, expressed or implied as to its accuracy. Prospective Buyer or Tenant should conduct an independent investigation and verification of all matters deemed to be material, including, but not limited to, statements of income and expenses. Consult your attorney, accountant, or other professional advisor.



1855 DORNOCH CT  
SAN DIEGO, CA

For Sale or Lease

PHOTOS



CONTACT

**Mickey Morera**  
Kidder Mathews  
858.369.3030 | mmorera@kiddermathews.com  
LIC #00950071  
kiddermathews.com

**Chris Holder, SIOR**  
Colliers International  
858.677.5372 | chris.holder@colliers.com  
LIC #00894854  
colliers.com/sandiego

PROFESSIONALLY OWNED  
AND MANAGED BY

LBA Logistics 

This information supplied herein is from sources we deem reliable. It is provided without any representation, warranty or guarantee, expressed or implied as to its accuracy. Prospective Buyer or Tenant should conduct an independent investigation and verification of all matters deemed to be material, including, but not limited to, statements of income and expenses. Consult your attorney, accountant, or other professional advisor.



# 1855 DORNOCH CT SAN DIEGO, CA

## For Sale or Lease

### SITE PLAN

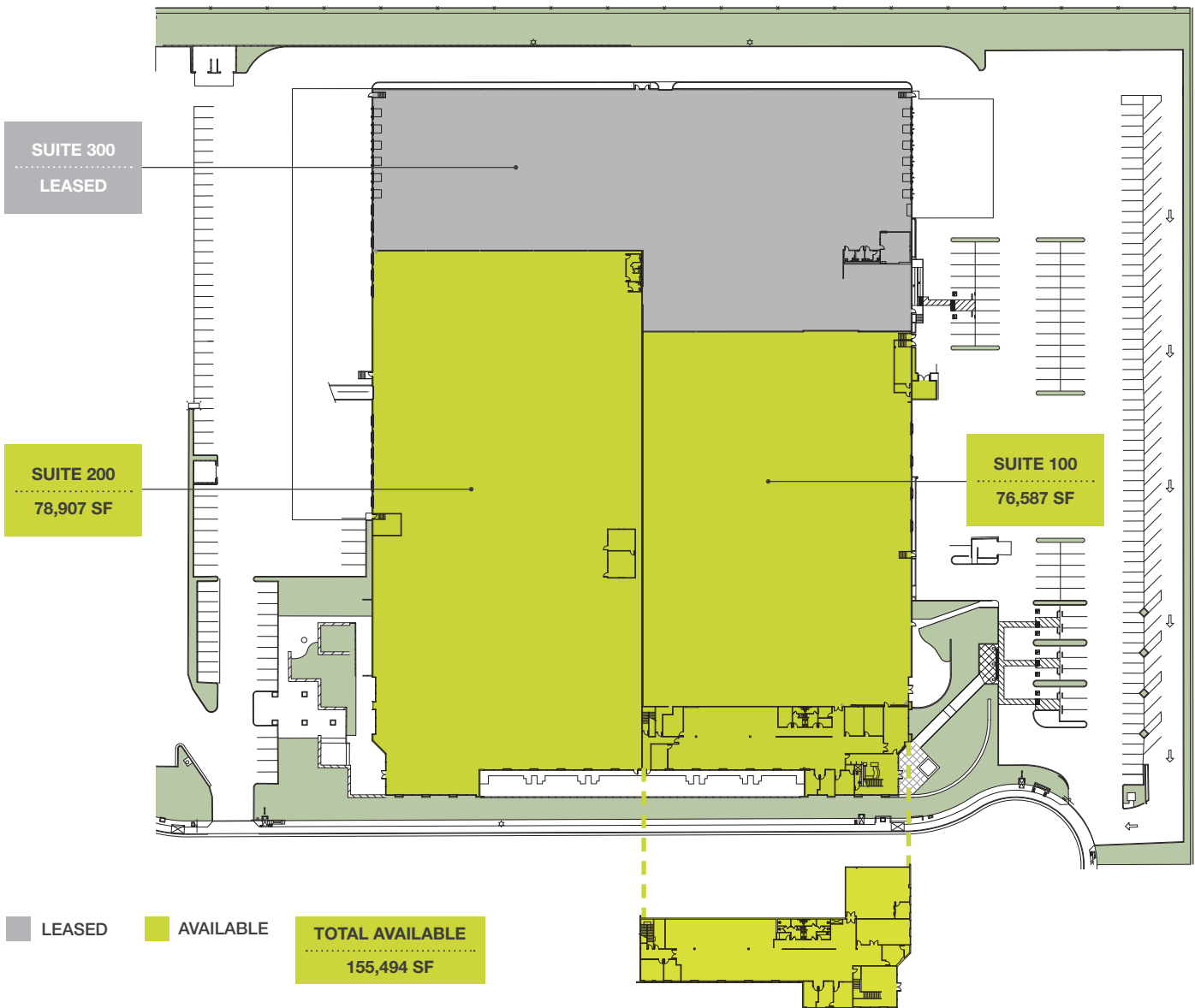

### CONTACT

**Mickey Morera**  
Kidder Mathews  
858.369.3030 | mmorera@kiddermathews.com  
LIC #00950071  
kiddermathews.com

**Chris Holder, SIOR**  
Colliers International  
858.677.5372 | chris.holder@colliers.com  
LIC #00894854  
colliers.com/sandiego

PROFESSIONALLY OWNED  
AND MANAGED BY

**LBA**Logistics 

This information supplied herein is from sources we deem reliable. It is provided without any representation, warranty or guarantee, expressed or implied as to its accuracy. Prospective Buyer or Tenant should conduct an independent investigation and verification of all matters deemed to be material, including, but not limited to, statements of income and expenses. Consult your attorney, accountant, or other professional advisor.



# 1855 DORNOCH CT SAN DIEGO, CA

## For Sale or Lease

### CORPORATE NEIGHBORS



### CONTACT

**Mickey Morera**  
Kidder Mathews  
858.369.3030 | mmorera@kiddermathews.com  
LIC #00950071  
kiddermathews.com

**Chris Holder, SIOR**  
Colliers International  
858.677.5372 | chris.holder@colliers.com  
LIC #00894854  
colliers.com/sandiego

PROFESSIONALLY OWNED  
AND MANAGED BY

**LBA**Logistics 

This information supplied herein is from sources we deem reliable. It is provided without any representation, warranty or guarantee, expressed or implied as to its accuracy. Prospective Buyer or Tenant should conduct an independent investigation and verification of all matters deemed to be material, including, but not limited to, statements of income and expenses. Consult your attorney, accountant, or other professional advisor.

