



**Publix #1572 - Five Points**  
 5580 Woodbine Road  
 Pace, FL 32571  
 Lat 30.640, Long -87.182

## DEMOGRAPHICS

	1-Mile Radius	3-Mile Radius	5-Mile Radius
2018 Population	3,650	17,895	29,956
2023 Population	4,032	20,033	33,174
2018 Average HH Income	\$99,738	\$95,265	\$85,199
2018 Median HH Income	\$78,900	\$76,450	\$67,806

## PROPERTY HIGHLIGHTS

- New Development
- Publix Anchored Center
- Two Outparcels Available
- Excellent Visibility with Convenient Ingress and Egress
- Two new traffic signals to serve center
- Combined Traffic Count: 23,500 CPD

For a complete directory of our listings visit our website:  
[www.crossmanco.com](http://www.crossmanco.com)

No warranty expressed or implied has been made to the accuracy of the information provided herein, no liability assumed for error omission  
 Licensed Real Estate Broker

Leasing Contact:  
**Jamie Golomb**  
 334.590.4332  
[jgolomb@crossmanco.com](mailto:jgolomb@crossmanco.com)



# Publix #1572 - Five Points

5580 Woodbine Road  
 Pace, FL 32571  
 Lat 30.640, Long -87.182

## SITE PLAN

STE	TENANT	SIZE
1	Publix	45,600
2	Publix Liquors	1,400
3	Chopsticks Asian Cuisine	1,400
4	Postal Annex	1,300
OP1	AVAILABLE	±1 Acre
OP2	AVAILABLE	±1 Acre
<b>TOTAL</b>		<b>49,700</b>

AVAILABLE     NOT OWNED

## PROPOSED OP

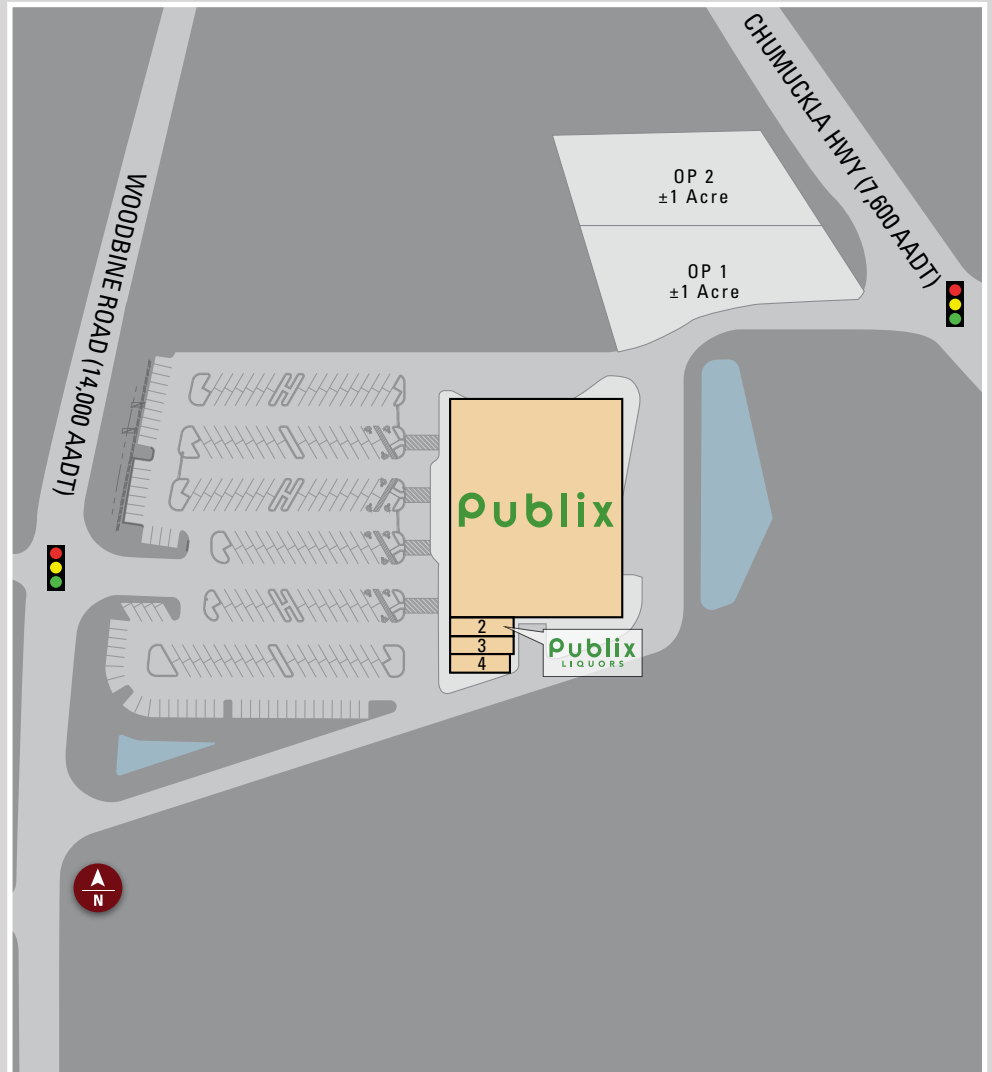
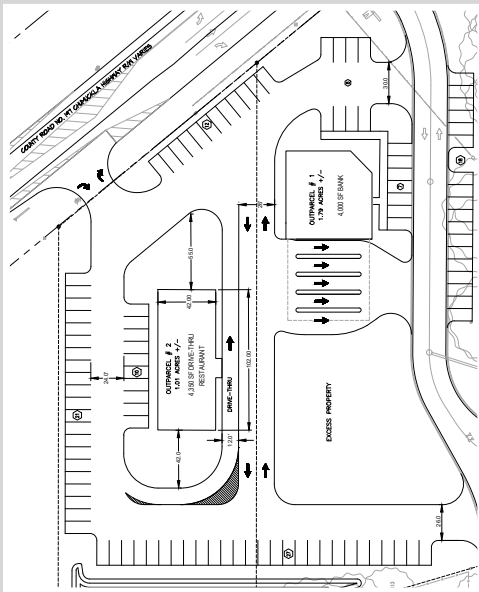

For a complete directory of our listings visit our website:  
[www.crossmanco.com](http://www.crossmanco.com)

No warranty expressed or implied has been made to the accuracy of the information provided herein, no liability assumed for error omission  
 Licensed Real Estate Broker

Leasing Contact:

**Jamie Golomb**

334.590.4332

jgolomb@crossmanco.com



Crossman & Company