

FOR LEASE

WWW.INSITEREALTY.COM

WORLD HOUSTON 35

45,040 SQUARE FEET



4721 WORLD HOUSTON PARKWAY
HOUSTON, TEXAS

[CLICK HERE FOR VIRTUAL TOUR](#)

PROPERTY FEATURES

- 3,977 SF OFFICE SPACE
- 41,063 SF WAREHOUSE
- 26 PARKING SPACES
- PRIVATE TRUCK APRON
- 3 PHASE / 480 VOLT / 200 AMPS
- 10 DOCK HIGH DOORS, 1 OVERSIZED RAMPED DOOR
- 24' CLEAR HEIGHT
- FREESTANDING BUILDING
- ESFR SPRINKLER SYSTEM
- EASY ACCESS TO BUSH IAH, BELTWAY 8, I-45, HWY 59 AND THE HARDY TOLL ROAD



FOR MORE INFORMATION PLEASE CONTACT

LOGAN GREER • LGREER@INSITEREALTY.COM • 713.339.5363

DAYNE WUNDERLICH • DWUNDERLICH@INSITEREALTY.COM • 713.339.5329

A PROJECT OF

EASTGROUP
PROPERTIES

The information contained herein was obtained from sources believed reliable; however, InSite Realty Partners, L.P. makes no guarantees, warranties or representations as to the completeness or accuracy thereof. The presentation of this property is submitted subject to errors, omissions, change of price or conditions, prior sale or lease, or withdrawal without written notice.

INSITE

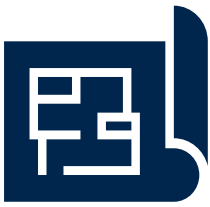

WORLD HOUSTON 35

FLOOR PLAN

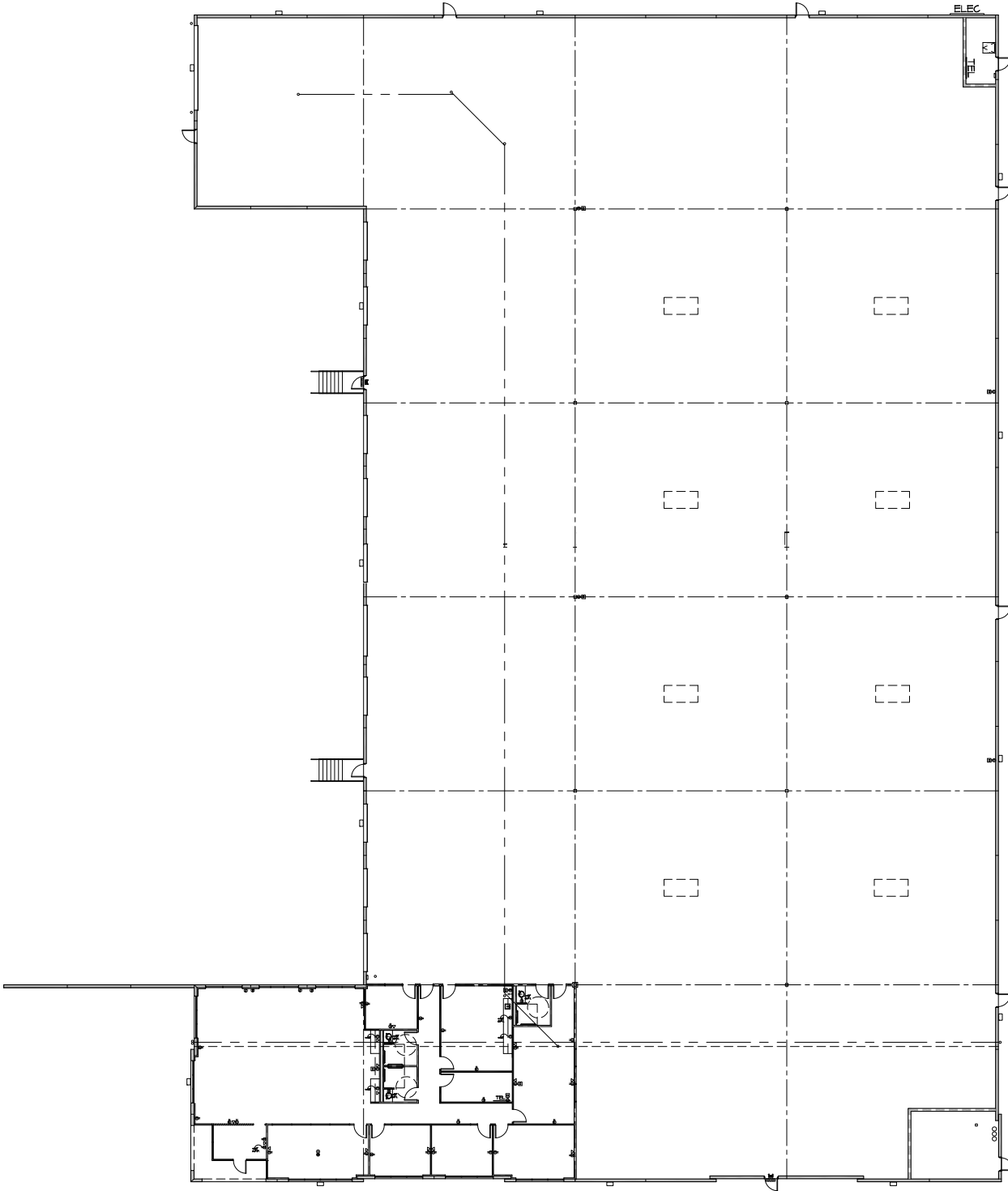

FOR MORE INFORMATION PLEASE CONTACT

LOGAN GREER • LGREER@INSITEREALTY.COM • 713.339.5363
DAYNE WUNDERLICH • DWUNDERLICH@INSITEREALTY.COM • 713.339.5329



The information contained herein was obtained from sources believed reliable; however, InSite Realty Partners, L.P. makes no guarantees, warranties or representations as to the completeness or accuracy thereof. The presentation of this property is submitted subject to errors, omissions, change of price or conditions, prior sale or lease, or withdrawal without written notice.

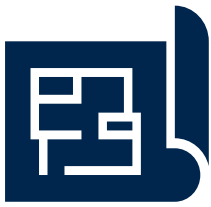

WORLD HOUSTON 35

SITE PLAN

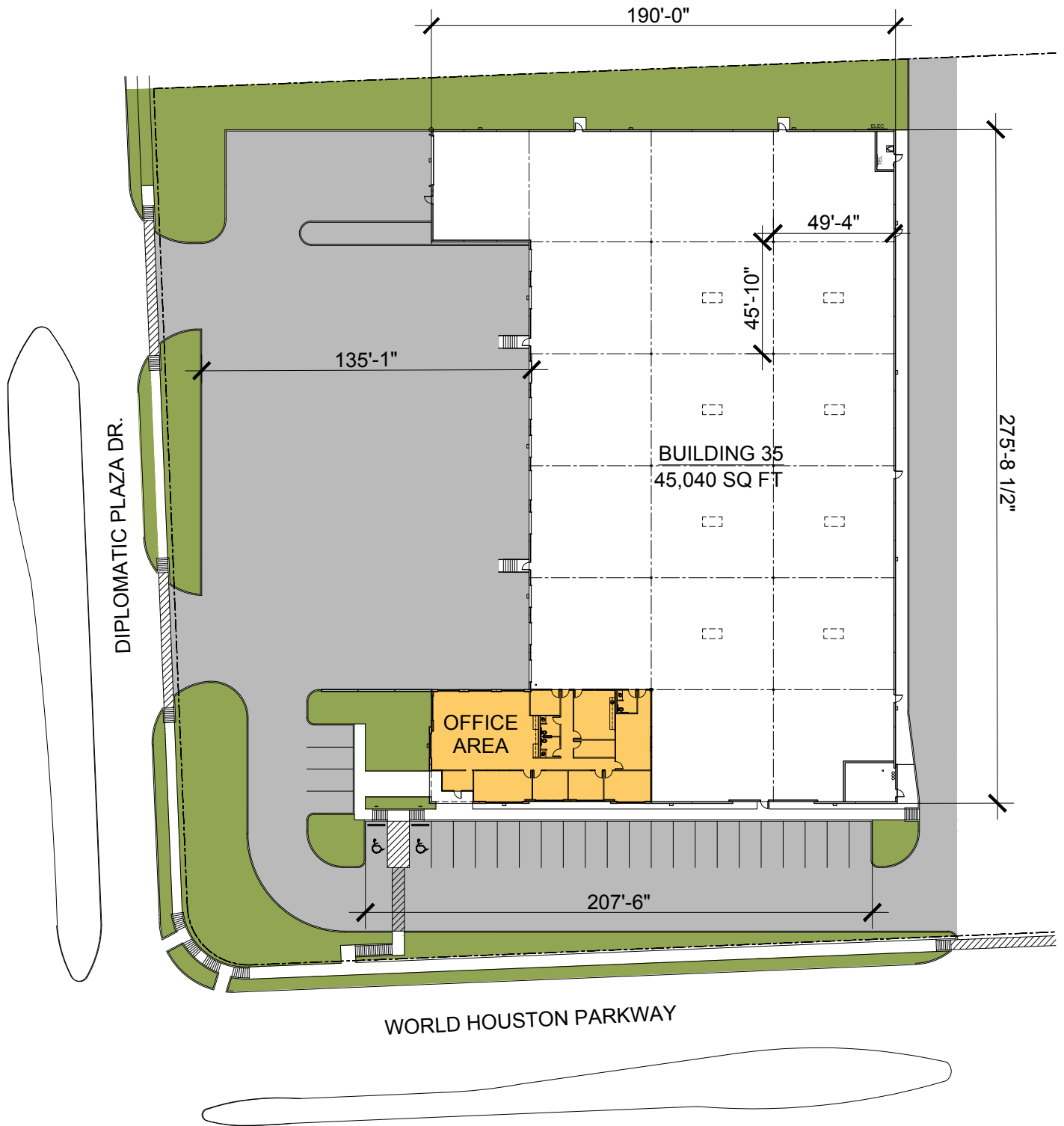

FOR MORE INFORMATION PLEASE CONTACT

LOGAN GREER • LGREER@INSITEREALTY.COM • 713.339.5363

DAYNE WUNDERLICH • DWUNDERLICH@INSITEREALTY.COM • 713.339.5329

A PROJECT OF

EASTGROUP
PROPERTIES

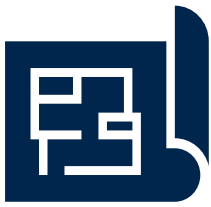

WORLD HOUSTON 35

AERIAL



- 2 MILES TO BUSH IAH
- IMMEDIATELY TO BELTWAY 8
- 0.5 MILES TO HWY 59
- 5 MILES TO HARDY TOLL ROAD
- 7 MILES TO I-45
- 14 MILES TO GRAND PKWY/99
- 14 MILES TO DOWNTOWN
- 19 MILES TO PORT OF HOUSTON
- 21 MILES TO GALLERIA/UPTOWN

FOR MORE INFORMATION PLEASE CONTACT

LOGAN GREER • LGREER@INSITEREALTY.COM • 713.339.5363

DAYNE WUNDERLICH • DWUNDERLICH@INSITEREALTY.COM • 713.339.5329

A PROJECT OF

EASTGROUP
PROPERTIES