

# Fee Simple Warehouse Investment Offering \$1,350,000



1866 Wili Pa Loop  
Wailuku, Maui

**Exclusively offered For Sale by**

SCOTT KENAR, R(S) AND GRANT E. HOWE, CCIM R(B)



COMMERCIAL PROPERTIES  
OF MAUI

444 Hana Highway, Suite C, Kahului, HI 96732

(808)244-2200 OFFICE | (808)442-1195 FAX

skenar@mauibiz.com | ghowe@mauibiz.com E-MAIL

www.mauibiz.com |



# 1866 Wili Pa Loop



## Wailuku, Maui, Hawaii

PRICE	\$1,350,000 FS
UNIT 1 1ST FLR WAREHOUSE	2,923 SQ FT
UNIT 1 1ST FLOOR OFFICE	570 SQ FT
UNIT 1 2ND FLOOR OFFICE	336 SQ FT
UNIT 2 1ST FLR WAREHOUSE	3,419 SQ FT
UNIT 2 1ST FLOOR OFFICE	294 SQ FT
UNIT 2 MEZZANINE	3,230 SQ FT
COMBINED AREA	10,772 SQ FT
LAND AREA	13,482 SQ FT
PRICE /SQ FT (BLDG)	\$154.96 /SQ FT
ADDRESS	1866 WILI PA LOOP
TMK	2) 3-4-20-53
ZONING	M-1
YEAR BUILT	1988
PARKING	12 stalls
WATER METER	3/4" meter

\* Some of existing mezzanine may be nonconforming

3% Commission to Cooperating Brokers.

The information contained herein comes from sources deemed reliable, but no warranties or guarantees as to the accuracy of the information should be construed.

### TENANTS

Unit 1: Spectracolor Hawaii Printing & Imaging, Inc.

Unit 2: Cutting Edge Corporation

Contact Listing Agents  
For Income, Expense and  
Tenant Lease Information



COMMERCIAL PROPERTIES  
OF MAUI

**SCOTT KENAR, R(S) AND GRANT E. HOWE, CCIM R(B)**

444 Hana Highway, #C, Kahului, HI 96732 | (808)244-2200 OFFICE | (808)442-1195 FAX

www.mauibiz.com | skenar@mauibiz.com | ghowe@mauibiz.com E-MAIL

The information contained herein comes from sources deemed reliable, but no warranties or guarantees as to the accuracy of the information should be construed.



# Property Photos



**SCOTT KENAR, R(S) AND GRANT E. HOWE, CCIM R(B)**

444 Hana Highway, #C, Kahului, HI 96732 | (808)244-2200 OFFICE | (808)442-1195 FAX

www.mauibiz.com | skenar@mauibiz.com | ghowe@mauibiz.com E-MAIL



# Aerial View



**SCOTT KENAR, R(S) AND GRANT E. HOWE, CCIM R(B)**

444 Hana Highway, #C, Kahului, HI 96732 | (808)244-2200 OFFICE | (808)442-1195 FAX

www.mauibiz.com | skenar@mauibiz.com | ghowe@mauibiz.com E-MAIL





# Map

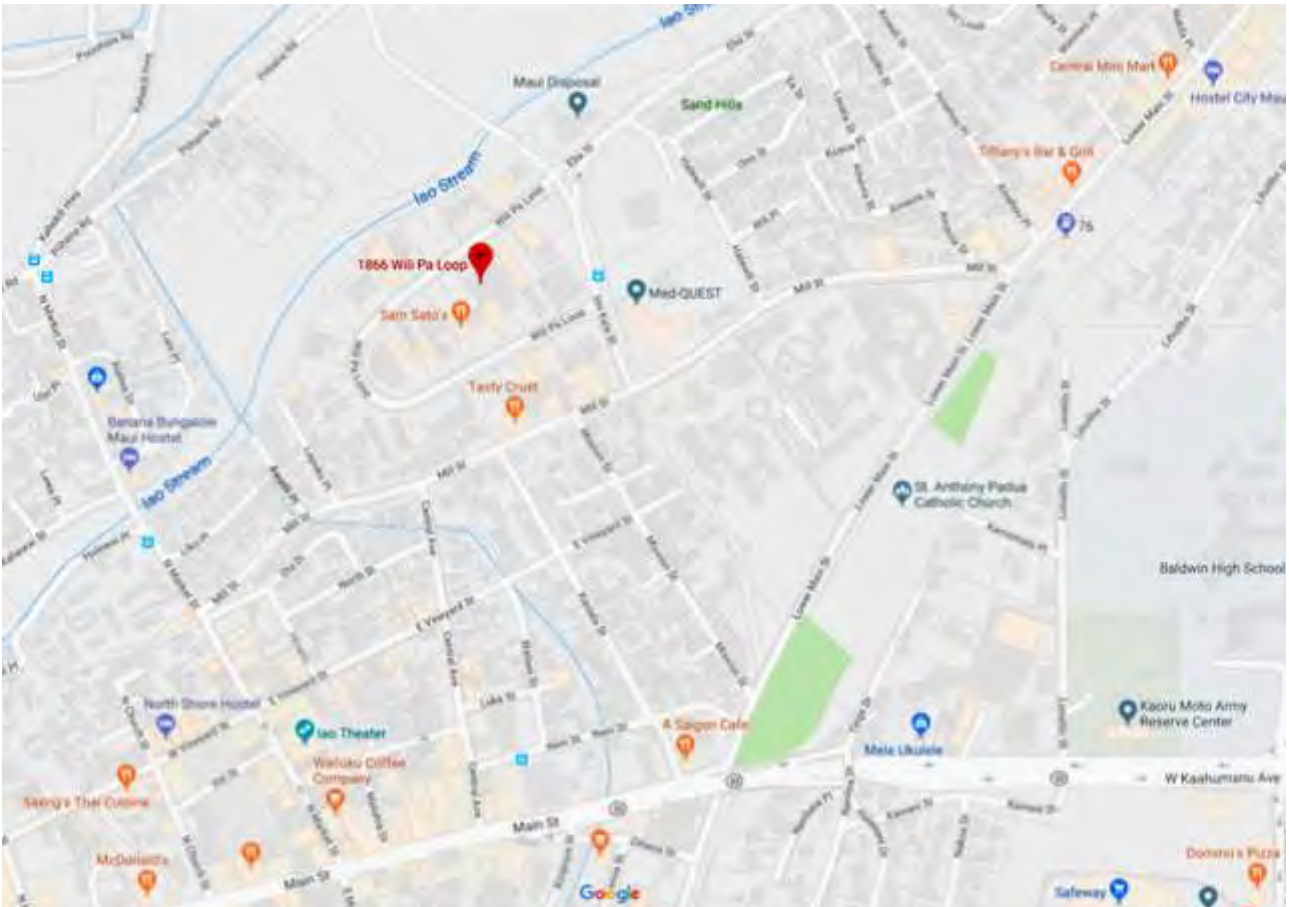

**SCOTT KENAR, R (S) AND GRANT E. HOWE, CCIM R(B)**

444 Hana Highway, #C, Kahului, HI 96732 | (808)244-2200 OFFICE | (808)442-1195 FAX

[www.mauibiz.com](http://www.mauibiz.com) | [skenar@mauibiz.com](mailto:skenar@mauibiz.com) | [ghowe@mauibiz.com](mailto:ghowe@mauibiz.com) E-MAIL



# Site Plan

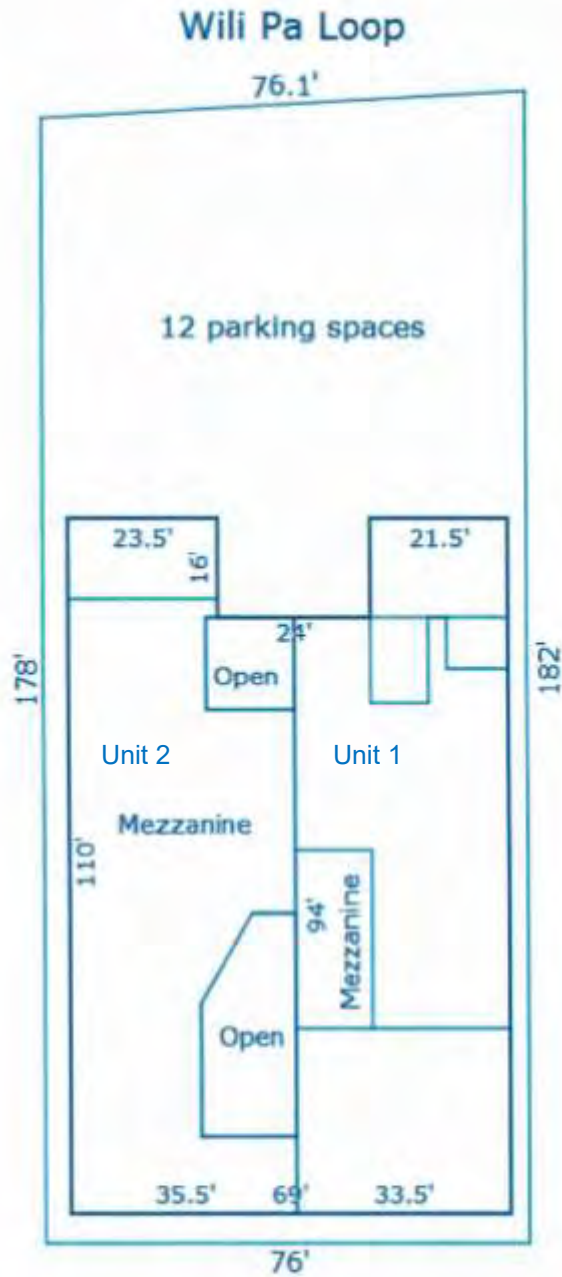

**SCOTT KENAR, R (S) AND GRANT E. HOWE, CCIM R(B)**

444 Hana Highway, #C, Kahului, HI 96732 | (808)244-2200 OFFICE | (808)442-1195 FAX

www.mauibiz.com | skenar@mauibiz.com | ghowe@mauibiz.com E-MAIL



# Tax Map



**SCOTT KENAR, R(S) AND GRANT E. HOWE, CCIM R(B)**

444 Hana Highway, #C, Kahului, HI 96732 | (808)244-2200 OFFICE | (808)442-1195 FAX

www.mauibiz.com | skenar@mauibiz.com | ghowe@mauibiz.com E-MAIL

