

CORPORATE RESEARCH CENTER

Class A Office/R&D For Lease | ±28,892 SF



26460 Corporate Avenue, Hayward, CA

NEWMARK

Steve Kapp, SIOR

510.300.0213 | skapp@ngkf.com
CA RE License #01069911

Dan Dowd, SIOR

510.300.0223 | ddowd@ngkf.com
CA RE License #01432679



PROJECT HIGHLIGHTS

FIRST FLOOR

Full Floor **±28,892 SF**



OUTDOOR SEATING AREA



FEATURES

- Class A Corporate Identity Building
- Dramatic 2-Story Lobby Entry
- Custom Office Buildout to Suit
- Central Bay Area location next to San Mateo Bridge
- On Site Cafeteria and Outdoor Landscape Amenity Area
- Heavy Infrastructure (Power, Data, HVAC)
- Former Applied Materials Campus
- Expansion Potential
- Parking Ratio - 4/1,000



FIRST FLOOR

FEATURES

- 10 Private Offices
- 3 Conference Rooms
- 5 Medical Device Laboratories
- Clean Room/ Gowning Area
- Break Room



±28,892 SF

FIRST FLOOR

- Office
- Common Area
- Lab
- Warehouse

Outdoor Amenity Area

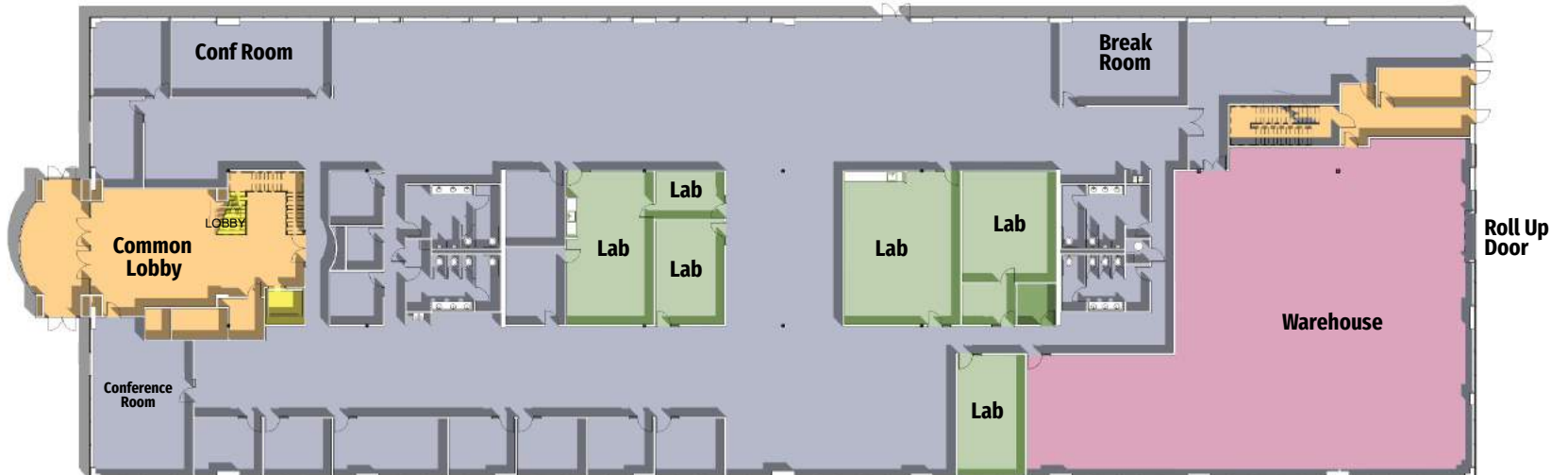



View Showing New Entrance Off Main Lobby



View Showing New Conference Room and Lobby



The distributor of this communication is performing acts for which a real estate license is required. The information contained herein has been obtained from sources deemed reliable but has not been verified and no guarantee, warranty or representation, either express or implied, is made with respect to such information. Terms of sale or lease and availability are subject to change or withdrawal without notice.

AERIAL - Nearby Amenities

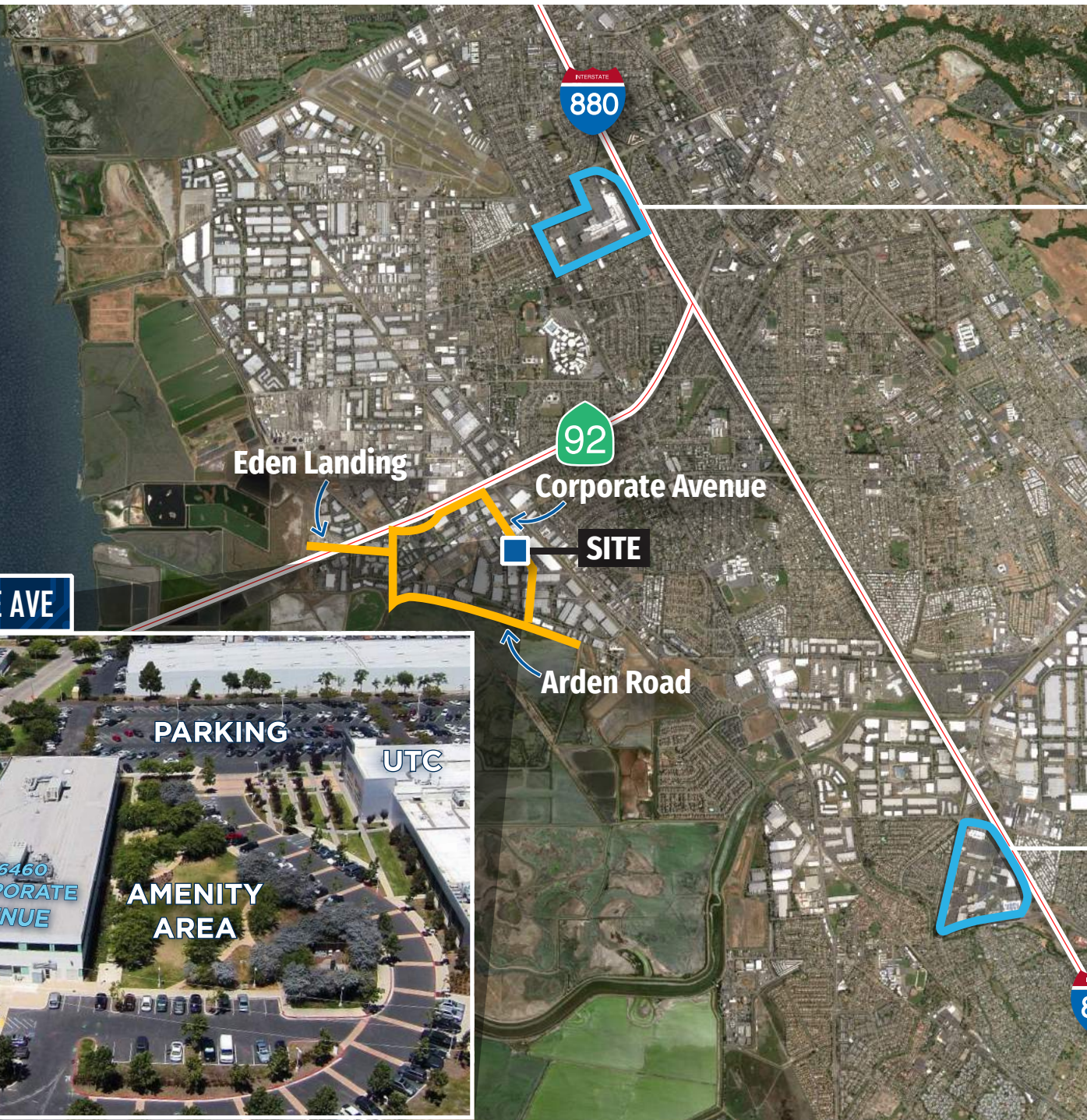

SOUTHLAND MALL

MAJOR RETAILERS

- Olive Garden
- Panda Express
- Little Tikes
- Famous Dave's
- CHASE
- Wells Fargo
- Applebee's
- Panera

UNION LANDING

MAJOR RETAILERS

- Chili's
- Chipotle
- Texas Roadhouse
- Starbucks
- In-N-Out Burger
- Wendy's
- CHASE
- Buffalo Wild Wings
- Wells Fargo
- Sushi Boat

26460 CORPORATE AVE



PARKING

UTC

AMENITY
AREA

CORPORATE AVE

26460
CORPORATE
AVENUE