

82 Christopher Street

WEST VILLAGE
NEW YORK, NY



Property Details

Location

South block between Bleecker Street and Seventh Avenue South

Approximate Size

Space A	
Ground Floor	400 SF
Space B	
Ground Floor	600 SF
Basement	1,000 SF
Backyard	350 SF
Total	2,350 SF

Frontage

Space A 10 FT on Christopher Street
Space B 10 FT on Christopher Street

Term

Negotiable

Possession

Immediate

Site Status

Space A Formerly Flip 'N Toss
Space B Currently Hudson Bagels

Neighbors

Bobo, Scotch & Soda, Milk Bar, Chip City, Aesop, Wilfie and Nell, Intermix, Buvette, John's Pizzeria of Bleecker Street, Dominique Ansel Kitchen, L'Artusi, Rag & Bone and Jekyll & Hyde Club

Comments

Space is currently demised as two separate stores and can be leased as currently demised or as one (see floor plans)

Space is vented with existing walk-in boxes and grease trap in place, no Key Money

Cozy backyard space of 350 SF that can be enclosed, expanding the Ground Floor to 1,350 SF

Very heavily trafficked block, steps from the **1** subway line and the Bleecker Street luxury corridor

Space has very high ceilings

Ground Floor

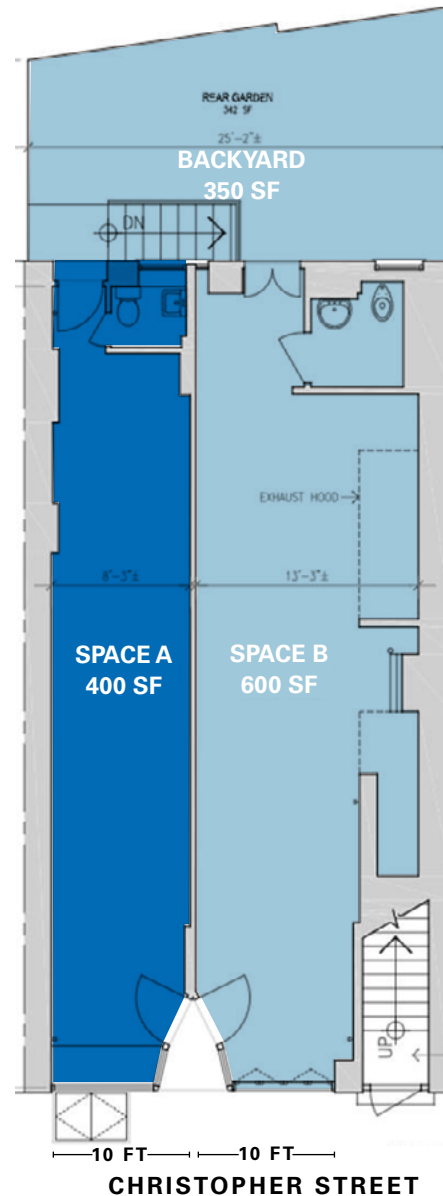

Basement

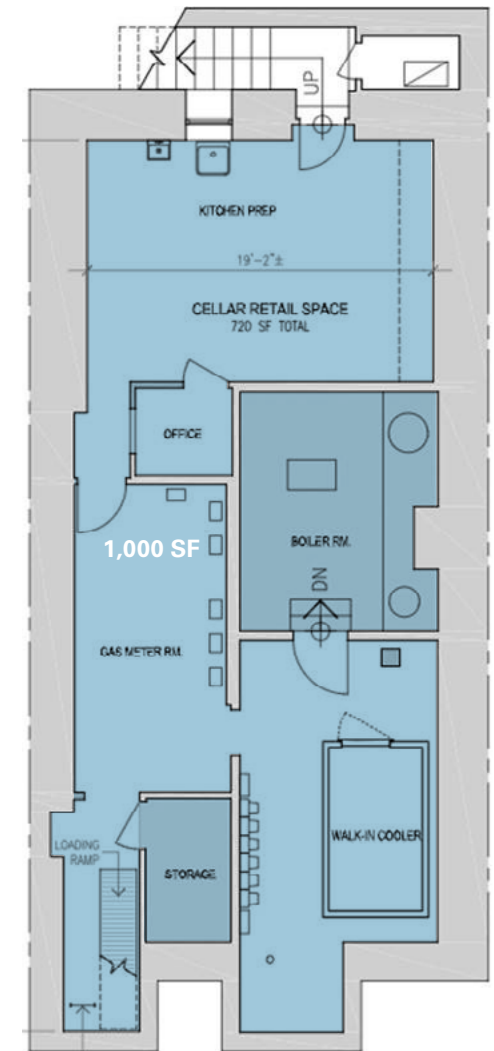

Floor Plans Single Tenant Scenario



CHRISTOPHER STREET

Backyard Photos



82 CHRISTOPHER STREET

Area Retail



CONTACT

Andrew Stern
 t 212-351-9353
 andrew.stern@nmrk.com

Ravi Idnani
 t 212-916-2938
 ravi.idnani@nmrk.com
nmrk.com