

Town Center at Celebration Village

3000 Celebration Blvd
Suwanee, Georgia 30024



Leasing Contacts

Gigi Best: (678) 501-5342

Marrissa Chanin: (678) 501-5341

Email: info@riverwoodproperties.com

Town Center is part of a 52-Acre Master-Planned Community within Celebration Village. The retail center is anchored by Lidl Grocery and two 0.86± fronting Peachtree Parkway (141), with traffic counts over 48,000. Forsyth County, the site offers multiple access points, is surrounded by 600+ roof tops and is adjacent to Brookwood Marketplace. Beyond are among many of the national retailers within this commercial corridor.

Intersection: Peachtree Parkway & Mathis Airport Rd

Daily Traffic Counts: 48,290 Vehicles Per Day

Site Access: Via curb cuts on Peachtree Parkway

Town Center at Celebration Village

AREA DEMOGRAPHICS

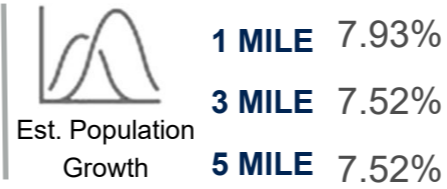

A *Restaurant Space Available* **2,737**

C **At Lease** **1,322**

D **Palazzo Nail Salon** **2,662**

F **Celebration Village Medical Office** **2,810**

G *Restaurant Space Available* **2,810**

K **Celebration Village Medical Office** **3,590**

Site A **Celebration Jeweler** **0.82± acre**

Site B *Available* **0.86± acre**

GLA: 14,388 SF

**Availability:
1,267-4,077 SF**

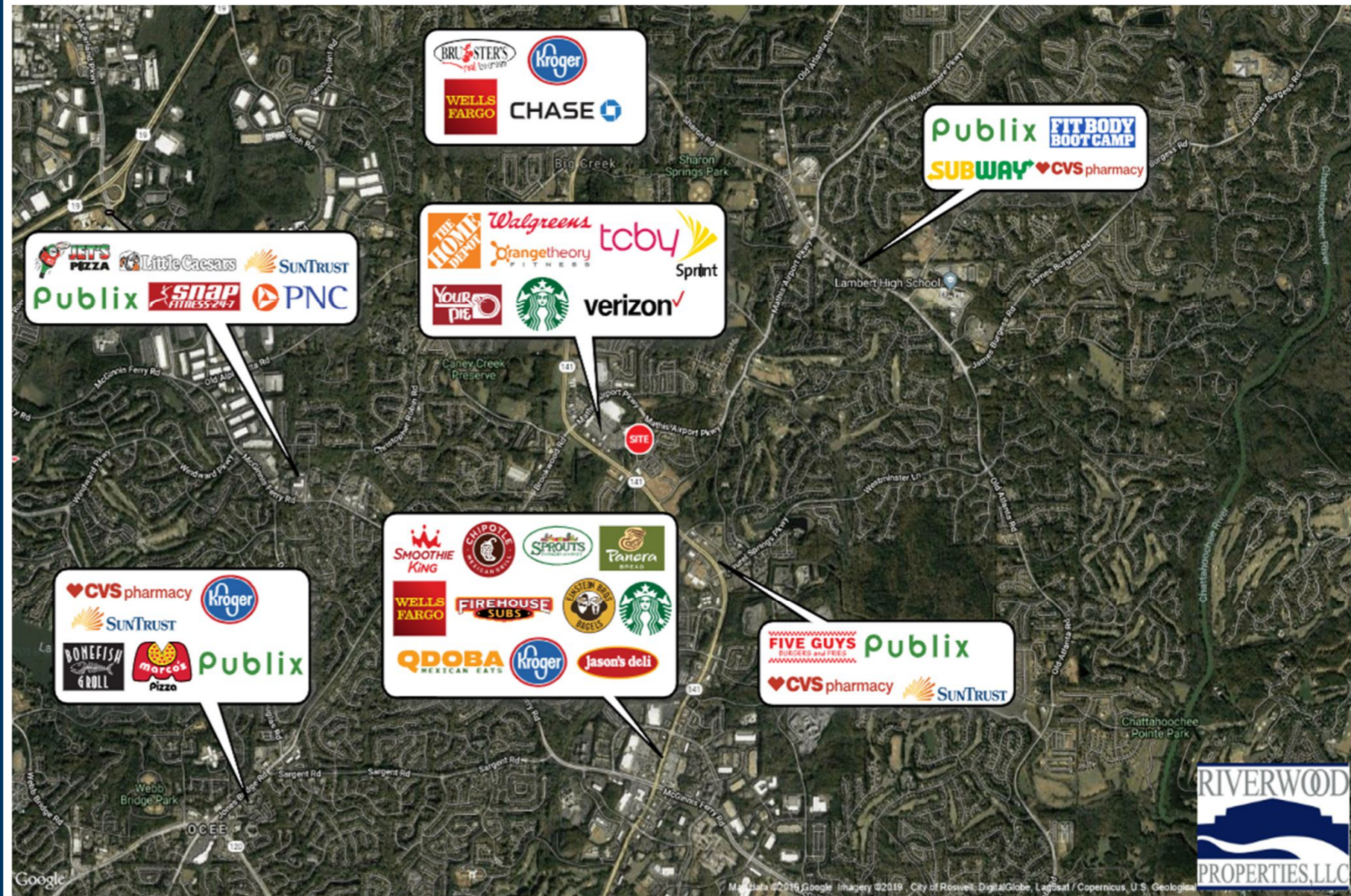

TOWN CENTER AT CELEBRATION VILLAGE **RIVERWOOD**

Trade Area Overview



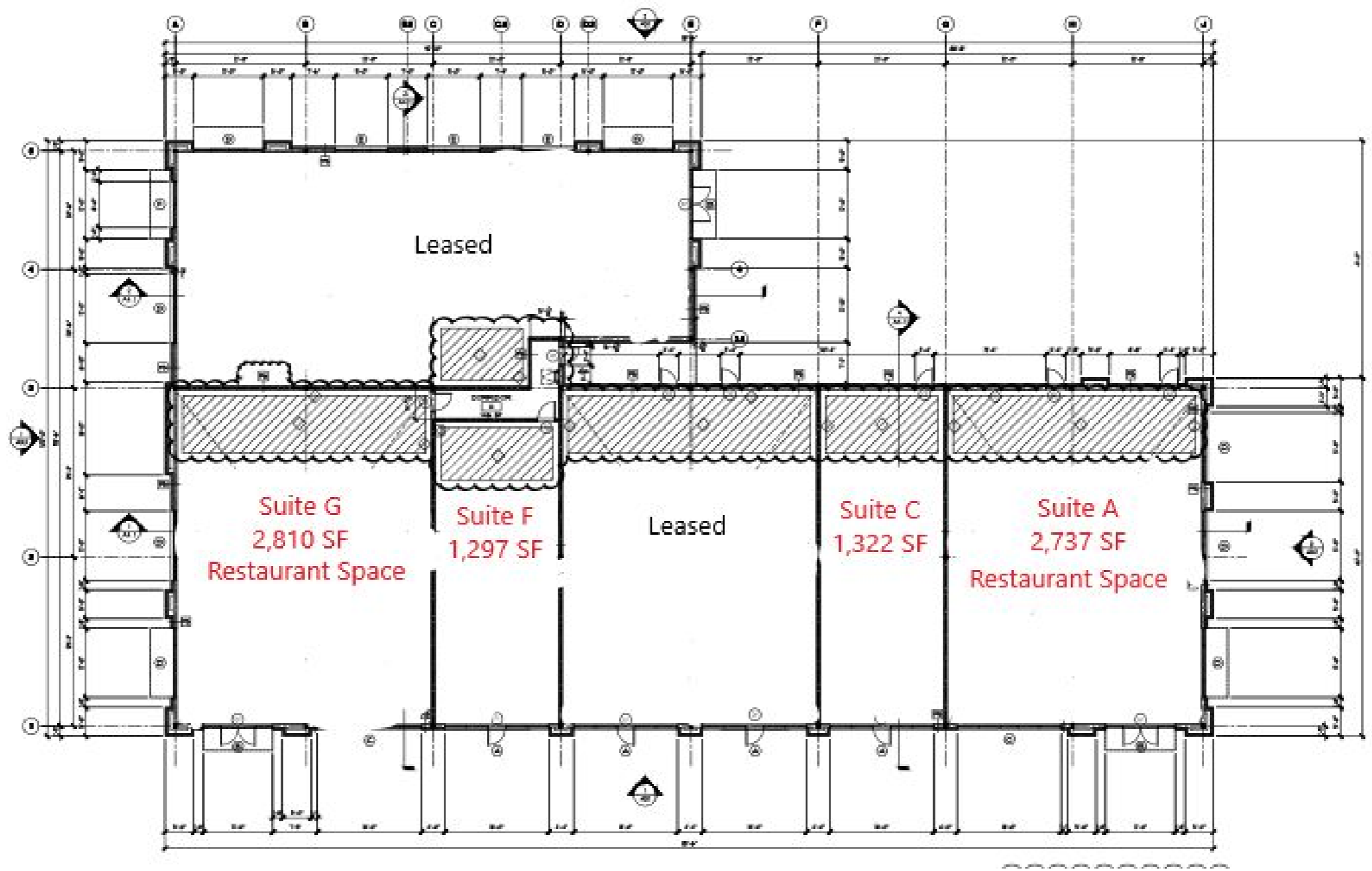

TOWN CENTER AT CELEBRATION VILLAGE