

Showroom/Office Retail/Warehouse

OXFORD/SANTA FE BUSINESS PARK

4251 S. Natches Court, Units B & C
Englewood, CO 80110

Property Features

- + 3' x 8' backlit identification sign
- + On-site management
- + Across from Riverpoint Shopping Center, banks, restaurants, Target and Costco
- + Great visibility
- + Free tenant and customer parking in front of space
- + Individual meter in each unit for gas and electricity

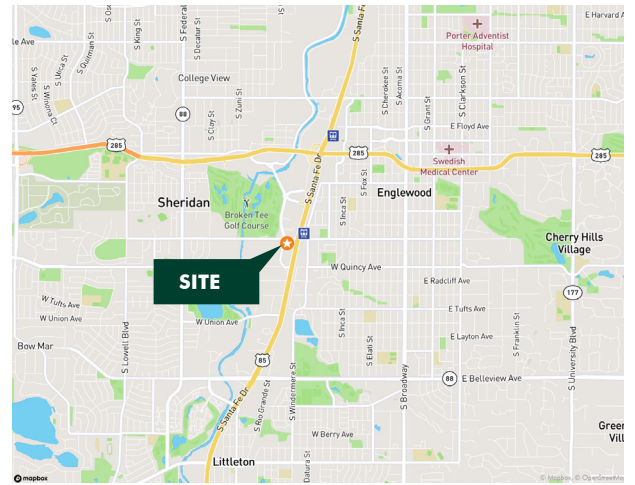

Outside Storage Available



Site Plan

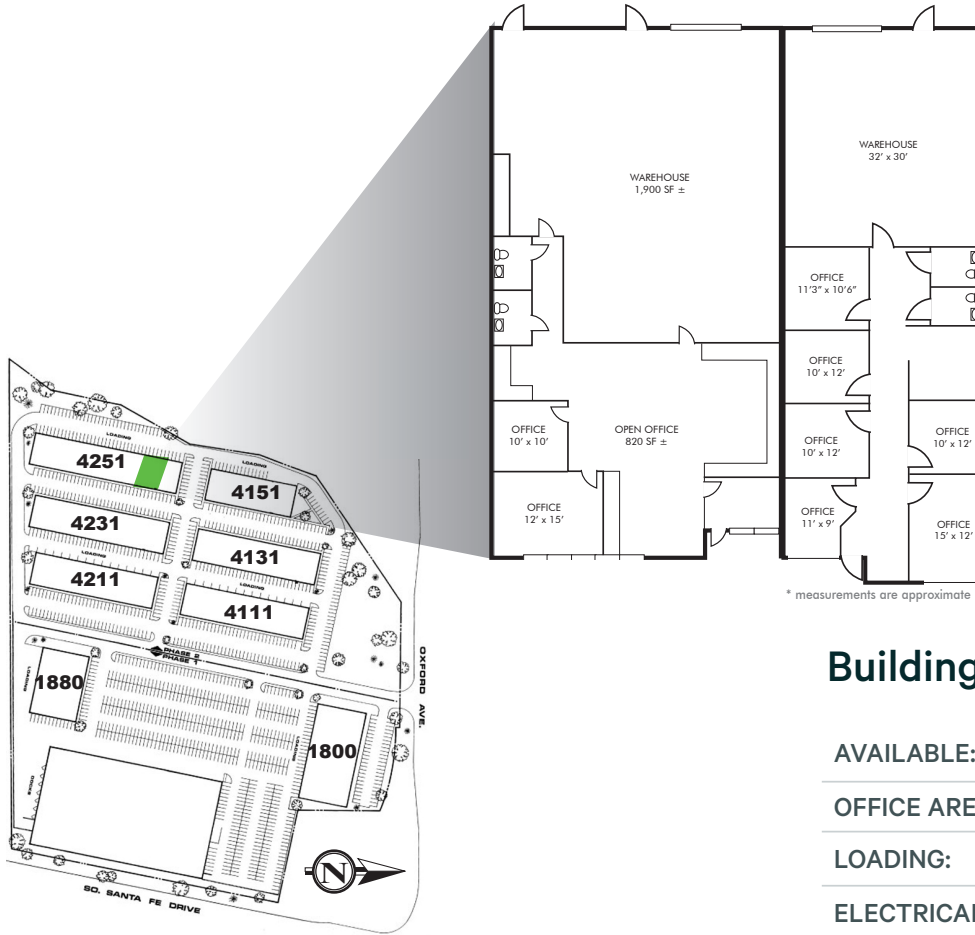

* measurements are approximate

Building Details

AVAILABLE:	5,840 SF
OFFICE AREA:	2,926 SF
LOADING:	2 drive-in doors
ELECTRICAL:	100 amp service, 3 phase
CLEARANCE:	12'
YEAR BUILT:	1983-1984
LEASE RATE:	\$9.25/SF NNN
NNN EXPENSES:	\$4.85/SF

Contact Us

Murray Platt, SIOR
First Vice President
+1 720 528 6413
murray.platt@cbre.com

Paul Kluck, SIOR
First Vice President
+1 720 528 6405
paul.kluck@cbre.com

© 2022 CBRE, Inc. All rights reserved. This information has been obtained from sources believed reliable, but has not been verified for accuracy or completeness. You should conduct a careful, independent investigation of the property and verify all information. Any reliance on this information is solely at your own risk. CBRE and the CBRE logo are service marks of CBRE, Inc. All other marks displayed on this document are the property of their respective owners, and the use of such logos does not imply any affiliation with or endorsement of CBRE. Photos herein are the property of their respective owners. Use of these images without the express written consent of the owner is prohibited.