

FLATBUSH  
JUNCTION

BROOKLYN  
NY

# 2233 NOSTRAND AVENUE



# SPACE DETAILS

## LOCATION

East block between Avenues H and I

## APPROXIMATE SIZE

Ground Floor 4,220 SF

## TERM

Negotiable

## POSSESSION

Arranged

## RENT

\$55 PSF

## SITE STATUS

Currently Mattress Firm

## NEIGHBORS

FedEx Office, Target, Nike, HomeGoods, Applebees, Men's Wearhouse, David's Bridal, The Children's Place, Verizon Wireless, Blink Fitness, Dallas BBQ, Starbucks, Modell's Sporting Goods, AT&T and The Vitamin Shoppe

## COMMENTS

One and one-half blocks to the Flatbush Avenue-Brooklyn College subway station servicing the **2** **5** trains with an annual ridership of 6,107,780

Municipal parking next door

One block from Brooklyn College with 18,746 students and faculty

Adjacent to a proposed mixed-use development

## GROUND FLOOR

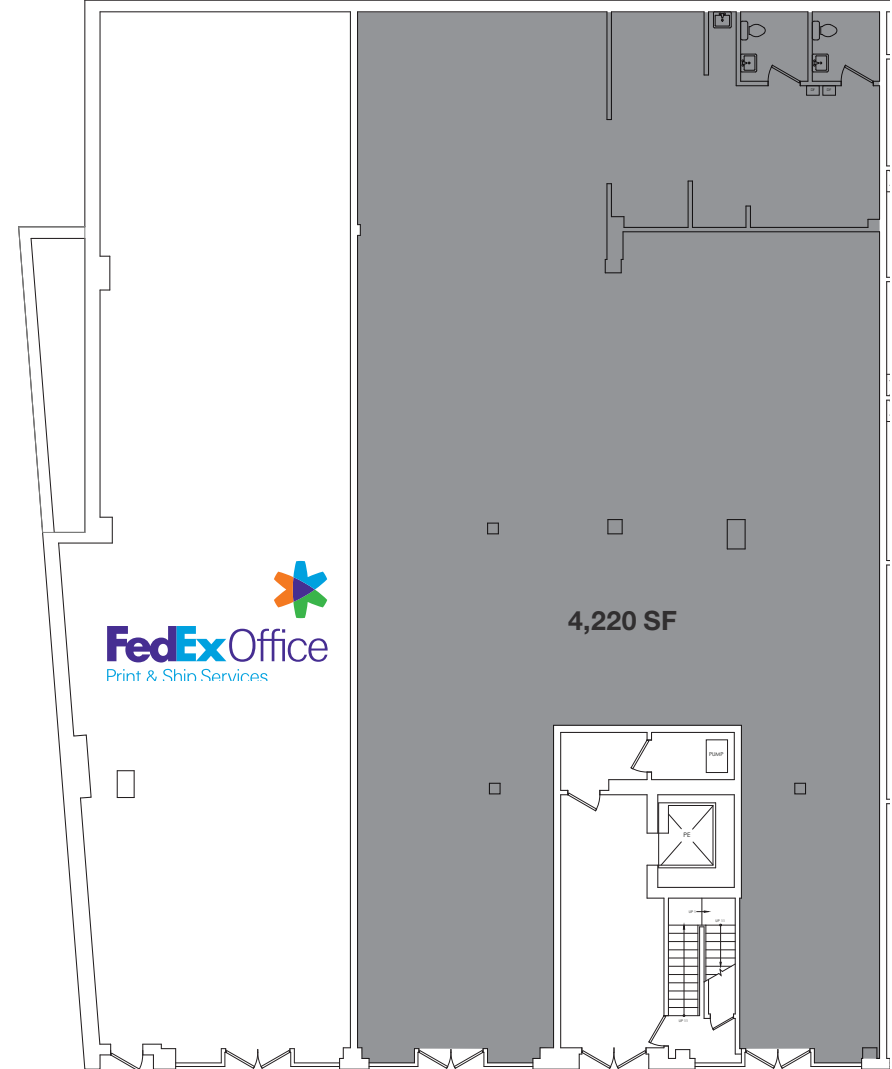

NOSTRAND AVENUE



# AREA NEIGHBORS





# AREA RETAIL

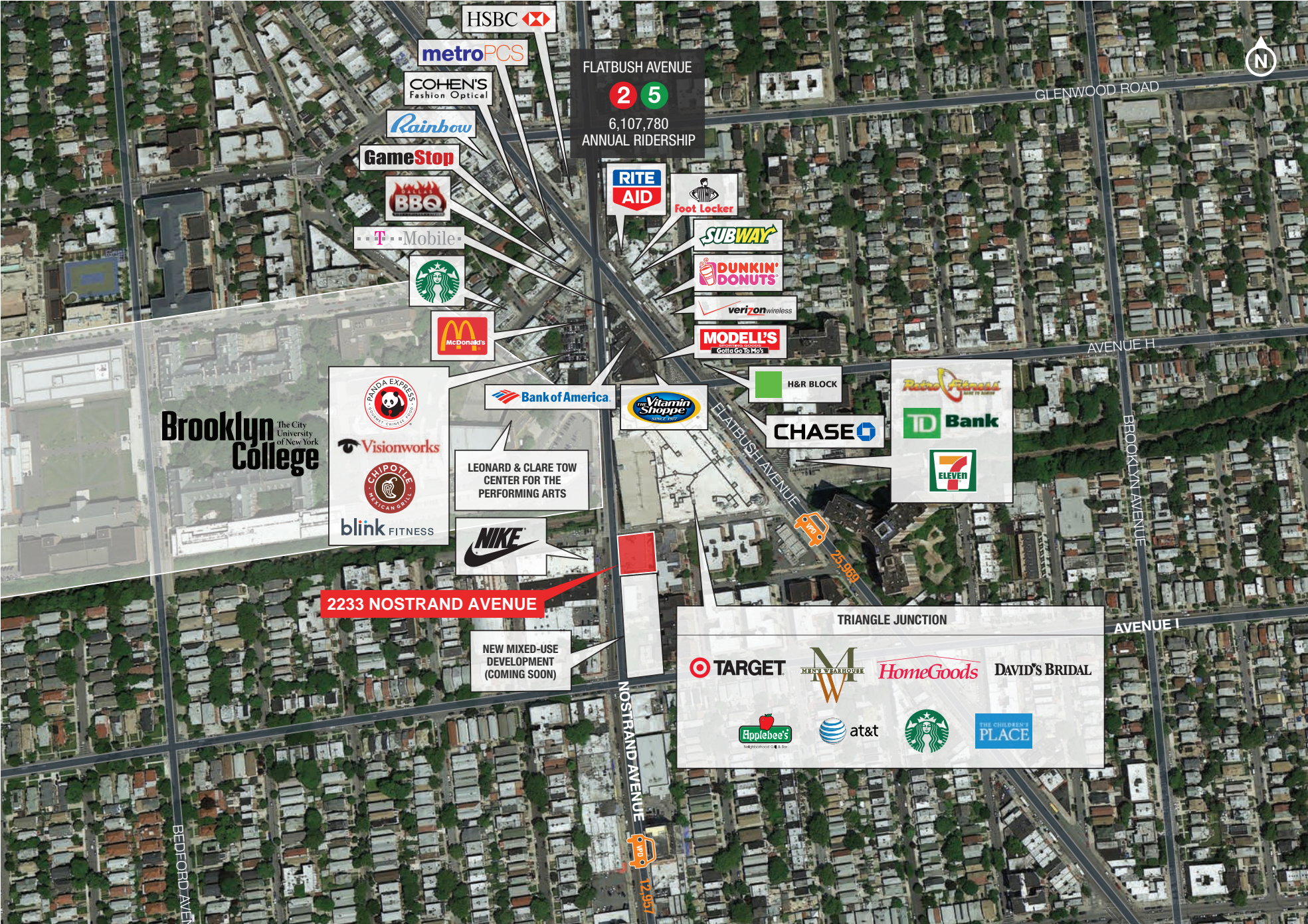



# AREA DEMOGRAPHICS

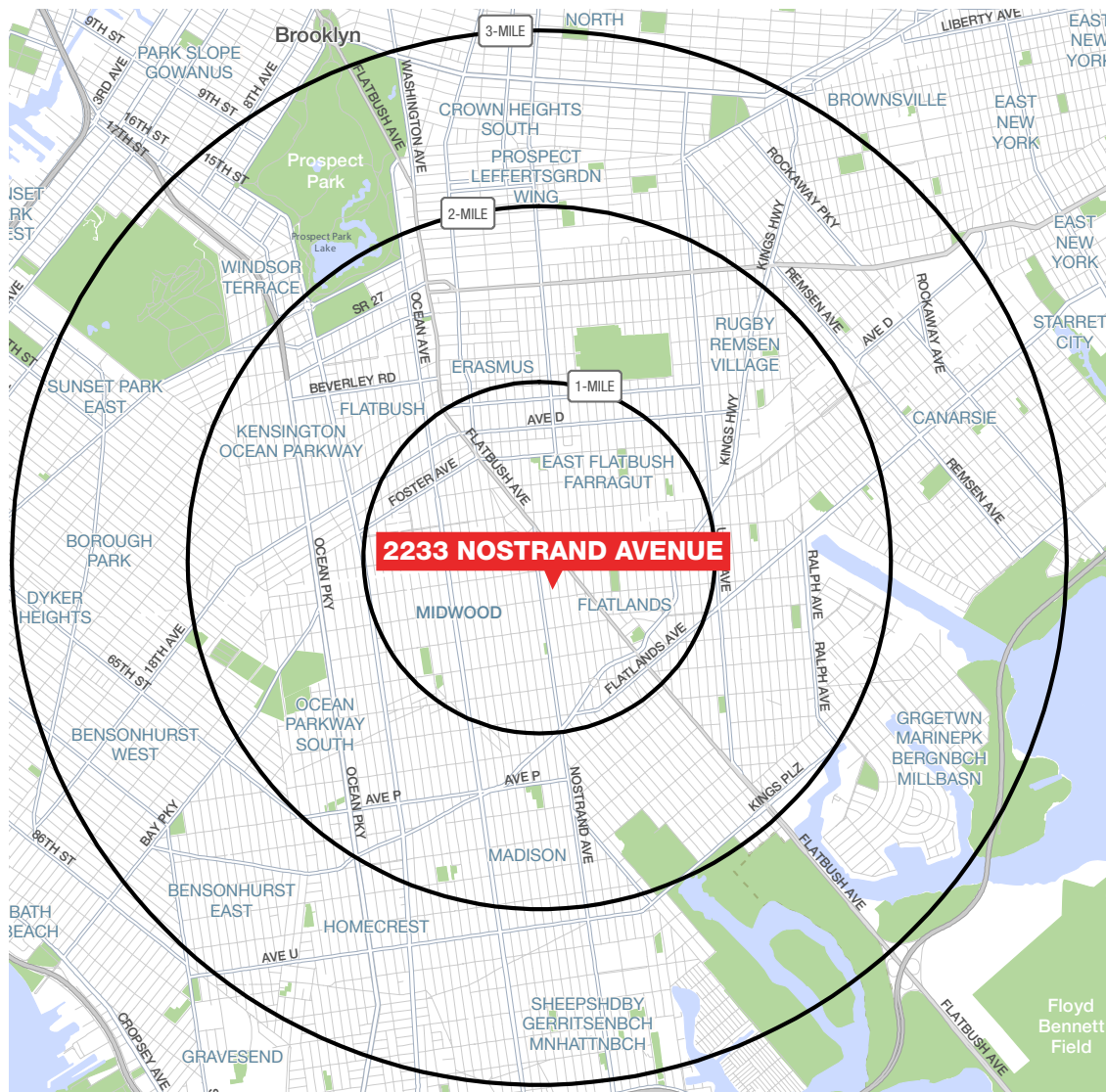

## TOTAL POPULATION

1 mile	141,649
2 miles	552,618
3 miles	1,164,428

## DAYTIME POPULATION

1 mile	108,042
2 miles	416,115
3 miles	876,086

## HOUSEHOLD INCOME

1 mile	\$75,934
2 miles	\$73,007
3 miles	\$71,307

2018 numbers

## CONTACT EXCLUSIVE AGENTS

### BARRY FISHBACH

212.331.0115

barry.fishbach@ngkf.com

### ARIC TRAKHTENBERG

212.916.3386

aric.trakhtenberg@ngkf.com



NGKF.COM

© 2019 NEWMARK KNIGHT FRANK RETAIL. The information contained herein has been obtained from sources deemed reliable but has not been verified and no guarantee, warranty or representation, either express or implied, is made with respect to such information. Terms of sale or lease and availability are subject to change or withdrawal without notice.