

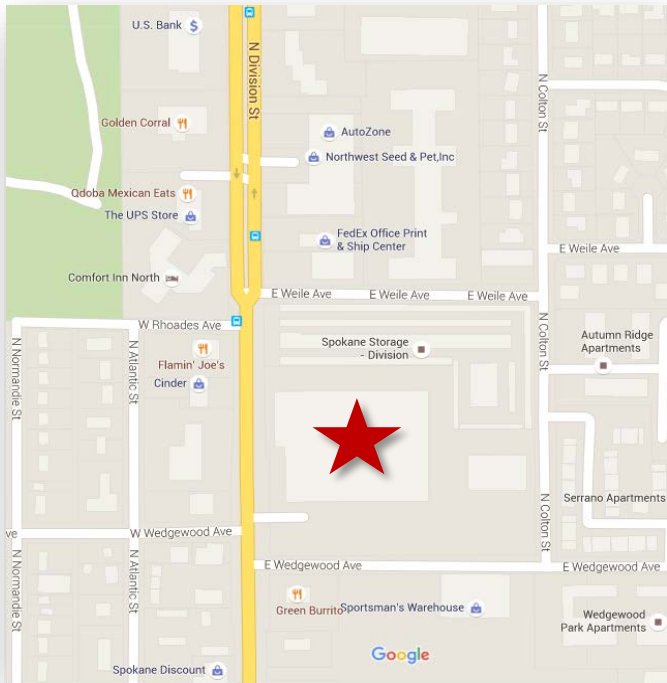

6902 N. Division, Spokane, WA 99208



Property Features

- Space Available:
 - Main Store: 136,409 SF ±
 - 116,000 SF Ground Floor
 - 9,959 SF Mezzanine
 - 10,450 SF Garden Dept.
 - Warehouse: 23,860 SF ±
 - 17,000 SF Ground Floor
 - 6,860 SF Mezzanine
- Lot Size: 8.65 Acres ±
- Ample Parking On-Site
- Parcel Number: 36293.0062
- Excellent Visibility & Access from Division Street – One of Spokane's Busiest North/South Arterials (39,000 ADT)
- Neighboring Businesses include Lowe's, Hobby Lobby, Sportsman's Warehouse, Comfort Inn, Etc.

Chris Bell, SIOR

+1 509 622 3538 • cbell@naiblack.com

Site Plan

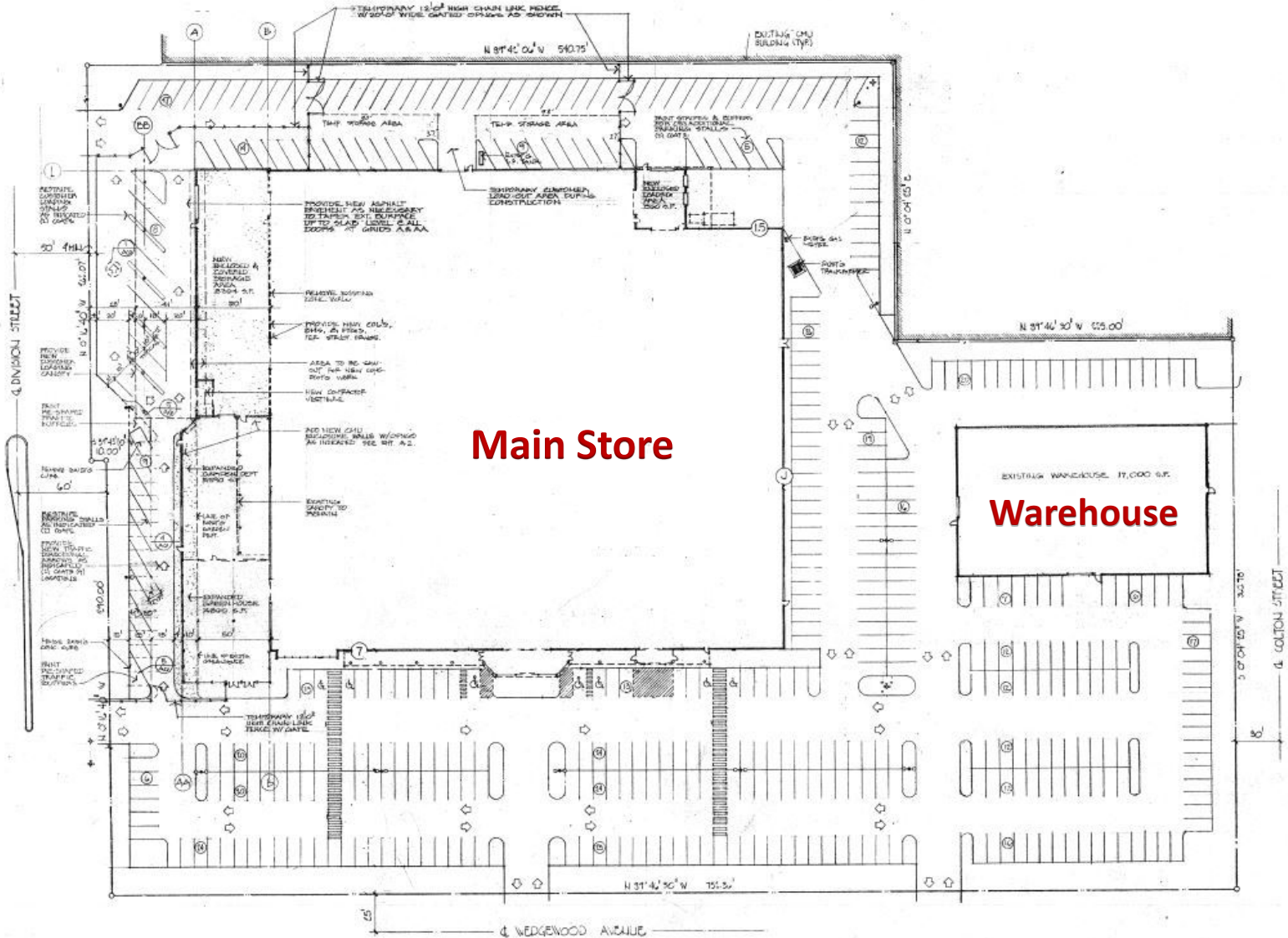

For More Information:

Chris Bell

+1 509 622 3538 • cbell@naiblack.com

NO WARRANTY OR REPRESENTATION, EXPRESS OR IMPLIED, IS MADE AS TO THE ACCURACY OF THE INFORMATION CONTAINED HEREIN, AND THE SAME IS SUBMITTED SUBJECT TO ERRORS, OMISSIONS, CHANGE OF PRICE, RENTAL OR OTHER CONDITIONS, PRIOR SALE, LEASE OR FINANCING, OR WITHDRAWAL WITHOUT NOTICE, AND OF ANY SPECIAL LISTING CONDITIONS IMPOSED BY OUR PRINCIPALS NO WARRANTIES OR REPRESENTATIONS ARE MADE AS TO THE CONDITION OF THE PROPERTY OR ANY HAZARDS CONTAINED THEREIN OR ANY TO BE IMPLIED.

6902 N. Division

