

Redmond East Business Campus

Building
18

6222 185th Ave NE | Redmond, WA

PLUG & PLAY OFFICE SPACE FOR SUBLEASE

22,082 SF FULL FLOOR OFFICE

SPACE AVAILABLE

- Floor 2 - Suite 200
- **Furnished** office
- 25 private offices
- 5 conference rooms
- 99 work stations
- Showers/lockers
- Master lease expires 4/30/2027
- Strong credit sublessor
- Direct deal may be possible as well



Close proximity to retail centers, Whole Foods, restaurants, & residential neighborhoods



High-tech business park environment with nicely built-out office finishes



Parking ratio: 3.0/1,000



Close proximity to SR-520 and Marymoor Park



For more information, please contact:

Paul Jerue
425.646.5223
jerue@broderickgroup.com

Tyler Slone
425.274.4281
slone@broderickgroup.com



10500 NE 8th Street, Suite 900
Bellevue, Washington 98004
broderickgroup.com

22,082 SF FULL FLOOR OFFICE SPACE AVAILABLE

- Floor 2 - Suite 200
- **Furnished** office
- 25 private offices
- 5 conference rooms
- 99 work stations
- Showers/lockers
- Master lease expires 4/30/2027
- Strong credit sublessor
- Direct deal may be possible as well



For more information, please contact:



10500 NE 8th Street, Suite 900
Bellevue, Washington 98004
broderickgroup.com

Paul Jerue
425.646.5223
jerue@broderickgroup.com

Tyler Slone
425.274.4281
slone@broderickgroup.com

22,082 SF FULL FLOOR OFFICE SPACE AVAILABLE

- Floor 2 - Suite 200
- **Furnished** office
- 25 private offices
- 5 conference rooms
- 99 work stations
- Showers/lockers
- Master lease expires 4/30/2027
- Strong credit sublessor
- Direct deal may be possible as well

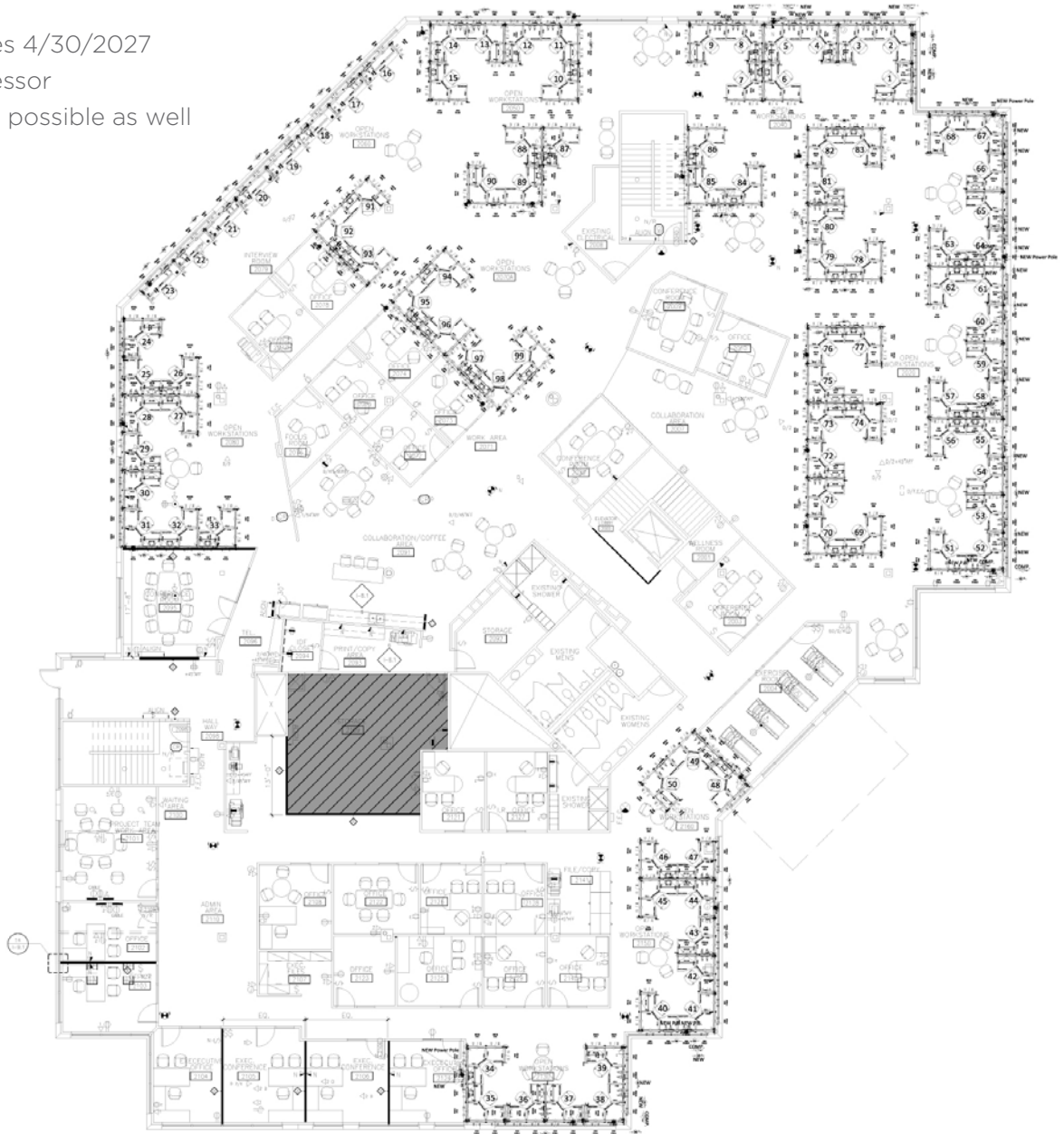

For more information, please contact:

Paul Jerue
425.646.5223
jerue@broderickgroup.com

Tyler Slone
425.274.4281
slone@broderickgroup.com



10500 NE 8th Street, Suite 900
Bellevue, Washington 98004
broderickgroup.com

Redmond East Business Campus

Building 18

FOR SUBLEASE

22,082 SF Sublease Available immediately

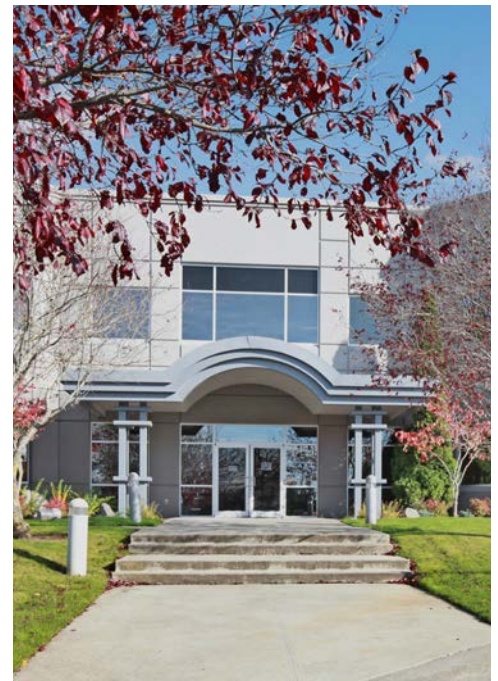
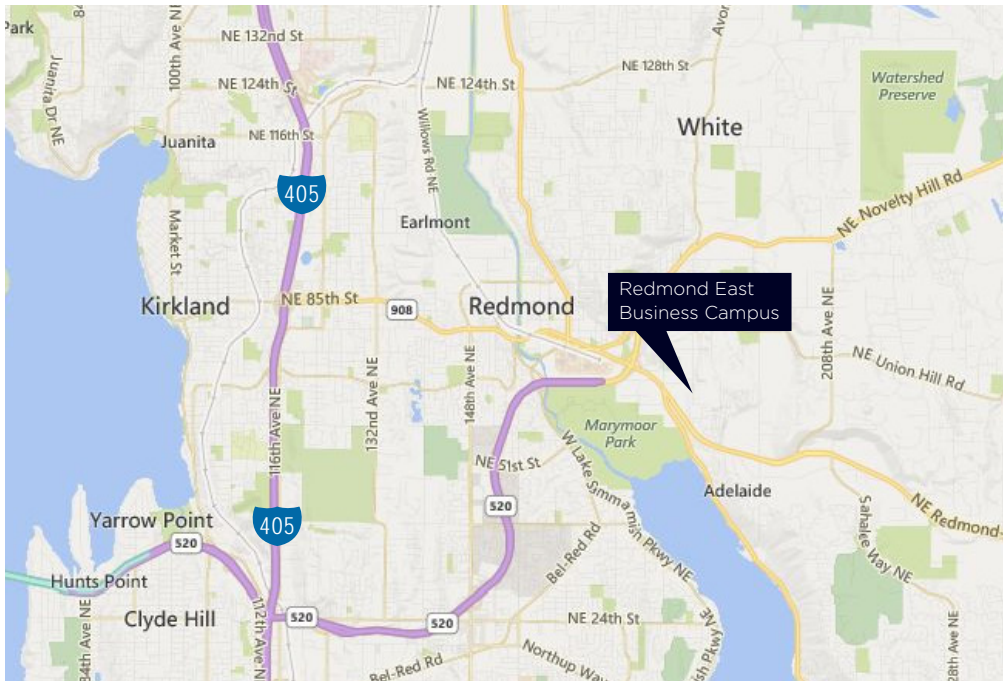
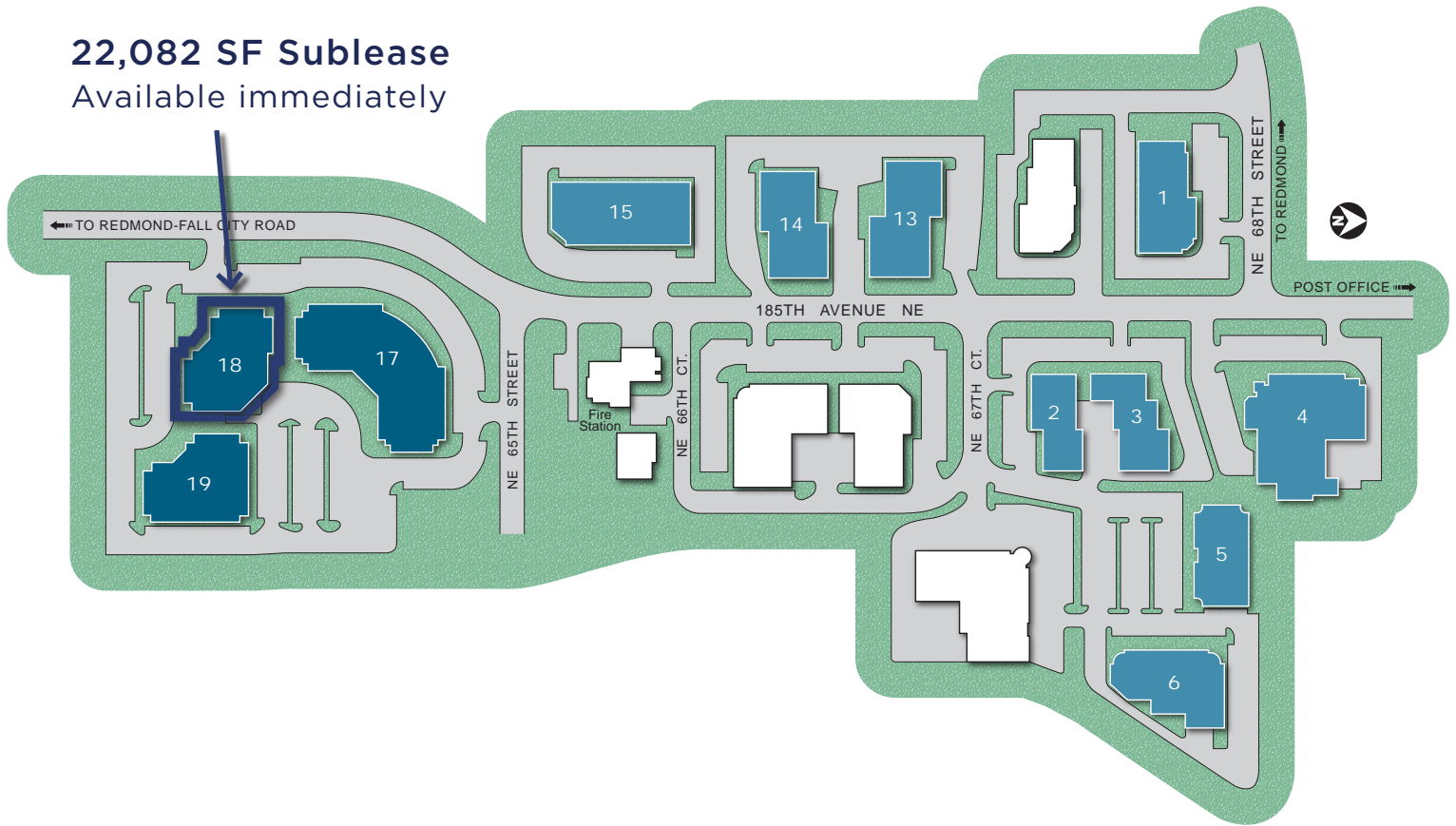

For more information, please contact:



10500 NE 8th Street, Suite 900
 Bellevue, Washington 98004
broderickgroup.com

Paul Jerue
 425.646.5223
jerue@broderickgroup.com

Tyler Slone
 425.274.4281
slone@broderickgroup.com

Redmond East Business Campus

Building
18

FOR SUBLEASE



10500 NE 8th Street, Suite 900
Bellevue, Washington 98004
broderickgroup.com

For more information, please contact:

Paul Jerue
425.646.5223
jerue@broderickgroup.com

Tyler Slone
425.274.4281
slone@broderickgroup.com