

# OFFICE SUITE FOR LEASE

## COOK STREET BUSINESS AREA

**LATE  
SUMMER  
SPECIAL!  
CALL FOR  
PRICING**



**Excellent Location!**



**42575 Melanie Place, Palm Desert, CA**  
*Off Cook Street & Sheryl Avenue*

Beautiful Landscaping (Park-like Setting with Mature Trees) • Great Street Frontage  
Plenty of Parking • Zoned Commercial



**\$UMMER \$PECIAL!**  
CALL US FOR PRICING

<del>Suite A &amp; B</del>	<del>LEASED</del>	<del>Approx. 2,120 SF</del>
<del>Suite C &amp; D</del>	<del>LEASED</del>	<del>Approx. 2,280 SF</del>
<del>Storage</del>	<del>LEASED</del>	<del>Approx. 1,000 SF</del>
<del>Suite E</del>	<del>LEASED</del>	<del>Approx. 1,000 SF</del>
<b>Suite F</b>		<b>Approx. 1,000 SF</b>
<del>Suite G</del>	<del>LEASED</del>	<del>Approx. 1,000 SF</del>
<del>Suite H</del>	<del>LEASED</del>	<del>Approx. 1,000 SF</del>
<del>Suite J</del>	<del>LEASED</del>	<del>Approx. 1,000 SF</del>
<del>Suite I</del>	<del>LEASED</del>	<del>Approx. 1,000 SF</del>
<del>Suite K/L/M/N</del>	<del>LEASED</del>	<del>Approx. 4,000 SF</del>
<del>Suite O</del>	<del>LEASED</del>	<del>Approx. 1,525 SF</del>
<del>*Suite S</del>	<del>LEASED</del>	<del>Approx. 1,400 SF</del>
<del>Storage</del>	<del>LEASED</del>	<del>Approx. 1,000 SF</del>



www.baxleyproperties.com  
Phone: 760-773-3310  
Fax: 760-773-3013  
73712 Alessandro Drive, Ste B-4, Palm Desert, CA 92260

**Donna Rodriguez**  
donna@baxleyproperties.com  
**760-773-6017**

DRE# 01928453

**DISCLAIMER:**

The information above has been obtained from sources believed reliable. While we do not doubt its accuracy, we have not verified it and make no guarantee, warranty or representation about it. It is your responsibility to independently confirm its accuracy and completeness. Any projections, opinions, assumptions or estimates used are for example only, and do not represent the current or future performance of the property.

8/17/2020

# OFFICE SUITE FOR LEASE

FLOORPLAN: 42575 MELANIE PL, PALM DESERT, CA

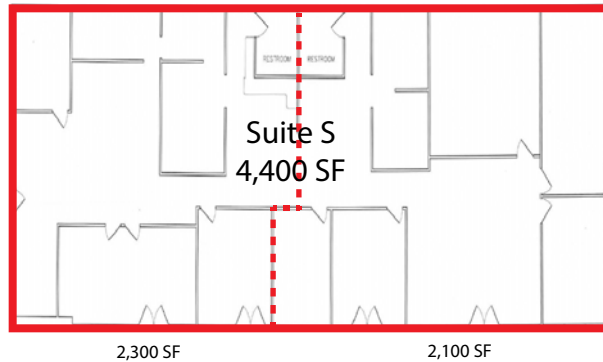
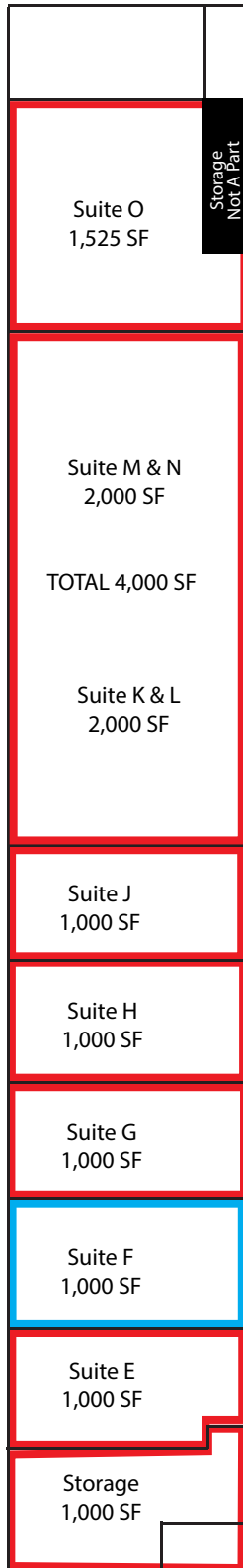

\*Unit S - Can be subdivided on dotted line

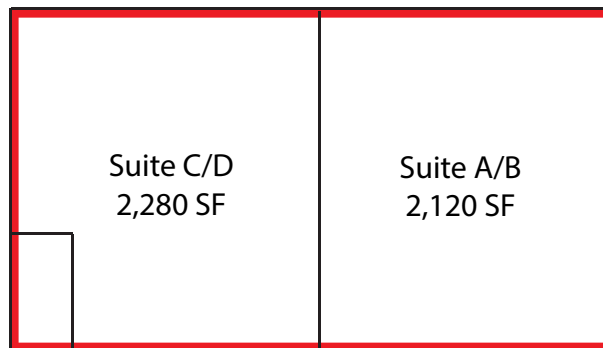

**DISCLAIMER:**

The information above has been obtained from sources believed reliable. While we do not doubt its accuracy, we have not verified it and make no guarantee, warranty or representation about it. It is your responsibility to independently confirm its accuracy and completeness. Any projections, opinions, assumptions or estimates used are for example only, and do not represent the current or future performance of the property.