



Westchester Corporate Plaza FOR LEASE

1800 30th Street • Bakersfield, Ca



Property Highlights

- Located between "F" and "H" Streets at the Golden State Freeway in beautiful Westchester.
- Abundant parking - a unique feature for the downtown area.
- Centralized location with convenient access to major freeways.
- Close to restaurants, retail, legal and medical services.
- Professionally maintained and managed by Premier Management Co.
- Flexible suite sizes and configurations available.
- Monument signage available.

Mark J. Smith, SIOR • Principal • 661 616 3561 • marks@asuassociates.com • CA RE #00632003

Martin J. Starr • Principal • 661 616 3567 • mjstarr@asuassociates.com • CA RE #01179469

Matthew E. Starr, SIOR, CCIM • Principal • 661 616 3570 • matthew@asuassociates.com • CA RE #01367855

11601 Bolthouse Drive Suite 110 • Bakersfield, CA 93311 • 661 862 5454 main • 661 862 5444 fax

Now Leasing ■ Office Property

Westchester Corporate Plaza ■ 1800 30th Street ■ Bakersfield, Ca

Availability & Aerial Map

Available Space

First Floor

- Suite 105 - 619 SF

Second Floor

- Suite 220 - 1,480 SF

Third Floor

- Suite 300 - 3,576 SF
- Suite 310 - 2,248 SF
- Suite 330 - 1,694 SF
- Suite 340 - 841 SF
- Suite 350 - 2,293 SF
- Suite 380 - 2,316 SF

*Up to 9,811 contiguous square feet on the 3rd Floor

Lease Rate

- \$1.55 PSF (excluding utilities and janitorial services)

Tenant Improvements

- Negotiable subject to terms of lease

Existing Tenants Include

- The Law Offices of Young Wooldridge, LLP
- Hanna, Brophy, MacLean, McAleer & Jensen
- Ruetters & Schuler Civil Engineers
- State of California

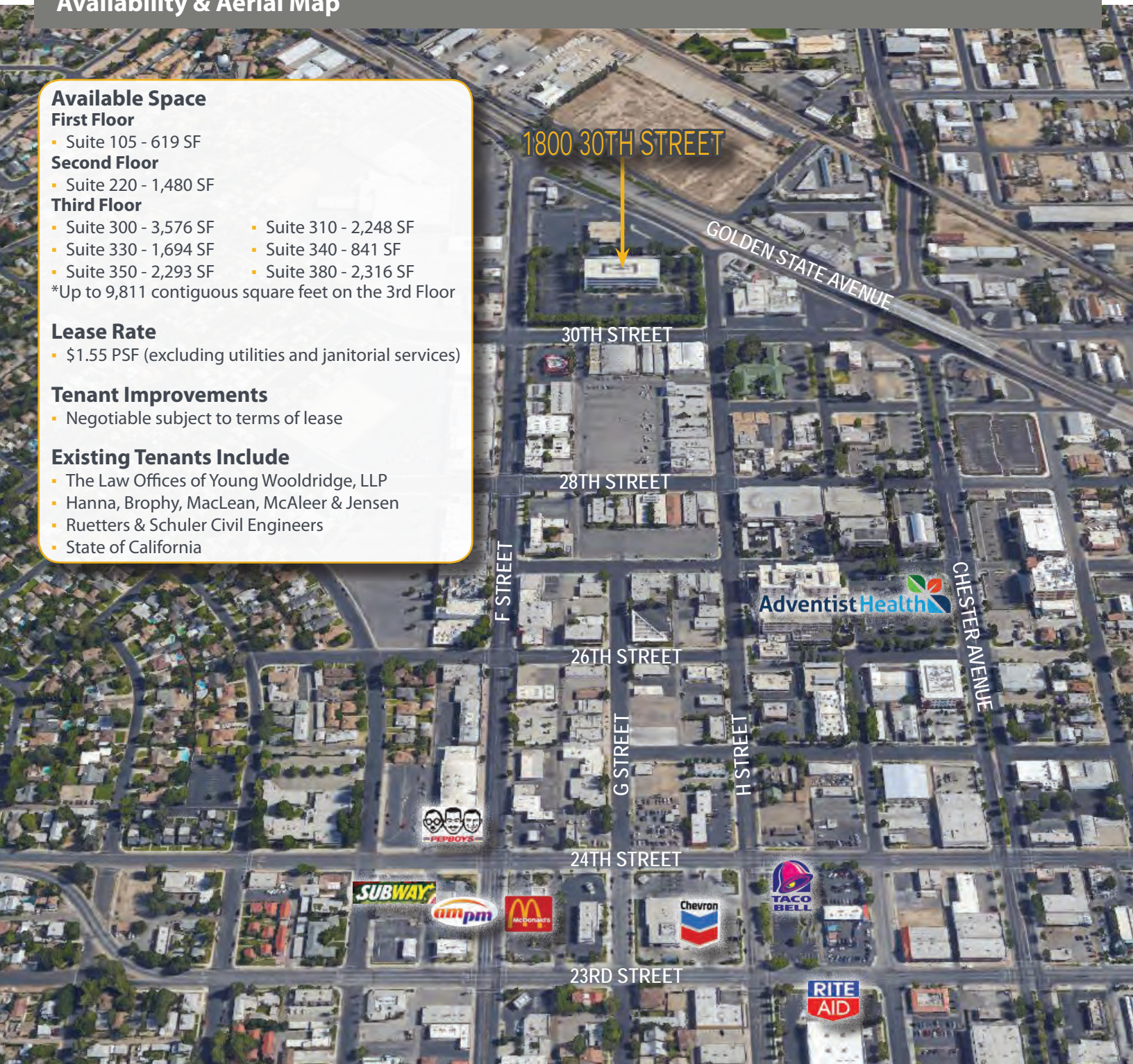

Mark J. Smith, SIOR ■ Principal ■ 661 616 3561 ■ marks@asuassociates.com ■ CA RE #00632003

Martin J. Starr ■ Principal ■ 661 616 3567 ■ mjstarr@asuassociates.com ■ CA RE #01179469

Matthew E. Starr, SIOR, CCIM ■ Principal ■ 661 616 3570 ■ matthew@asuassociates.com ■ CA RE #01367855

11601 Bolthouse Drive Suite 110 ■ Bakersfield, CA 93311 ■ 661 862 5454 main ■ 661 862 5444 fax



Now Leasing • Office Property

Westchester Corporate Plaza • 1800 30th Street • Bakersfield, Ca

Floor Plans

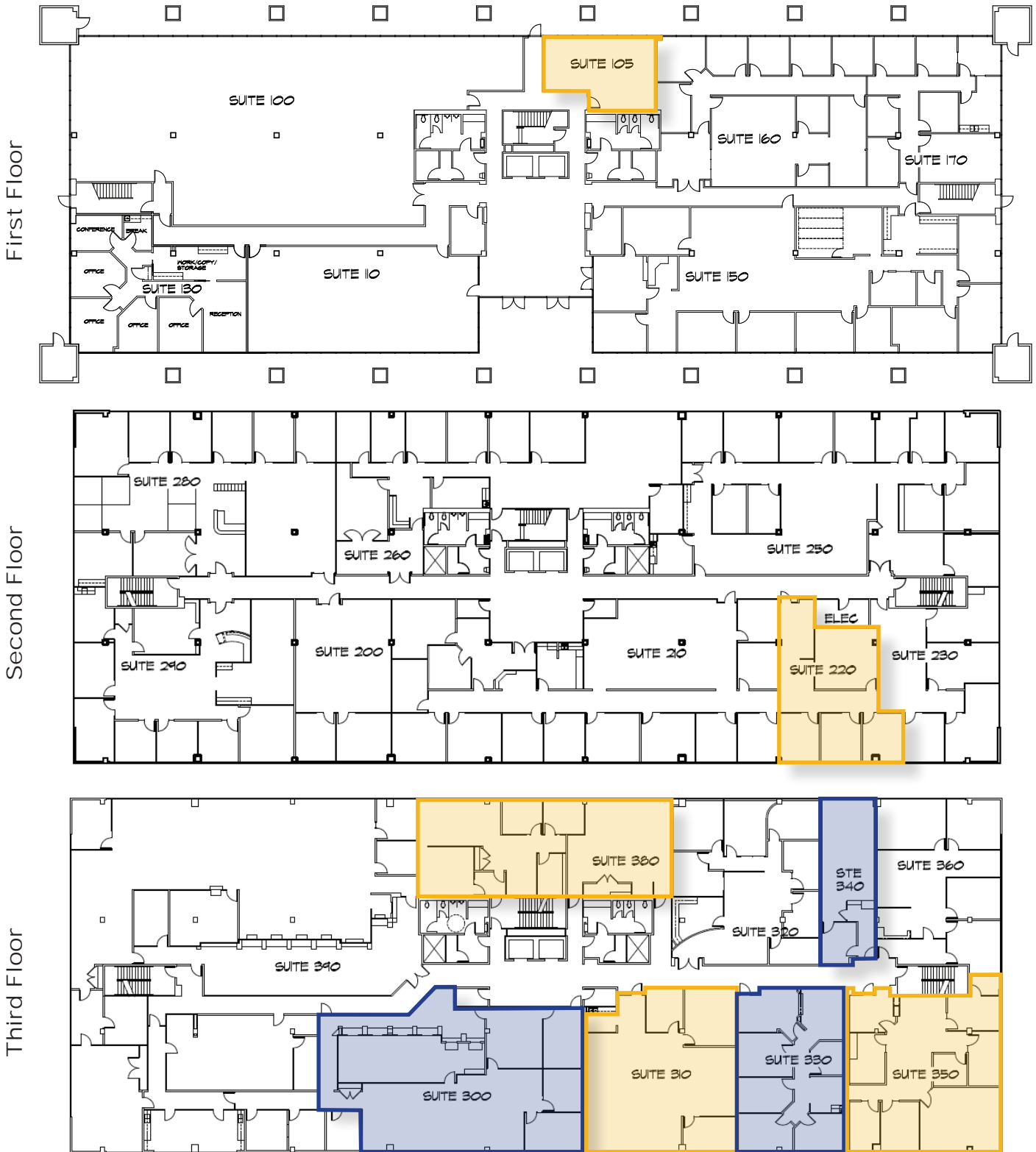

*Plans deemed to be accurate, but not guaranteed. Plan not to scale.

Mark J. Smith, SIOR • Principal • 661 616 3561 • marks@asuassociates.com • CA RE #00632003

Martin J. Starr • Principal • 661 616 3567 • mjstarr@asuassociates.com • CA RE #01179469

Matthew E. Starr, SIOR, CCIM • Principal • 661 616 3570 • matthew@asuassociates.com • CA RE #01367855

