

UNION SQUARE/
CHELSEA

NEW YORK
NY

54
**WEST
14TH
STREET**



SPACE DETAILS

LOCATION

South block between Fifth and Sixth Avenues

APPROXIMATE SIZE

| | |
|--------------|----------|
| Ground Floor | 2,500 SF |
| Basement | 2,000 SF |
| Mezzanine | 750 SF |
| Total | 5,750 SF |

TERM

Long Term

POSSESSION

Arranged

FRONTAGE

24 FT on West 14th Street

SITE STATUS

Currently DQ Grill & Chill

NEIGHBORS

Five Guys, Foot Locker, Starbucks, Urban Outfitters, Guitar Center, Fithouse, Republic Bank, HU Kitchen, TD Bank and CVS Pharmacy

COMMENTS

Full building branding opportunity with venting in place

All uses considered

Steps from the 1 2 3 F M L subway lines

Located on the border of Union Square and Chelsea neighborhoods

In close proximity to The New School, Parsons School of Design and Cardozo Law School

Located across from two brand new, state-of-the-art luxury condo developments on 14th Street

GROUND FLOOR

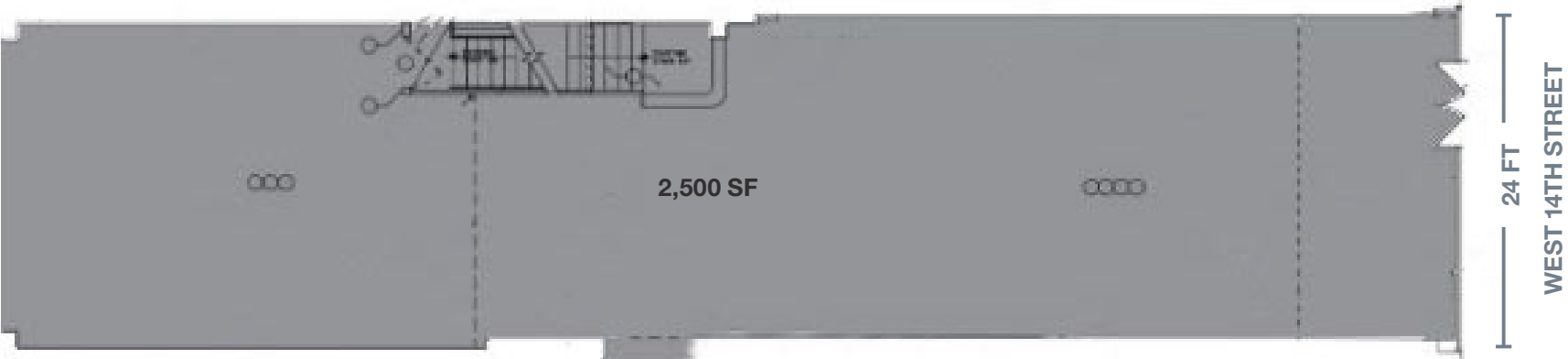

AREA RETAIL

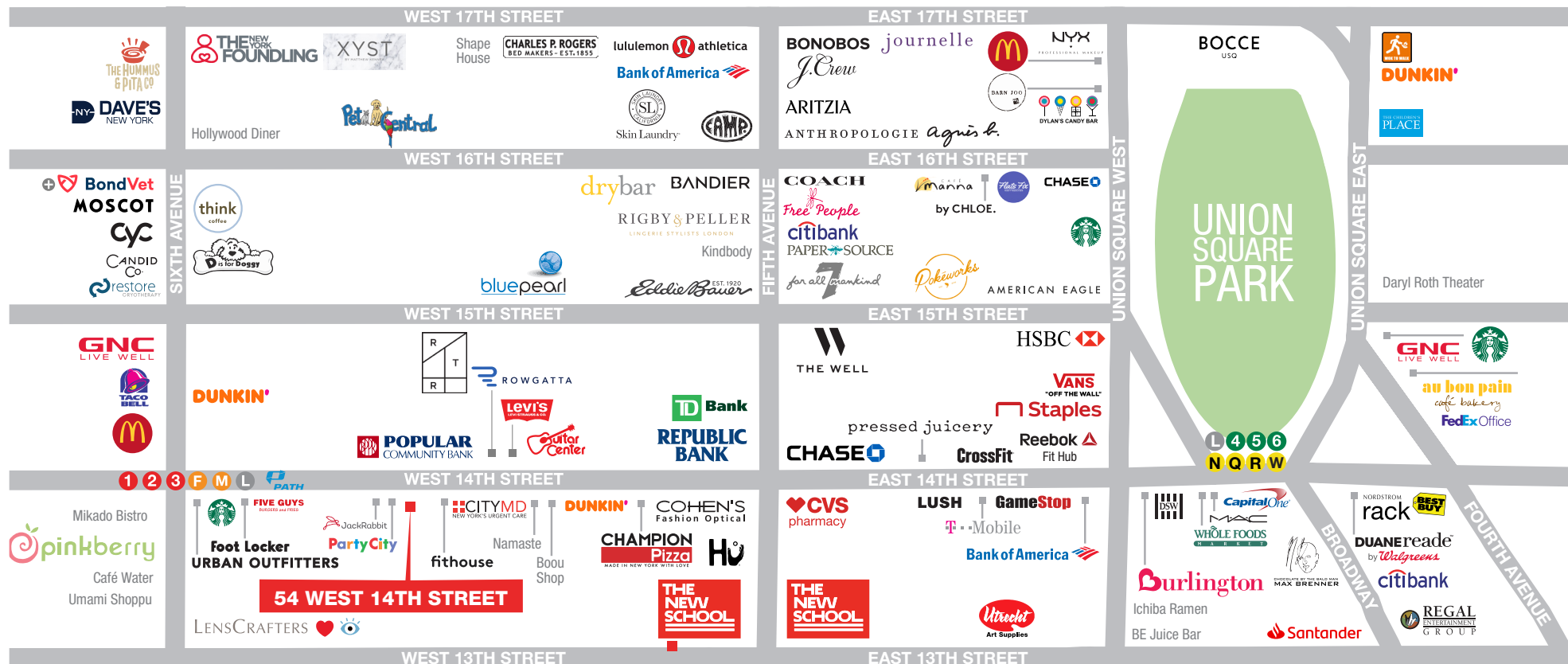

CONTACT EXCLUSIVE AGENTS

MICHAEL PASTER
212.351.9345
michael.paster@ngkf.com

MORGAN BENTIVEGNA
212.916.2932
morgan.bentivegna@ngkf.com



NGKF.COM