

2300 NORTH LOOP ROAD - ALAMEDA, CA

HIGH IMAGE INDUSTRIAL / MANUFACTURING WAREHOUSE BUILDING FOR LEASE



Harbor Bay Business Park

AVAILABLE APRIL, 2020

±32,458 SF on 2.1 Acres Available

As exclusive agent(s), we are pleased to offer the following space:



PROPERTY HIGHLIGHTS:

- Flexible Zoning: Industrial/Flex/Heavy Manufacturing
- Ideal for Headquarter's Building, Distribution, Food Manufacturing, Flex, R&D, Warehousing
- 32,458 SF on 2.1 Acres - Built in 2005
- 24' - 26' Clear Height
- 2 Docks / 2 Grade Level Doors
- Sprinkler Density - .495/2,000
- Power - 1,000 Amp 480V 3 Phase
- Insulated Warehouse
- Mezzanine Food Grade Lab
- 5,958 SF of Open Office w/ Multiple Privates
- 52 Parking Spaces
- Outdoor Patio/EV Charging Station
- Full Kitchen/Breakroom
- Rent: \$1.50/SF NNN



Steve Kapp, SIOR 510.300.0213 skapp@ngkf.com CA RE Lic. #01069911

Shawn Klein 510.923.6209 sklein@ngkf.com CA RE Lic. #01426551

1111 Broadway, Suite 100, Oakland, CA 94607

www.ngkf.com

The distributor of this communication is performing acts for which a real estate license is required. The information contained herein has been obtained from sources deemed reliable but has not been verified and no guarantee, warranty or representation, either express or implied, is made with respect to such information. Terms of sale or lease and availability are subject to change or withdrawal without notice.

2300 NORTH LOOP ROAD - ALAMEDA, CA

HIGH IMAGE INDUSTRIAL / MANUFACTURING WAREHOUSE BUILDING FOR LEASE

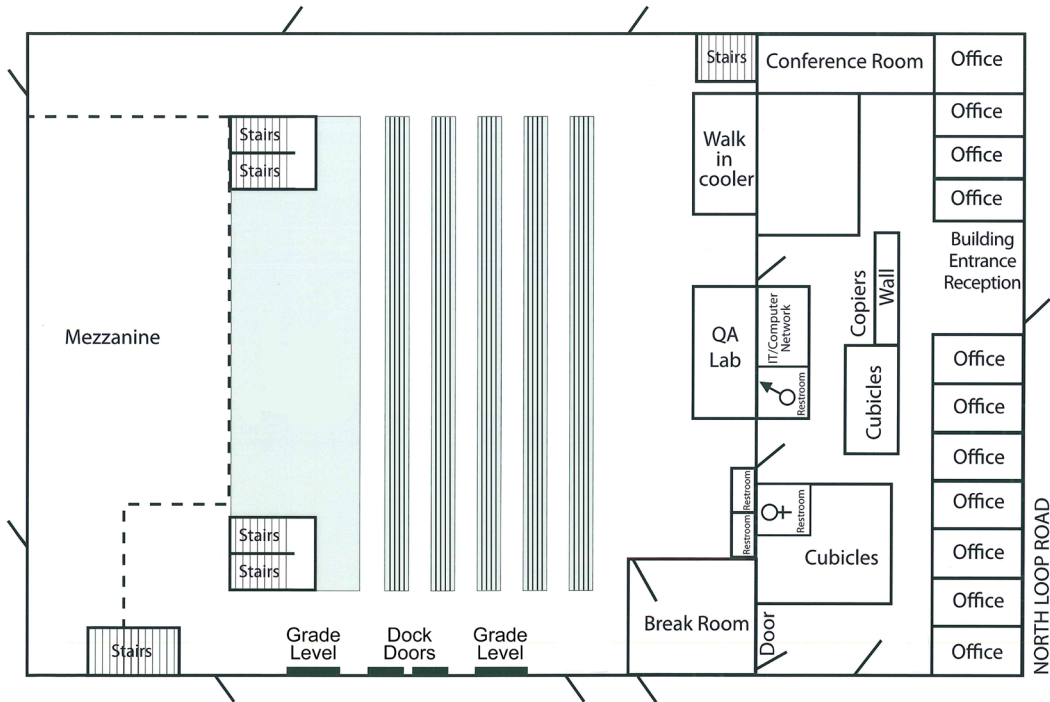

Steve Kapp, SIOR 510.300.0213 skapp@ngkf.com CA RE Lic. #01069911

Shawn Klein 510.923.6209 sklein@ngkf.com CA RE Lic. #01426551

1111 Broadway, Suite 100, Oakland, CA 94607

www.ngkf.com

The distributor of this communication is performing acts for which a real estate license is required. The information contained herein has been obtained from sources deemed reliable but has not been verified and no guarantee, warranty or representation, either express or implied, is made with respect to such information. Terms of sale or lease and availability are subject to change or withdrawal without notice.

2300 NORTH LOOP ROAD - ALAMEDA, CA

HIGH IMAGE INDUSTRIAL / MANUFACTURING WAREHOUSE BUILDING FOR LEASE



ALAMEDA ADVANTAGES:

- Central to Bay Area, San Francisco, Peninsula & Oakland
- Well Maintained Business Park
- Low Business Taxes
- Ferry & Freeway Access to San Francisco & I-880; Free BART Shuttle
- Bay Views of San Francisco
- Minutes to Oakland Airport



Steve Kapp, SIOR 510.300.0213 skapp@ngkf.com CA RE Lic. #01069911
 Shawn Klein 510.923.6209 sklein@ngkf.com CA RE Lic. #01426551
 1111 Broadway, Suite 100, Oakland, CA 94607 www.ngkf.com

The distributor of this communication is performing acts for which a real estate license is required. The information contained herein has been obtained from sources deemed reliable but has not been verified and no guarantee, warranty or representation, either express or implied, is made with respect to such information. Terms of sale or lease and availability are subject to change or withdrawal without notice.