

PRIME RETAIL SPACE ADJACENT TO KOHL'S

Charlottesville, VA 22911 | 396 Towncenter Drive | Seminole Trail & Town Center Dr | #1408



AVAILABLE SF:
24,300 SF

FRONTAGE:
APPROX 98' 0"

ZONING:
COMMERCIAL

RATES:
CALL FOR DETAILS

AREA ANCHORS



- 24,300 SF of Jr. Anchor Space located beside Kohl's and adjacent to Hollymead Town Center
- Located directly off of State Route 29 (Seminole Trail), which is the main thoroughfare through the Charlottesville market
- Convenient access with multiple full access points from US 29
- Close proximity to the University of Virginia with 22,805 students and 16,788 faculty/staff

DEMOGRAPHICS	1 MILE	3 MILES	5 MILES	TRAFFIC COUNTS
2018 Population Density	3,764	14,275	40,334	Seminole Trail
2018 Daytime Population	2,315	9,548	25,146	44,000 AADT
2018 Average HH Income	88,809	107,892	97,744	
2018 Median HH Income	77,519	87,512	74,072	



FOR MORE INFORMATION, CONTACT EXCLUSIVE AGENT(S):
KAREN MIKULSKI • karen.mikulski@tscg.com • 757.722.2500
CHRISTINA MAYHUGH • christina.mayhugh@tscg.com • 804.673.1100

Demographics: Esri 2018 No warranty expressed or implied has been made as to the accuracy of the information provided herein, no liability assumed for error or omissions.



PRIME RETAIL SPACE ADJACENT TO KOHL'S

Charlottesville, VA 22911 | 396 Towncenter Drive | Seminole Trail & Town Center Dr | #1408



FOR MORE INFORMATION, CONTACT EXCLUSIVE AGENT(S):
KAREN MIKULSKI • karen.mikulski@tscg.com • 757.722.2500
CHRISTINA MAYHUGH • christina.mayhugh@tscg.com • 804.673.1100



Demographics: Esri 2018 No warranty expressed or implied has been made as to the accuracy of the information provided herein, no liability assumed for error or omissions.

PRIME RETAIL SPACE ADJACENT TO KOHL'S

Charlottesville, VA 22911 | 396 Towncenter Drive | Seminole Trail & Town Center Dr | #1408

#11408 Charlottesville, VA
Updated: 12/11/17

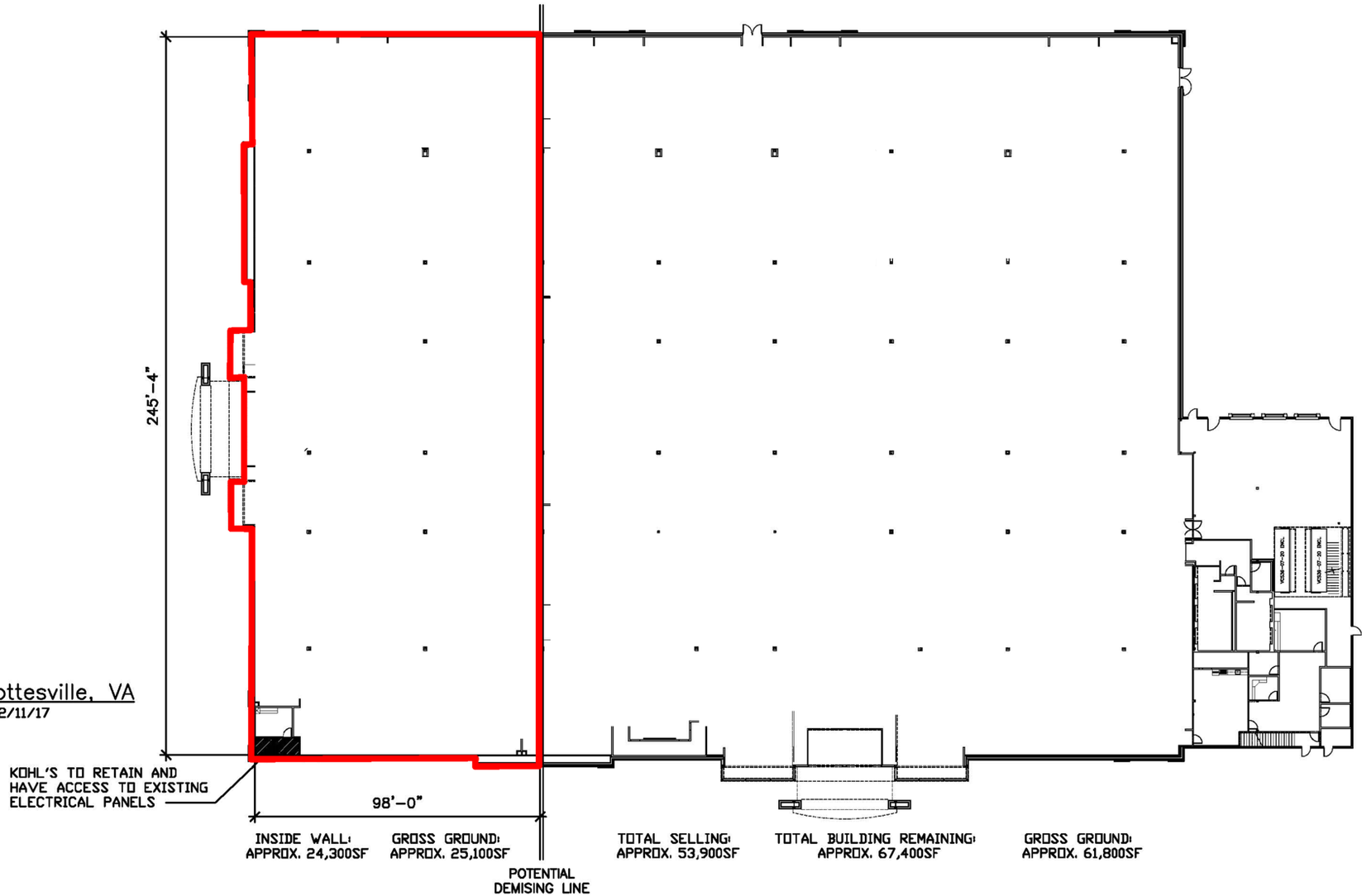

FOR MORE INFORMATION, CONTACT EXCLUSIVE AGENT(S):
KAREN MIKULSKI • karen.mikulski@tscg.com • 757.722.2500
CHRISTINA MAYHUGH • christina.mayhugh@tscg.com • 804.673.1100

