

First Grand Parkway Commerce Center

SWQ of Grand Parkway & Morton Ranch Rd.
Katy, Texas

TWO REAR LOAD DISTRIBUTION BUILDINGS FOR LEASE



173,045 SF & 198,905 SF AVAILABLE

WEST HOUSTON'S NEWEST DEVELOPMENT

NEW CONSTRUCTION • GREAT VISIBILITY • DIRECT ACCESS TO HWY 99

BUILDING 1

- 173,045 SF - divisible
- 301 parking spaces (expandable up to 365)
- 130' truck court
- 46'-8" x 52' column spacing (60' speed bay)
- 32' clear height

BUILDING 2

- 198,905 SF - divisible
- 310 parking spaces
- 130' truck court
- 56'-8" x 52' column spacing (60' speed bay)
- 32' clear height

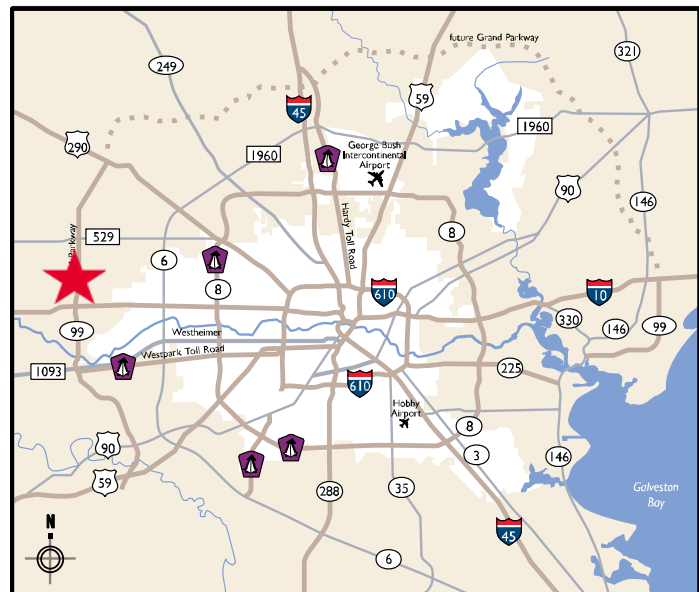

Allison Bergmann
Director

+1 713 963 2865

allison.bergmann@cushwake.com



Beau Kaleel
Senior Director
+1 713 963 2844

beau.kaleel@cushwake.com



**CUSHMAN &
WAKEFIELD**

FOR LEASE – REAR LOAD

First Grand Parkway Commerce Center

SWQ of Grand Parkway & Morton Ranch Road
Katy, Texas

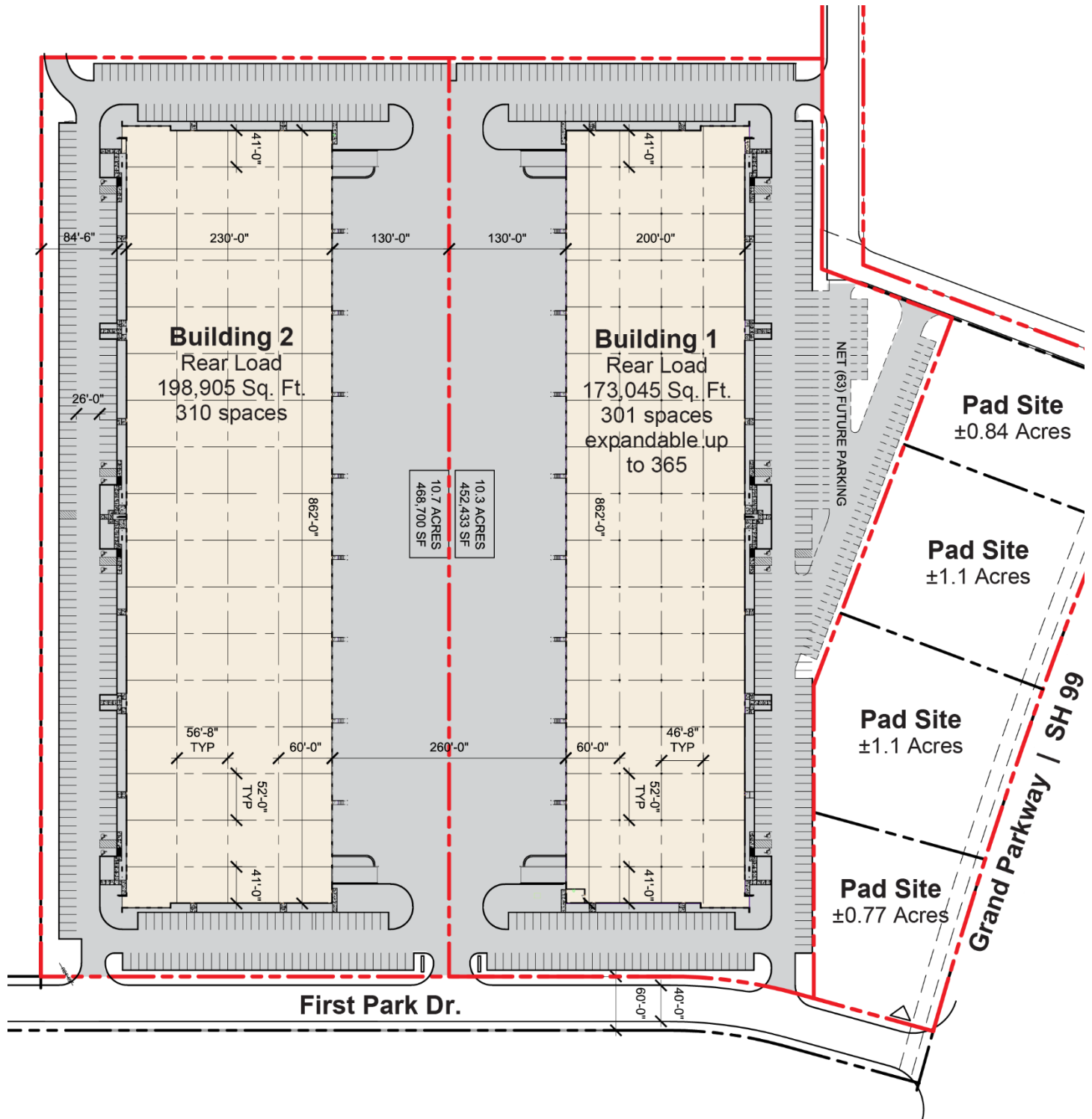

For more information, please contact:

Allison Bergmann

+1 713 963 2865

allison.bergmann@cushwake.com

Beau Kaleel

+1 713 963 2844

beau.kaleel@cushwake.com

Cushman & Wakefield

1330 Post Oak Blvd.

Ste. 2700

Houston, TX 77056

Phone: +1 713 877 1700



**CUSHMAN &
WAKEFIELD**

FOR LEASE – REAR LOAD

First Grand Parkway Commerce Center

SWQ of Grand Parkway & Morton Ranch Road
Katy, Texas



Allison Bergmann
+1 713 963 2865
allison.bergmann@cushwake.com

Beau Kaleel
+1 713 963 2844
beau.kaleel@cushwake.com

1330 Post Oak Blvd.
Ste. 2700
Houston, TX 77056
Phone: +1 713 877 1700

Cushman & Wakefield Copyright 2018. No warranty or representation, express or implied, is made to the accuracy or completeness of the information contained herein, and same is submitted subject to errors, omissions, change of price, rental or other conditions, withdrawal without notice, and to any special listing conditions imposed by the property owner(s). As applicable, we make no representation as to the condition of the property (or properties) in question.