

# RESTAURANT SPACE AVAILABLE IN NEW MIXED USE DEVELOPMENT

550 S. Palos Verdes Street San Pedro, CA 90731

**FOR  
LEASE**



**MARYL "HAIRE" BINNEY**

310.379.2228 x4

Maryl@highlandpartnerscorp.com

**LAURIE WIXTED**

310.514.7411

lauriewixed@gmail.com

2200 Pacific Coast Highway, Suite 316, Hermosa Beach, CA 90254 | 310.379.2228

WIXTED GROUP

**HIGHLAND  
PARTNERS**

© 2017 | Highland Partners Corp. | The information being provided by Highland Partners Corp. and/or its sources is deemed reliable. While we have no reason to doubt its accuracy, we do not guarantee it. Any information, measurements, facts and actual drawings shown are approximate, subject to change, or withdrawal without notice and should be independently verified by you and may not be relied upon as a precise representation by this office. No warranties or representations are made as to the condition of the property or any hazards contained therein nor any to be implied. | Logos are for identification purposes only and may be trademarks of their respective companies. Hawthorne Plaza\_Bro\_v01.indd | 09/18

# RESTAURANT SPACE AVAILABLE IN NEW MIXED USE DEVELOPMENT

550 S. Palos Verdes Street San Pedro, CA 90731

**FOR  
LEASE**



**AVAILABLE: 2,326 & 2,590 SF**

## PROPERTY OVERVIEW

Prime retail/restaurant space that is available in new mixed-use development located in Downtown San Pedro. This new development will contain approximately 4,916 SF of ground floor restaurant space and 375 apartment units. The anticipated delivery date is the 2nd quarter of 2019. The project will be completed 4th quarter of 2019.

## LOCATION DESCRIPTION

The surrounding areas has strong demographics with an average household income of \$98,930 and a population of 112,262 in a 3 mile radius. This highly visible development is located at the intersection of W. 6th St. and S. Palos Verdes St. and is just a few blocks from the water.

DEMOGRAPHICS	1 MILES	3 MILES	5 MILES
Population	29,949	112,262	221,262
Average HH Income	\$55,417	\$98,930	\$101,979
Daytime Population	10,524	31,098	67,785

## HIGHLIGHTS

- New Mixed Use Development with 375 apartment above ground floor retail/ restaurant
- Located in the heart of Downtown San Pedro
- Within walking distance to the water
- Exclusive outdoor patio
- Ample on-grade parking

**MARYL "HAIRE" BINNEY**

310.379.2228 x4

Maryl@highlandpartnerscorp.com

**LAURIE WIXTED**

310.514.7411

lauriewixed@gmail.com

2200 Pacific Coast Highway, Suite 316, Hermosa Beach, CA 90254 | 310.379.2228

WIXTED GROUP

**HIGHLAND  
PARTNERS**

© 2017 | Highland Partners Corp. | The information being provided by Highland Partners Corp. and/or its sources is deemed reliable. While we have no reason to doubt its accuracy, we do not guarantee it. Any information, measurements, facts and actual drawings shown are approximate, subject to change, or withdrawal without notice and should be independently verified by you and may not be relied upon as a precise representation by this office. No warranties or representations are made as to the condition of the property or any hazards contained therein nor any to be implied. | Logos are for identification purposes only and may be trademarks of their respective companies. Hawthorne Plaza\_Bro\_v01.indd | 09/18

# 550 HARBOR FRONT

550 S. Palos Verdes Street San Pedro, CA 90731

**FOR  
LEASE**

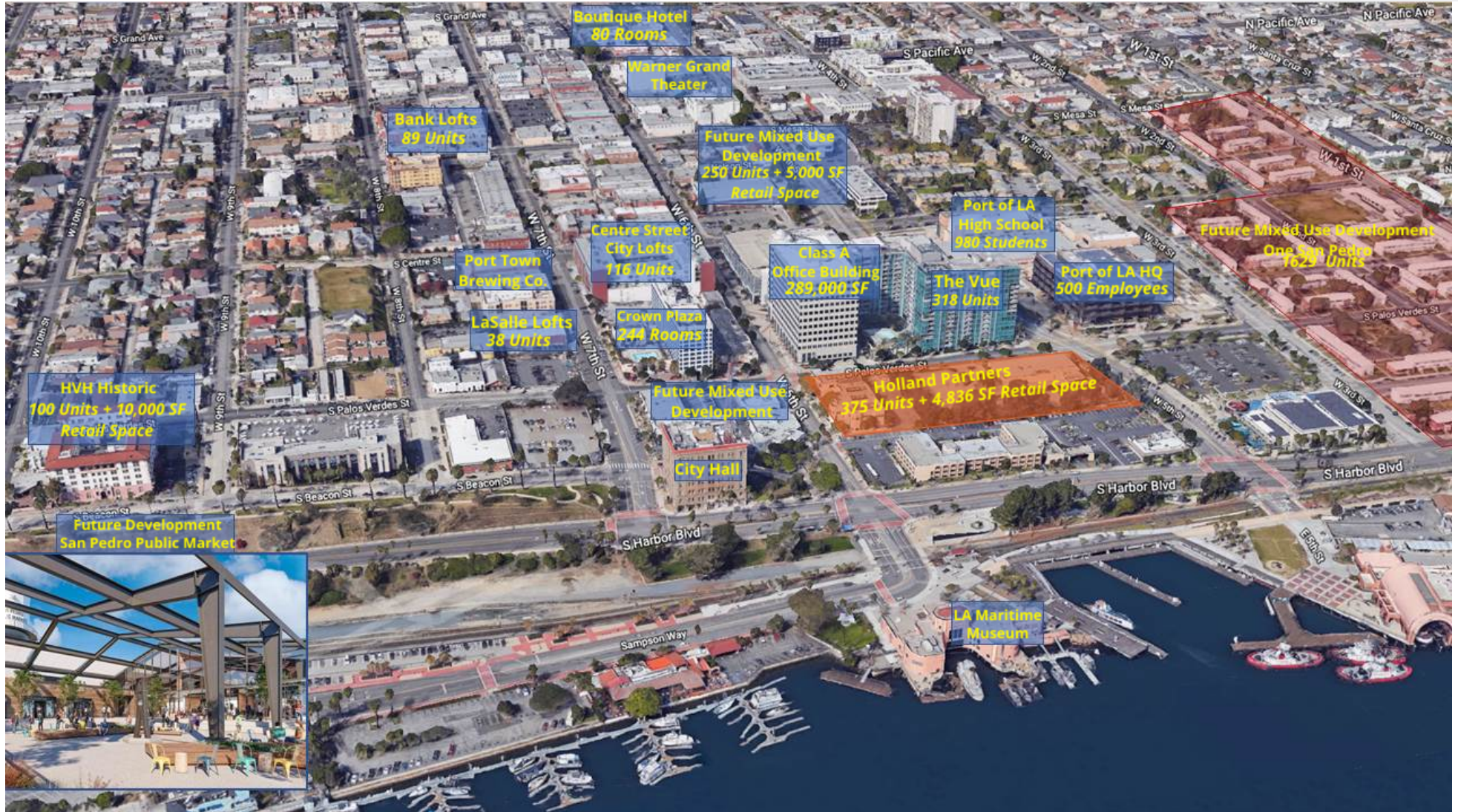

**MARYL "HAIRE" BINNEY**

310.379.2228 x4

Maryl@highlandpartnerscorp.com

**LAURIE WIXTED**

310.514.7411

lauriewixed@gmail.com

2200 Pacific Coast Highway, Suite 316, Hermosa Beach, CA 90254 | 310.379.2228

WIXTED GROUP

**HIGHLAND  
PARTNERS**

© 2017 | Highland Partners Corp. | The information being provided by Highland Partners Corp. and/or its sources is deemed reliable. While we have no reason to doubt its accuracy, we do not guarantee it. Any information, measurements, facts and actual drawings shown are approximate, subject to change, or withdrawal without notice and should be independently verified by you and may not be relied upon as a precise representation by this office. No warranties or representations are made as to the condition of the property or any hazards contained therein nor any to be implied. | Logos are for identification purposes only and may be trademarks of their respective companies. Hawthorne Plaza\_Bro\_v01.indd | 09/18

# 550 HARBOR FRONT

550 S. Palos Verdes Street San Pedro, CA 90731

**FOR  
LEASE**

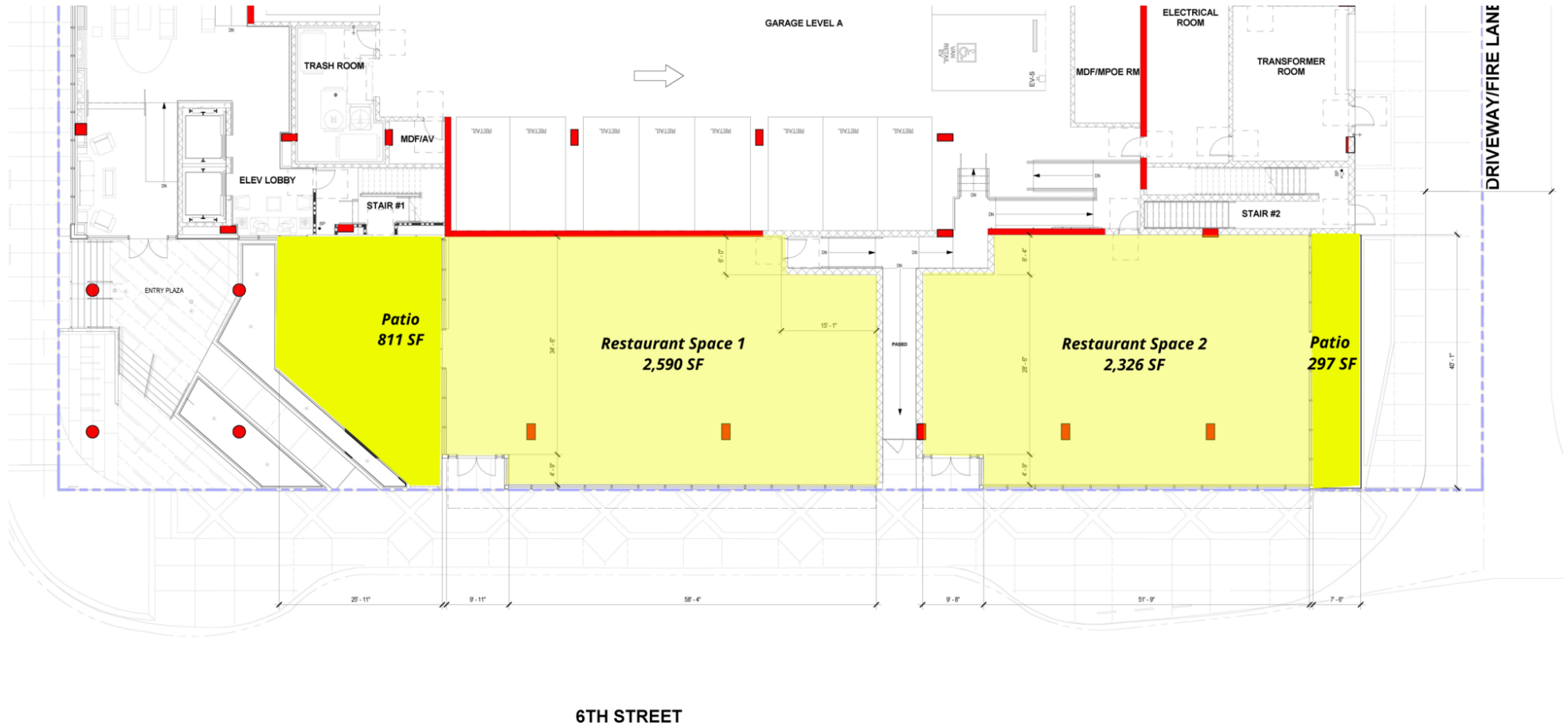

6TH STREET

MARYL "HAIRE" BINNEY  
310.379.2228 x4

Maryl@highlandpartnerscorp.com

LAURIE WIXTED

310.514.7411

lauriewixed@gmail.com

2200 Pacific Coast Highway, Suite 316, Hermosa Beach, CA 90254 | 310.379.2228

WIXTED GROUP

HIGHLAND  
PARTNERS

© 2017 | Highland Partners Corp. | The information being provided by Highland Partners Corp. and/or its sources is deemed reliable. While we have no reason to doubt its accuracy, we do not guarantee it. Any information, measurements, facts and actual drawings shown are approximate, subject to change, or withdrawal without notice and should be independently verified by you and may not be relied upon as a precise representation by this office. No warranties or representations are made as to the condition of the property or any hazards contained therein nor any to be implied. | Logos are for identification purposes only and may be trademarks of their respective companies. Hawthorne Plaza\_Bro\_v01.indd | 09/18