

# INDUSTRIAL/RETAIL LOTS FOR SALE

I-40 & JONES SAUSAGE ROAD  
RALEIGH, NC 27529

## SOUTHEAST 40 CENTRE



## PROPERTY HIGHLIGHTS

### AREA DESCRIPTION

- Located at corner of I-40 and Jones Sausage Road
- High growth industrial and retail area
- Inside Wake County and Raleigh city limits

### HIGHLIGHTS

- Convenient access to I-40
- 97,000 vehicles per day
- Park tenants include: Sunbelt, Roofers Supply of Greenville, H & E Equipment and Petram Measurements
- Major neighboring industrial include Gregory Poole Caterpillar, Pepsi Bottling, United Rental, and FleetPride

- Major neighboring retail include Burger King, Bojangles, Smithfield's, Wilco Hess
- Thoroughfare for Walnut Creek Amphitheater; 270,000 people visit annually
- Potential interstate visibility
- Retail, hotel and industrial sites available

### PROPERTY DESCRIPTION

- Lots ranging from 1-2 acres
- Tractor trailer accessible
- Water and sewer on-site

TRADEMARK  PROPERTIES  
As if it's our own®

### DAN MCCLOY

(919) 270-9587 (Mobile)

(919) 227-5524 (Direct)

[dmccloy@trademarkproperties.com](mailto:dmccloy@trademarkproperties.com)

# INDUSTRIAL/RETAIL LOTS FOR SALE

I-40 & JONES SAUSAGE ROAD  
RALEIGH, NC 27529

## AVAILABLE LOTS

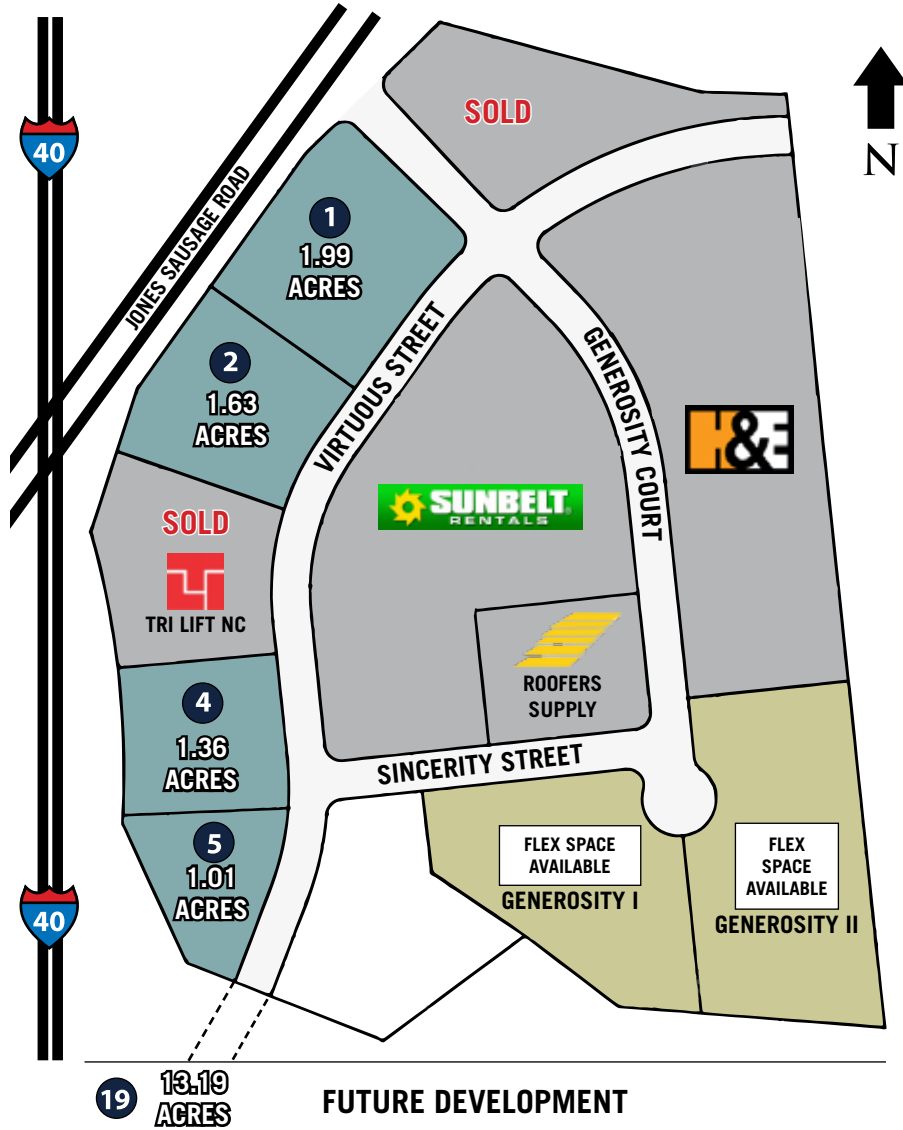

AVAILABLE LOTS				
Lot	Address	Acreage	Price/SF	Price
1	4102 Virtuous Street	1.99	\$11.11/SF	\$963,112
2	4108 Virtuous Street	1.63	\$8.50/SF	\$603,523
4	4124 Virtuous Street	1.36	\$4.57/SF	\$270,508
5	4204 Virtuous Street	1.01	\$4.00/SF	\$175,982
19	0 Jones Sausage Road	13.19	\$1.04/SF	\$597,539