



NORTHMEADOW

View more at
NORTHMEADOWATLANTA.COM



11835 Alpharetta Hwy

Roswell, Georgia 30076

FEATURES

- 15,000 SF Stand-Alone Medical/Office/Retail Building
- Visibility on Alpharetta Hwy
- Monument Signage on Alpharetta Hwy
- Located in Master-Planned Northmeadow Business Park
- 6.0/1,000 Parking Ratio
- Commercial Zoning Allows for a Variety of Uses
- Can Accommodate Tenants from 7,500 to 15,000 SF

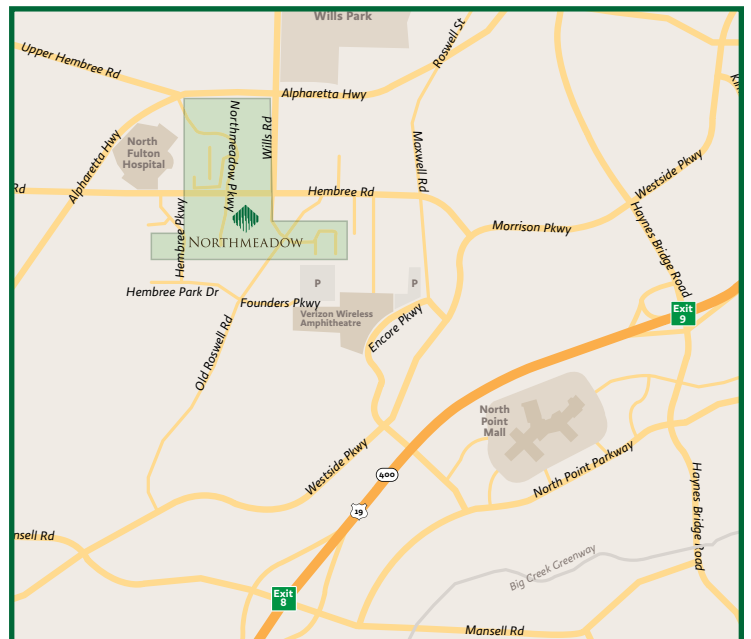

STEPHEN POND

404 812 4067
spond@naibg.com

DAVID BEAK

404 812 4064
dbeak@naibg.com

NAI Brannen Goddard

OWNED BY AN AFFILIATE OF

EQUUS
CAPITAL PARTNERS, LTD.



NORTHMEADOW

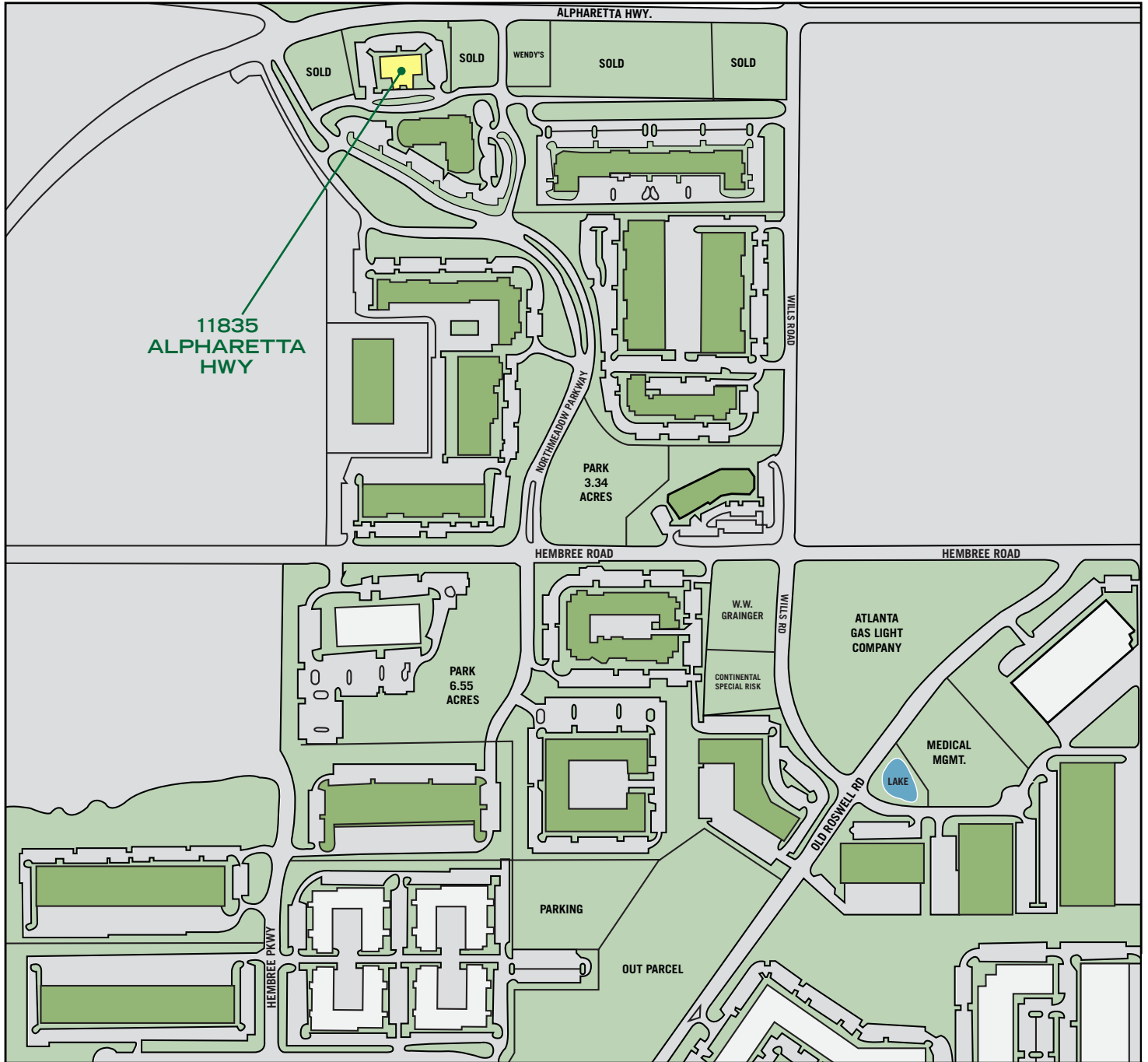

**FOR LEASING
INFORMATION:**

STEPHEN POND

404 812 4067

spond@naibg.com

DAVID BEAK

404 812 4064

dbeak@naibg.com

NAI Brannen Goddard

5555 Glenridge Connector, Suite 1100, Atlanta, GA 30342 | 404 812 4000 | naibg.com

Information is deemed from reliable sources. No warranty is made as to its accuracy.

OWNED BY AN AFFILIATE OF

EQUUS
CAPITAL PARTNERS, LTD.



NORTHMEADOW

11835 ALPHARETTA HWY

15,000 SF

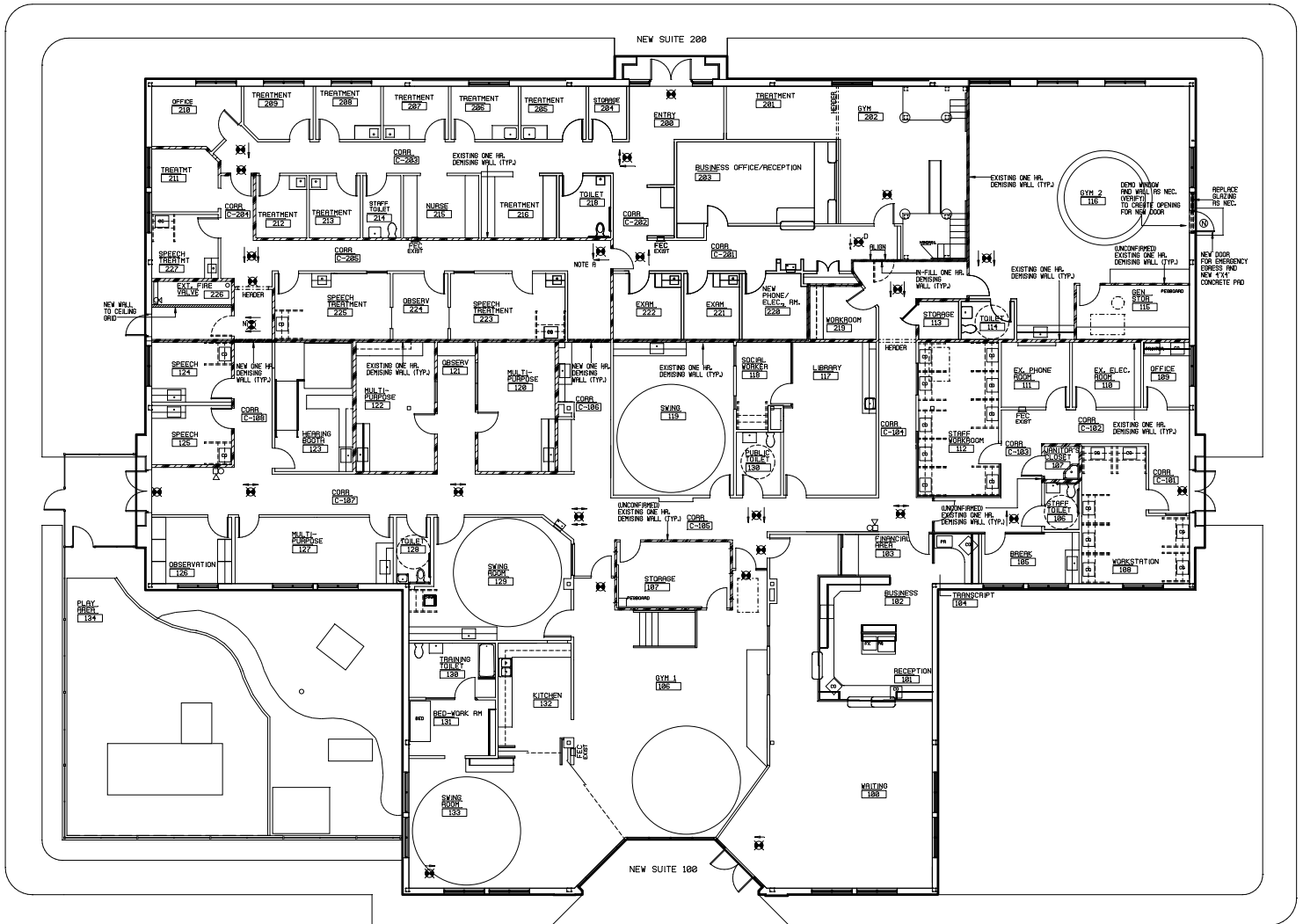

**FOR LEASING
INFORMATION:**

STEPHEN POND
404 812 4067
spond@naibg.com

DAVID BEAK
404 812 4064
dbeak@naibg.com

NAI Brannen Goddard

5555 Glenridge Connector, Suite 1100, Atlanta, GA 30342 | 404 812 4000 | naibg.com

Information is deemed from reliable sources. No warranty is made as to its accuracy.

OWNED BY AN AFFILIATE OF

EQUUS
CAPITAL PARTNERS, LTD.



NORTHMEADOW

11835 ALPHARETTA HWY

15,000 SF

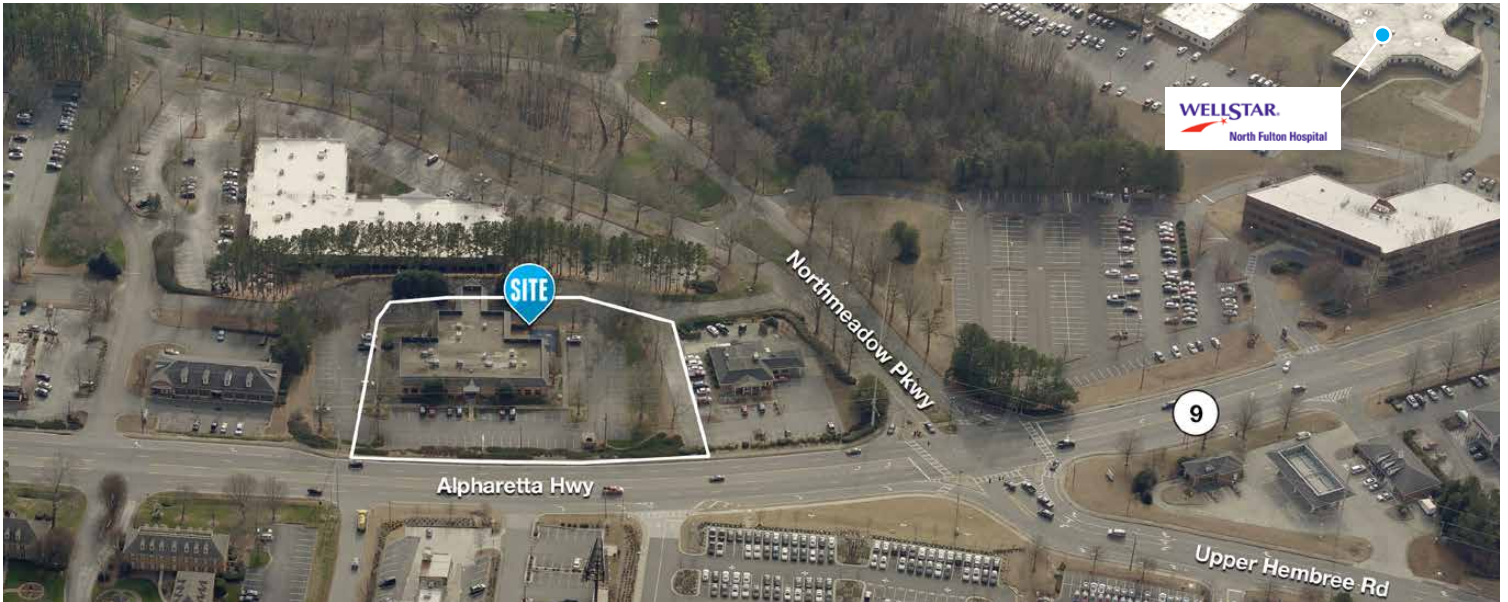

**FOR LEASING
INFORMATION:**

STEPHEN POND

404 812 4067

spond@naibg.com

DAVID BEAK

404 812 4064

dbeak@naibg.com

NAI Brannen Goddard

5555 Glenridge Connector, Suite 1100, Atlanta, GA 30342 | 404 812 4000 | naibg.com

Information is deemed from reliable sources. No warranty is made as to its accuracy.

OWNED BY AN AFFILIATE OF

EQUUS
CAPITAL PARTNERS, LTD.