



THE OFFICES AT

MARTIN DRIVE

FOR LEASE

PROFESSIONAL OFFICE BUILDINGS  
BUILD-TO-SUIT OPTIONS AVAILABLE



1711 Martin Drive Weatherford, TX 76086

**LEASE RATE**

\$24.00 PSF + NNN

Generous TI Package Available

**BUILDING FEATURES**

5.00/1,000 Parking Ratio

Build-to-Suit Opportunities Available

Prominent Street Signage Available

**LOCATION**

1 Mile - Interstate 20

1 Mile - Weatherford Regional Medical Center

2 Miles - Downtown Weatherford

**ZONING**

C-1, City of Weatherford

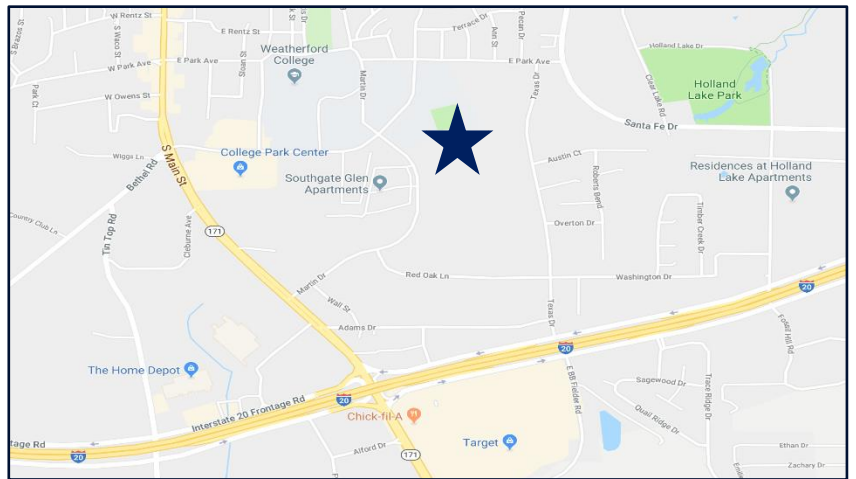

**MAJOR AREA RETAILERS**



FOR MORE INFORMATION

Allison Sibley | 817.713.9382 | asibley@tigusa.com







THE OFFICES AT

# MARTIN DRIVE

# FOR LEASE

## PROFESSIONAL OFFICE BUILDINGS BUILD-TO-SUIT OPTIONS AVAILABLE

### AVAILABILITIES

Building A: **LEASED**

Building B: **LEASED**

Building C: 6,232 SF

Building D: 9,095 SF

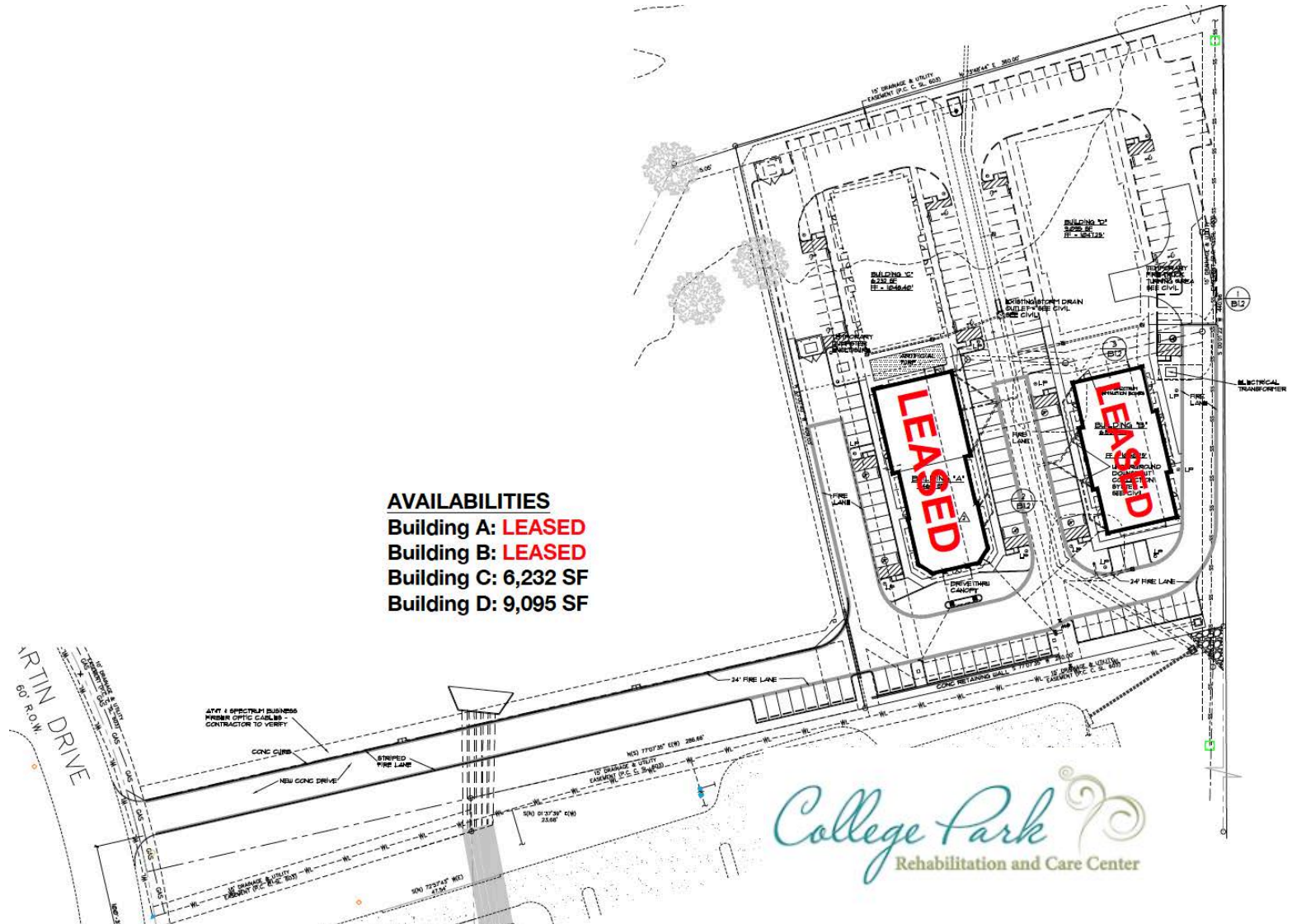

FOR MORE INFORMATION

Allison Sibley | 817.713.9382 | [asibley@tigusa.com](mailto:asibley@tigusa.com)

