630 Third Avenue

MIDTOWN
NEW YORK, NY



NEWMARK

Property Details

Location

Southwest corner of East 41st Street

Approximate Size

Ground Floor 1,787 SF

Term

Long term

Frontage

30 FT on East 41st Street

Possession

Immediate

Site Status

Formerly P.F. Chang's To-Go

Neighbors

DIG, Shake Shack, Just Salad, Spear Physical Therapy, Pret A Manger, CVS pharmacy and Starbucks

Comments

New second generation restaurant space with black iron venting and gas in place

At the base of a 23-story 245,000 SF office tower

Steps from Grand Central Station

Ground Floor

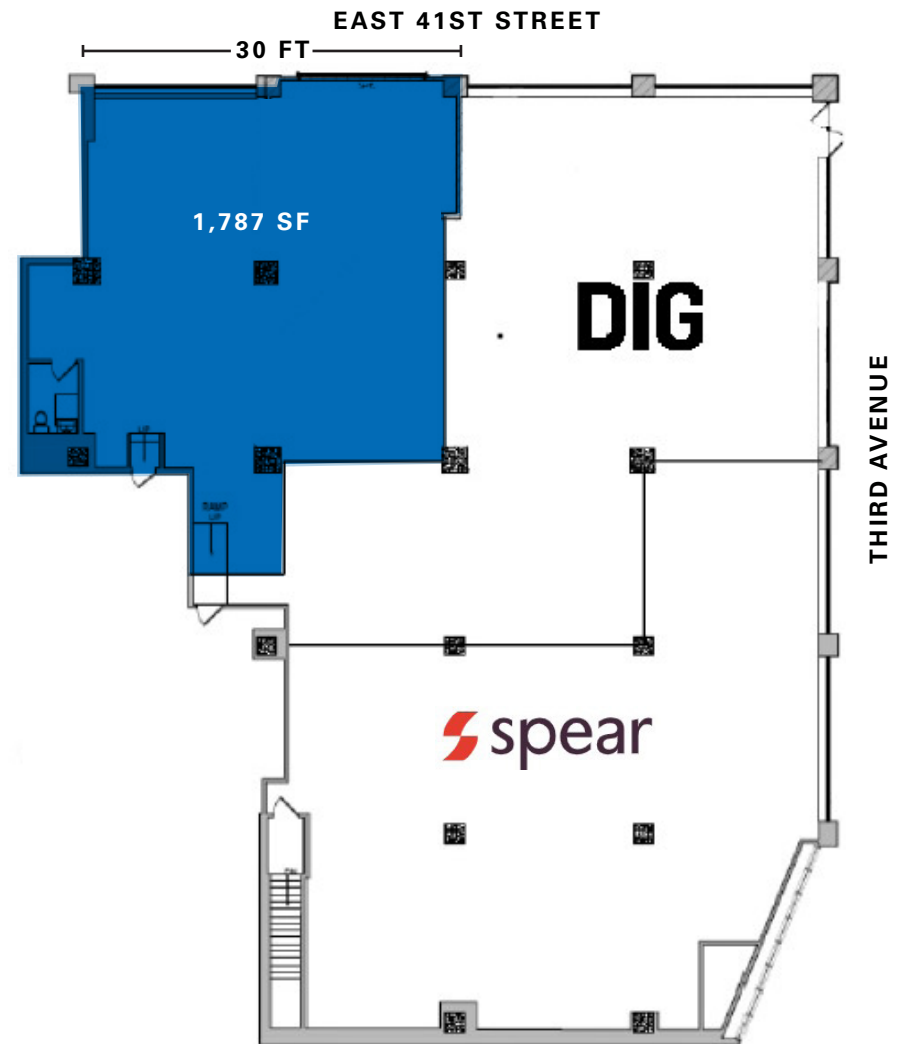

630 THIRD AVENUE

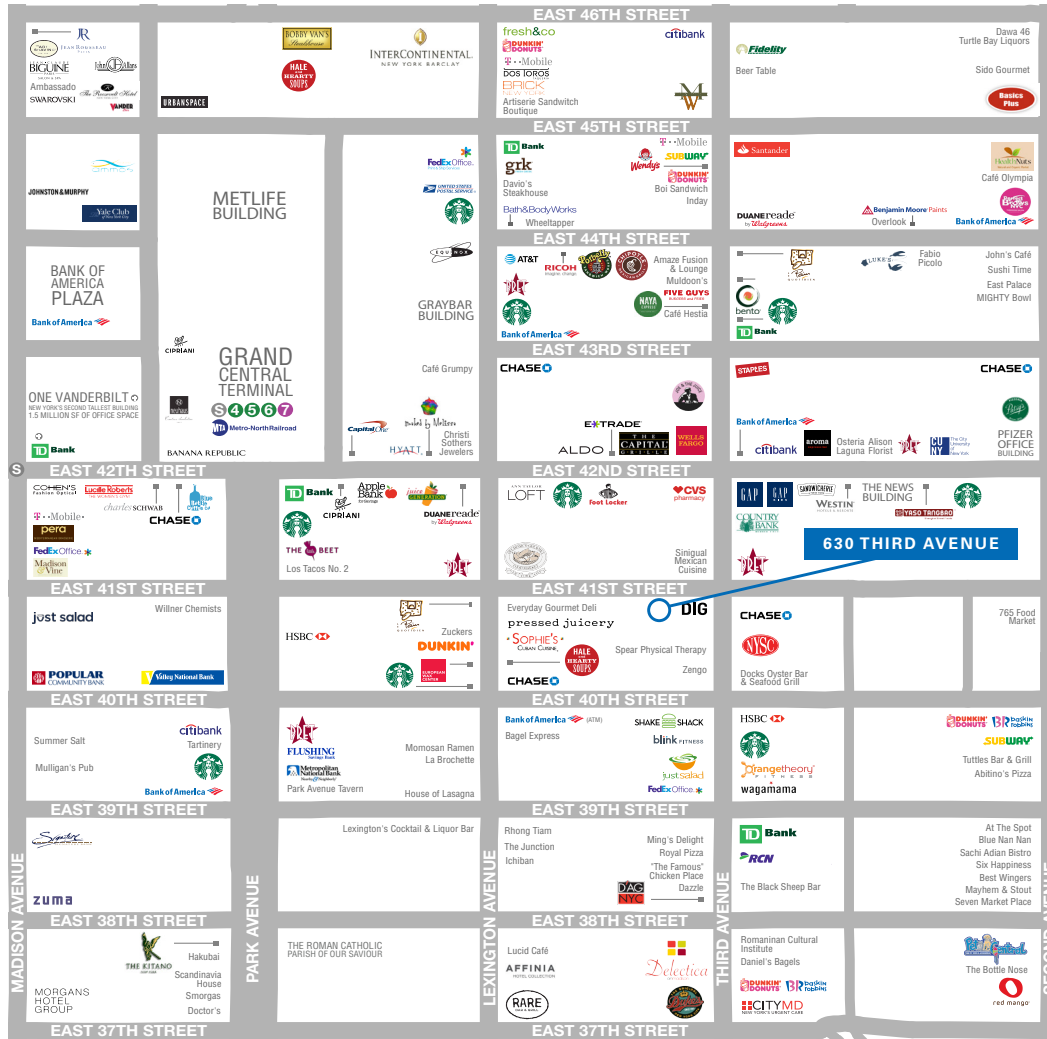

COMING SOON

Estimated Daytime Population

1/2 mile 313,000

Annual Subway Riders

Grand Central Terminal 50.1M
33rd Street 9.8M

Area Employees

1/2 mile 328,000

Annual Visitors

Grand Central Terminal 21.6M

Jeremy Ezra
t 212-351-9351
jeremy.ezra@nrmk.com

Michael Paster
t 212-351-9345
michael.paster@nrmk.com

Ariel Schuster
t 212-331-0132
ariel.schuster@nrmk.com